

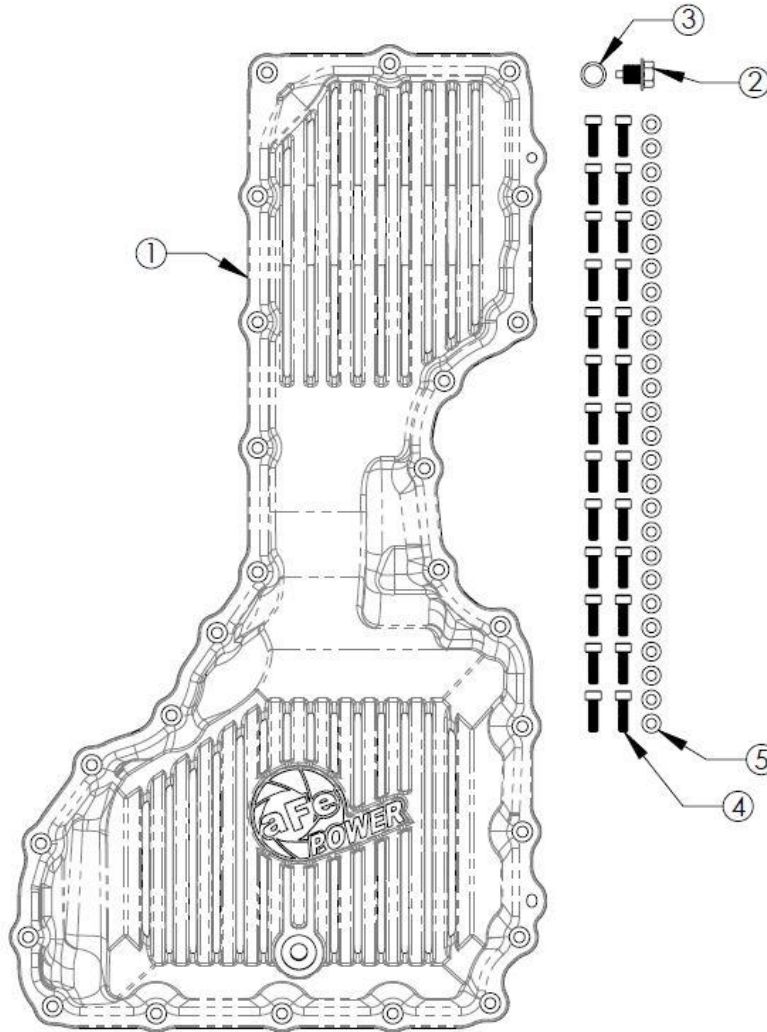

# INSTALLATION INSTRUCTIONS

**MAKE:** GM  
**MODEL:** L5P  
**YEAR:** 2017-2019  
**ENGINE:** V8-6.6L (td)

**Engine Oil Pan**  
 46-71360A/46-71360B



<i>Item</i>	<i>Description</i>	<i>Part Number</i>	<i>Quantity</i>
1	Oil Pan, Machined Fins, Raw	05-61466A	1
1	Oil Pan, Machined Fins, Black	05-61466B	1
2	Plug, M12 x 1.25	03-50385	1
3	Washer, Aluminum: M12,15.85MM OD	03-50384	1
4	Screw, Socket Head: M6 x 1.00 x 25, S/S	03-50556	26
5	Washer, Flat: M6	03-50177	26
6	RTV Silicone, Black Instant Gasket	05-60069	1

**aFe POWER recommends professional installation on this product.** Thoroughly inspect the aFe POWER exhaust system to make sure there is no damage from shipping (if damage is noted, immediately contact aFe POWER customer service). Allow time for your vehicle to cool down prior to installation. When working on your vehicle



## INSTALLATION INSTRUCTIONS

**MAKE:** GM  
**MODEL:** L5P  
**YEAR:** 2017-2019  
**ENGINE:** V8-6.6L (td)

**Engine Oil Pan**  
46-71360A/46-71360B

1. **(Read instructions prior to installation.)** Secure vehicle on jack stands (refer to your manual for specified jack stand positions).
2. Completely Drain Engine Oil.
3. Remove Front skid plate and crossmember.
4. Remove the bolts securing the front driveshaft to the front differential housing
5. Remove the bolts securing the front axle shafts to the differential housing.
6. Remove the front differential housing.
7. Remove the factory oil pan bolts.
8. Remove the lower passenger side bellhousing bolt.
9. Remove the OE oil pan from the engine. This will require quite a bit of prying to get the oil pan loose. There will be residual oil on the OE oil pan.
10. Clean the mating surface of any remaining silicone.
11. Clean the oil pickup tube.
12. Hold the aFe oil pan up to the gasket surface to make sure you will be able to maneuver it into place. We recommend lifting the passenger side of the pan into place first.
13. Once you have a clear path to lift the aFe oil pan into place, prepare all the required hardware to secure it into place. This includes the 26 supplied M6 socket head screws and M6 flat washers
14. Spread the supplied RTV silicone across the gasket surface. Be generous when spreading silicone across the surface and make sure that all the bolt holes are surrounded.

**Note: Be careful not to move the pan around once it touches the gasket surface.**

15. Hold the oil pan up into position, aligning the screw holes. Install four (4) M6 socket head screws and M6 flat washers into each of the corners to hold the pan into place.
16. Continue installing the remaining M6x1.0x20 socket head screws and M6 flat washers finger tight.
17. Torque the mounting screws to 8 ft. -lbs. in a crisscross pattern.
18. Install the supplied M12x1.25 magnetic drain plug and crush washer into the bottom drain hole.
19. Re-install the transmission bolt removed in step 8.
20. Install the front differential housing.
21. Install the bolts securing the front axle shafts to the differential housing.
22. Install Front Driveshaft.
23. Install Front skid plate and crossmember.
24. Refill the engine with new oil. Your aFe pan holds about 2 quarts more than stock (Fill to full line on dipstick).

**Note: The truck needs to be warmed up and oil has to have run through the oil filter in order to get an accurate reading on the dipstick.**

25. Check for leaks.
26. Congratulations, your aFe POWER Engine Oil pan is now installed.