



Part number PF8051
2009-12 Dodge Ram
5.7L V8 Hemi

- 1- MR Tech Power-flow Intake system
- 1- Power-Flow Box- (PB375D-8) Contents:
 - 1- 8" Inverted top filter (#1022)
 - 1- Main body, top and screen (#15015)
 - 1- 3.75" velocity stack inlet (#15017)
 - 1- Rect. front pre-filter screen (#15018)
 - 4- m6 x 20mm button head bolts (#6073)
- 1- Lower Powerbox bracket (#20108)**
- 1- Upper Powerbox bracket (#20109)**
- 1- M6 x 20mm button head bolts (#6073)
- 1- 3 1/2" x 3 3/4" step hose (#3133)
- 1- 3 1/2" straight hose (#3037)
- 1- Power-Band .064 .462 (#4006)
- 3- Power-Band .056 .412 (#4005)
- 1- Temp sensor grommet (#8026)
- 1- Bracket grommet (#8002)
- 1- 9"-17mm Vac. hose (#3080)
- 1- 7 page instruction

Note: All parts and accessories are sold

on-line a **"injenonline.com"**

Note: The C.A.R.B. Exempt sticker must be attached under the hood in a manner such that it is easily viewed by an emissions inspector.



Tools required:

- 1- 8mm nut driver
- 1- 8mm socket
- 1- 10mm socket
- 1- 13mm socket
- 1- ratchet
- 1- ratchet extension
- 1- set of allen wrenches

Congratulations! You have just purchased the best engineered, dyno-proven air intake system available.

Please check the contents of this box immediately.

Report any defective or missing parts to the Authorized Injen Technology dealer you purchased this product from. Before installing any parts of this system, please read the instructions thoroughly. If you have any questions regarding installation please contact the dealer you purchased this product from. Installation DOES require some mechanical skills. A qualified mechanic is always recommended.

*Do not attempt to install the intake system while the engine is hot. The installation may require removal of radiator fluid line that may be hot.

Injen Technology offers a limited lifetime warranty to the original purchaser against defects in materials and workmanship. Warranty claims must be handled through the dealer from which the item was purchased.

Injen Technology 244 Pioneer Place Pomona, CA 91768 USA

Please check the contents of this box immediately.

Note: This intake system was Dyno-tested with an Injen filter and Injen parts the use of any other filter or part will void the warranty and CARB exemption number.

Parts and accessories are available on line at "Injenonline.com"

Note: The installation of this cold air intake does require mechanical skills. Removal of the front bumper requires loosening and removing several plastic plugs and screws that may be difficult. It is recommended that this system be installed by a professional mechanic. Be sure to disconnect the negative terminal before proceeding.

Congratulations! You have just purchased the worlds first tuned intake system.

MR Technology, Leading the way!

POWER-FLOW: Air intake evolution

Power-Box contents: See cleaning and maintenance instructions on last page.



Figure 1



Figure 2



Figure 3
Stock engine compartment and factory air box.



Figure 4 (A) Stock air temp sensor on factory air duct.
Figure (B) Unclip harness from from air temp sensor.



Figure 5 (A) Air temp sensor with harness removed
Figure (B) Firmly pull air temp sensor out of factory air duct. This sensor will be re-used later.

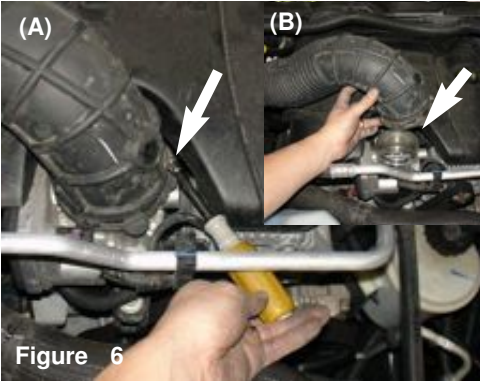

Figure 6 (A) Use a 8mm nut driver and loosen clamp on air duct connected to throttlebody.
Figure (B) Pull air duct off of throttlebody



Figure 7 Disconnect the crank case ventilation tube from the factory air box cleaner.



Figure 8 Lift factory air box cleaner and pull entire air box and air duct assembly out of engine bay.



Figure 8 (A) Loosen the bolt holding in the air box plastic bracket closes to the headlight.
(B) Remove the bolt and save for the bracket install.

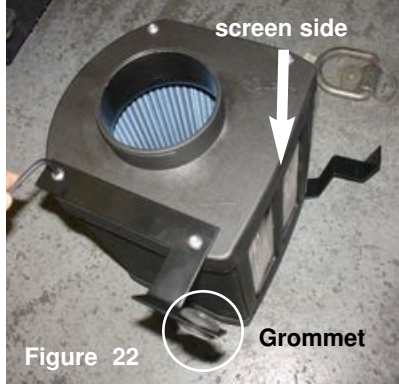

Figure 22 Install the bracket p/n:x-20109 to the power-flow box. Make sure its install to the back side of the power flow box. Install grommet to the bracket hole.

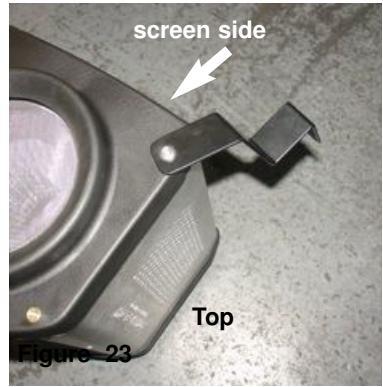

Figure 23 Now install the bracket p/n:20108 to the front of the powerflow box.

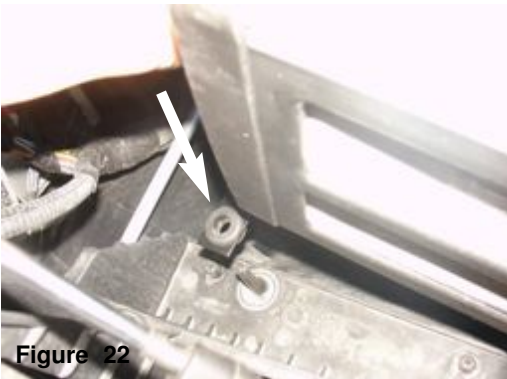

Figure 22 Lower the entire air box assembly into the engine bay and place the grommet on bracket to the factory air box stud.



Figure 23 Position the bracket to the hole from step 8. Secure the bracket using factory screw.



Figure 24 Loosen the bolt on the powerflow box and tighten to re-position if necessary.



Figure 25

Install the 3-1/2" step hose with clamps provided to the throttle body.

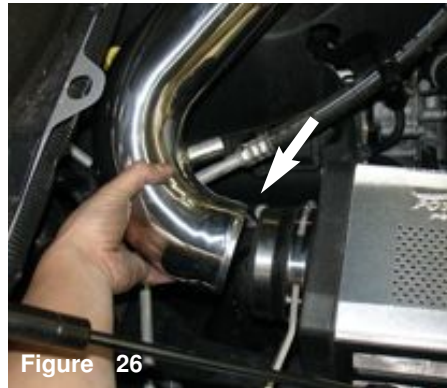

Figure 26

Attach the step hose with clamps to the powerflow box. Now install the intake tube to the vehicle and position.



Figure 27

Insert the intake tube into throttle body hose. Do not tighten at this point.



Figure 28

Position Intake tube to proper fit and tighten clamp on power flow box using 8mm nut driver.



Figure 29

Tighten clamps on throttle body using 8mm nut driver.



Figure 30

Install provided grommet to the 3/4" hole on intake tube.



Figure 31

Insert the temperature sensor into grommet.



Figure 32

Re-connect electrical temperature sensor harness.



Figure 33

Install provided 17mm crank case line to crank case hard line.



Figure 34

Press the hose over the Intake vacuum port.



Figure 37

Check the entire air intake system for best possible fit, once proper clearance has been made through out the length of the intake, continue to tighten all nuts, bolts and clamps.



Figure 38

Congratulations! You have just completed the installation of the World's first tuned intake system, the Power-Flow intake, featuring MR Technology. Periodically, check the system for fitment, this will enhance the life of your Power-Flow system, failure to do so will void the warranty.

Assembly and disassembly instructions for the Power Box for cleaning screens and air filter.



Here are the four-m6 x 20mm bolts that will be removed from the velocity stack base located on the corners of the base.



Unbolt the four- m6 x 20mm screws from the velocity stack base located to the center of the base. Now separate the base from the velocity stack.



The four m6 x m20 bolts have been removed from the top of the velocity stack,



Pull the velocity stack base with the filter that is attached to the velocity stack.



The velocity stack with filter is now out of the power box body.



Once you have loosened the filter neck clamp, continue to pull the filter from the velocity stack,

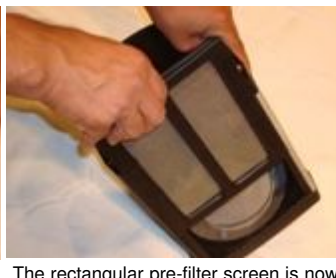

The rectangular pre-filter screen is now slipped out of the channel along the body of the power box.



Here is a group shot of the components that goes into the power-box. The filter and screens can now be cleaned with a simple shop-vac.

1. Upon completion of the installation, reconnect the negative battery terminal before you start the engine.
2. Align the entire intake system for the best possible fit. Once the intake has been properly fitted continue to tighten all nuts, bolts and clamps.
3. Periodically, recheck the alignment of the intake system and make sure there is proper clearance around and along the length of the intake. Failure to follow proper maintenance procedures may cause damage to the intake and will void the warranty.
4. Start the engine and listen carefully for any odd noises, rattles and/or air leaks prior to taking it for a test drive. If any problems arise go back and check the vacuum lines, hoses and clamps that maybe causing leaks or rattles and correct the problem.
5. Check the filter for excessive dirt build up. Clean or replace the filter with an original Injen filter (can be bought on-line at "injenonline.com"). Congratulations! You have just completed the installation of the best intake system sold on the market. Enjoy the added power and performance of your new intake system.