

**RAM 1500 09-18  
OE Style  
(metal bumper only)**

**FEATURE**

High quality injection molding fender flares

Made from light weight impact resistance Polypropylene, non-cracking, non-warping, 100% UV-resistant.

Professional installation is always recommended

**Step 1 Before Installation**

**A.Fit:** Fit of the flare to vehicle should be confirmed. Some filing, sanding, or cutting may be adopted for proper fit if necessary.

**B.Painting:** (optional) if paint is desired it must be done prior of installing flares on vehicle. Clean outer surface with a good grade degreaser.

**C.Metal protection:** Rust resistance paint of all exposed fasteners and bare metal should be done BEFORE installing flares. Undercoating the inner fender wells should be done AFTER flare attachments have been completed.

**D.Flares** may interfere with existing decals on vehicle. If you wish. Remove decals prior to installation of flares.

**TOOLS FOR EASY INSTALLATION**

- Utility Knife
- Electric Drill
- 1/4" Drill Bit
- #2 Phillips Driver
- 1/2" Wrench
- Socket Wrench
- 7/32" Socket
- 10 mm Socket
- Grease Pencil

**Included in Hardware Kit:**

1.



CL1-0022,  
#10 "U" Clip,

10 pcs

2.



MT1-0002,  
1" x1" x.017"  
Black Tab,

6 pcs

3.



SW1-0056,  
#8 x 3/4"  
PH Screw,

30 pcs

## Front Flare Installation Procedures (Driver's Side):



Determine which bumper your vehicle has, metal or plastic. Please notice this fender flare apply to metal bumper only.

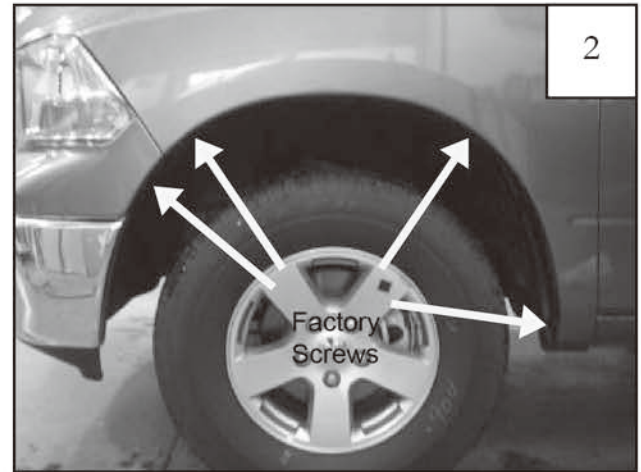

Remove four factory installed screws with 8mm socket wrench.

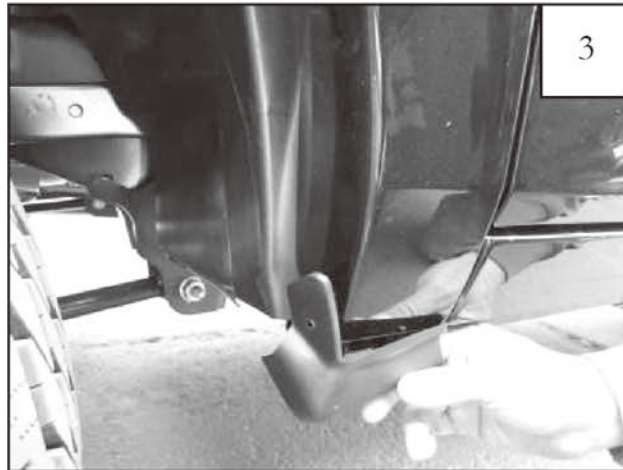

**2011-Up Models Only (Optional):** If you encounter a fit problem, remove inner pieces at front and rear of wheel well.



Two Clip locations. See step 6. **NOTE:** There are two factory holes near the rearward arrow. The correct hole for install is the one more toward the front of the vehicle.



Install two tabs (MT1-0002) over factory holes. *There are two factory holes near the rearward arrow. The correct hole for install is the one more toward the front of the vehicle.*



Install #10 U-Clip (CL1-0022) over tabs and existing factory holes. See step 4.



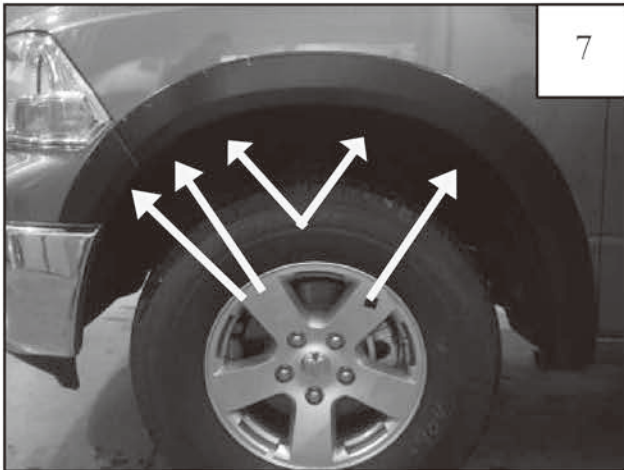

Supplied screws locations.

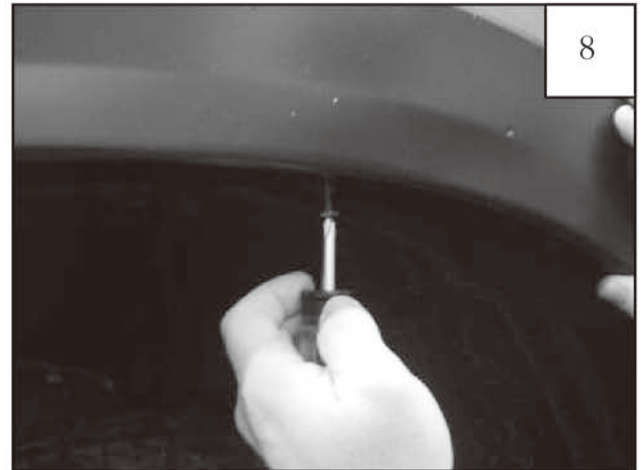

Hold flare to vehicle and start the supplied #8x3/4" Washer Panhead Screws with a Phillips screwdriver. *Do not tighten.*



Slide factory screw through hole in flare, and start factory screw with an 8 mm socket wrench. *Do not tighten*



**METAL BUMPER ONLY:** Press firmly on flare and tighten all screws.



**METAL BUMPER ONLY:** Completed front flare installation.

# Rear Flare Installation Procedures (Driver's Side):

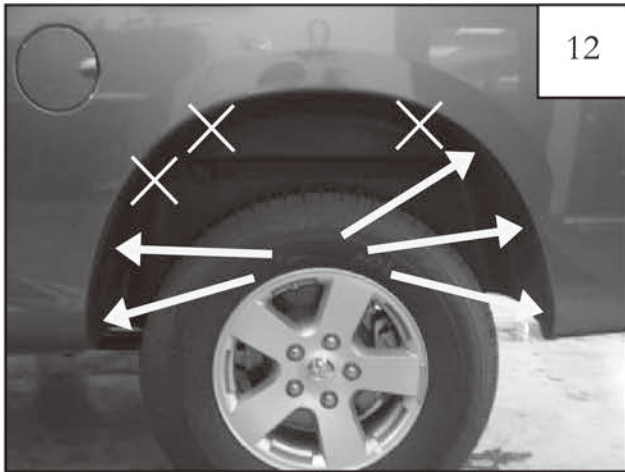

Remove these five factory installed screws using an 8mm socket wrench.



**2013-Up Models Only** : You will need to remove the plastic factory wheel well piece from the rear of the wheel well. Please follow steps 21 - 22.

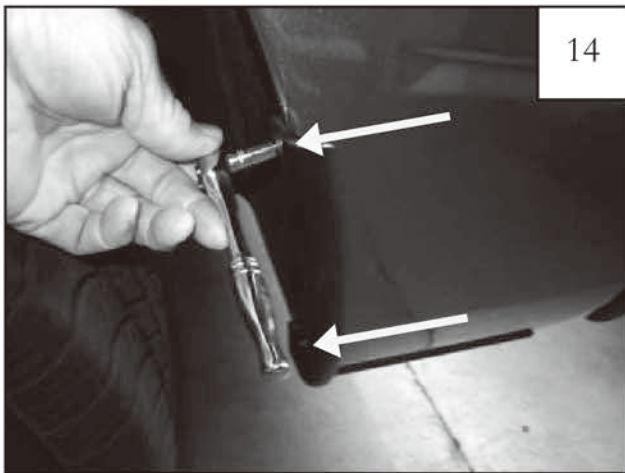

Using a socket and wrench remove the two factory screws from the plastic wheel well piece.



Using a screwdriver remove the two factory fasteners from the bottom side of the plastic wheel well piece. Remove plastic wheel well piece at this time.

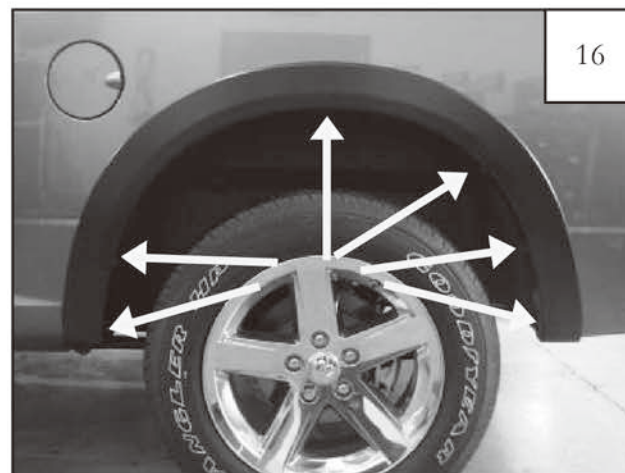

Press firmly on flare and tighten all screws.



Completed rear flare installation.