



TCX HD DROP STEPS

2009-2018 RAM 1500 CREW CAB

2010-2024 RAM 2500/3500 CREW CAB

(Include 2019-2023 RAM 1500 Classic Crew Cab)

INSTALLATION INSTRUCTIONS

CONTENTS

- (1) LH Drop Step
- (1) RH Drop Step
- (3) LH Step Brackets [DF, DC, DR]
- (3) LH Reinforcement Brackets [DF, DC, DR]
- (3) RH Step Brackets [PF, PC, PR]
- (3) RH Reinforcement Brackets [PF, PC, PR]
- (6) M8 Bolt Plates
- (6) M8 Plastic Retainer
- (12) M8 x 30mm Hex Bolts
- (18) M8 x 24mm OD x 2mm Flat Washers
- (6) M8 Lock Washers
- (6) M8 Hex Nuts
- (6) M8 Nylon Lock Nuts
- (12) M8 x 25mm Combo Bolts
- (12) M6 x 25mm Hex Bolts
- (24) M6 x 22mm OD x 2mm Flat Washers
- (12) M6 Nylon Lock Nuts

TOOLS REQUIRED

10mm Wrench/Socket
13mm Wrench/Socket
Ratchet

SKU # R174170

Edited:08/13/2024

STEP 1

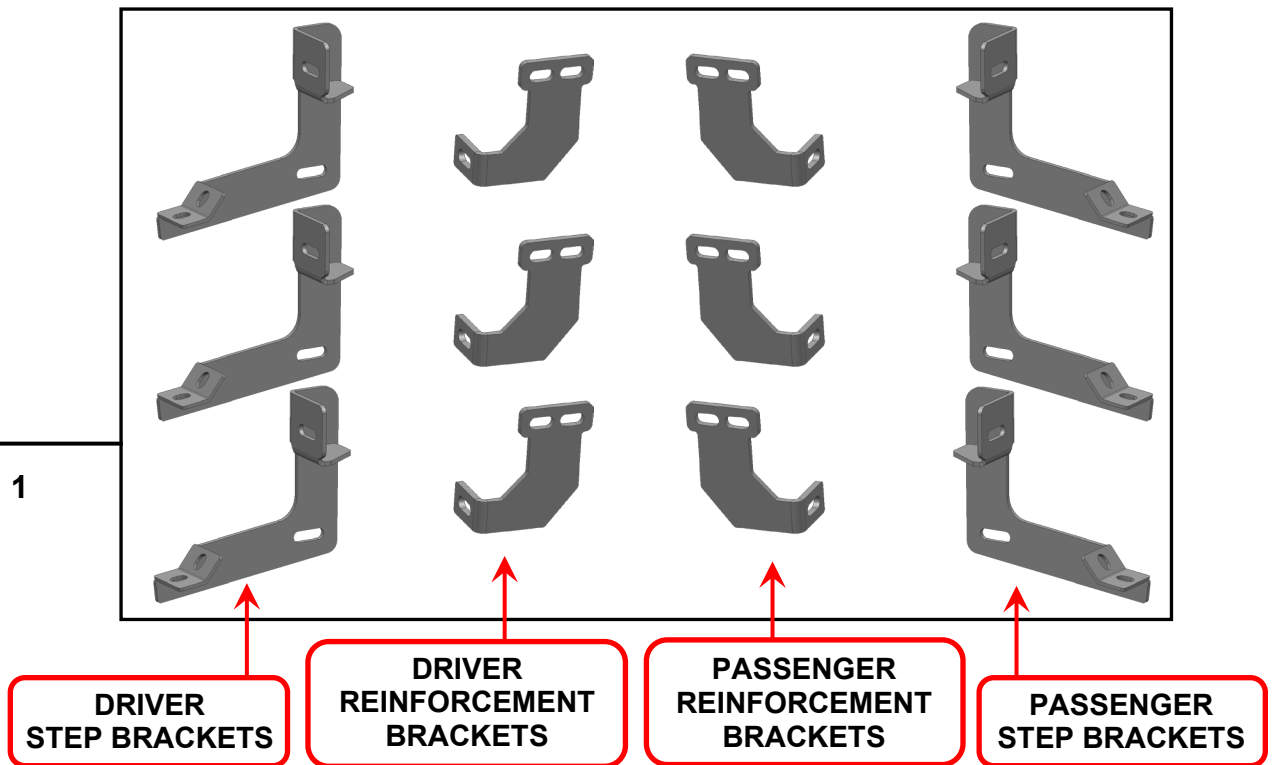

Please identify each mounting bracket using the engraved location identifier. **Notice: The step brackets & reinforcement brackets per side are the same.**

DF: Driver Front
DC: Driver Center
DR: Driver Rear

PF: Passenger Front
PC: Passenger Center
PR: Passenger Rear

STEP 2

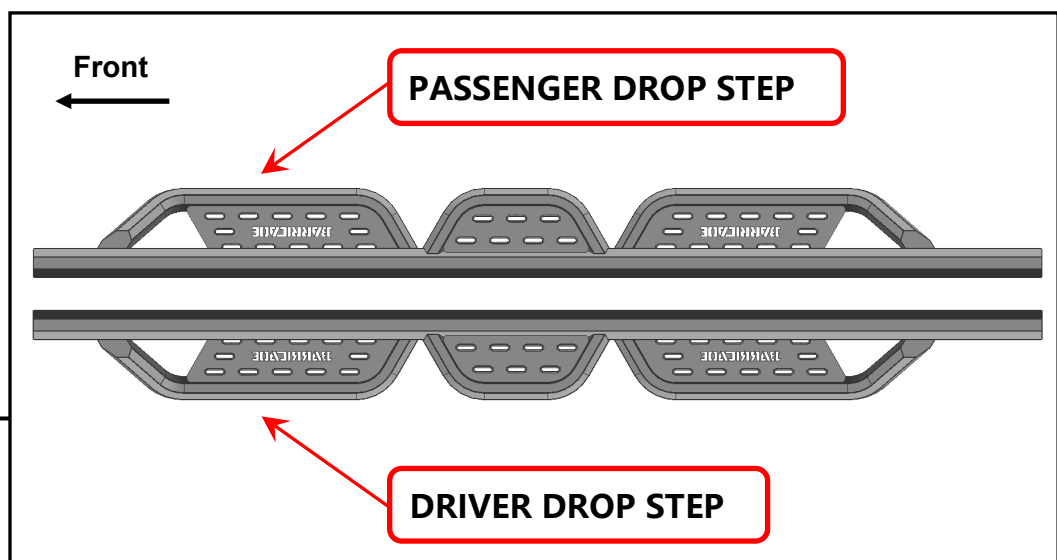

Identify each drop step by identifier on the front. **Notice: “D” for Driver/Left Side; “P” for Passenger/Right Side.**

Determine if the vehicle have factory threaded inserts or not in the body panel.

Vehicles without factory threaded inserts in body panel follow **Step 3.1:**

Vehicles with factory threaded inserts in body panel follow **Step 3.2:**

STEP 3.1.1

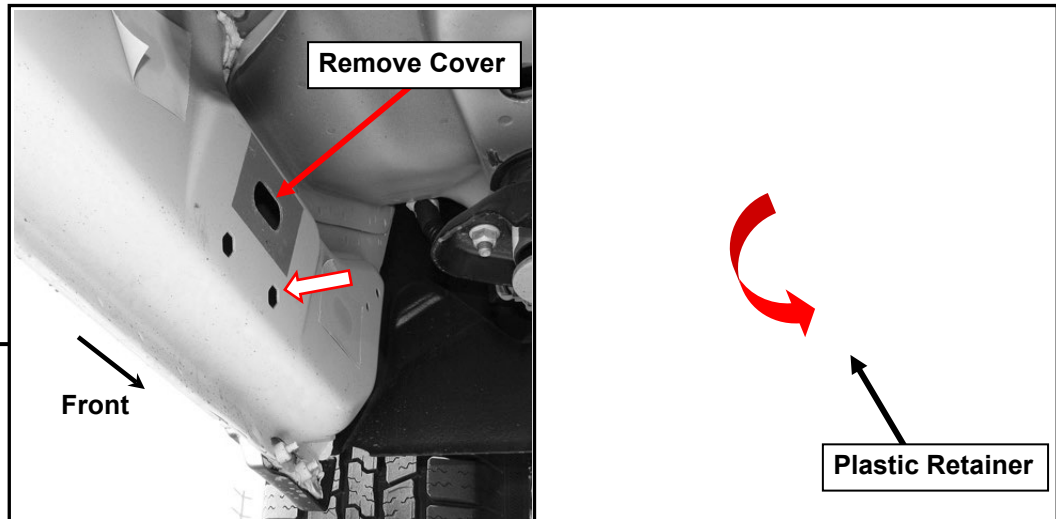

Start installation toward the front of the Driver/Left side of the vehicle.

Select (1) 8mm Bolt Plate. Insert the threads of the Bolt Plate into the large hole and out the Front hex shaped hole in the rocker panel.

STEP 3.1.2

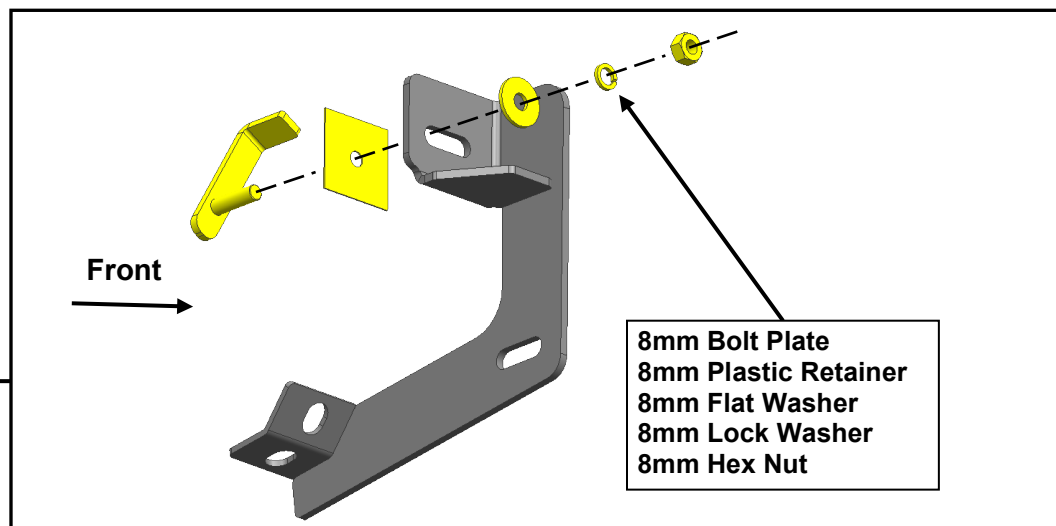

Thread (1) 8mm Plastic Retainer onto the threaded end and down tight against the body panel.
NOTE: The Plastic Retainer is designed to keep the Bolt Plate from falling into the body panel and to aid in Bracket installation.

Select (1) Driver/Left Mounting Bracket. Attach the Bracket to the threads on the Bolt Plate with (1) 8mm Flat Washer, (1) 8mm Lock Washer and (1) 8mm Hex Nut, Do not tighten hardware.

Repeat this step for all Driver step brackets.

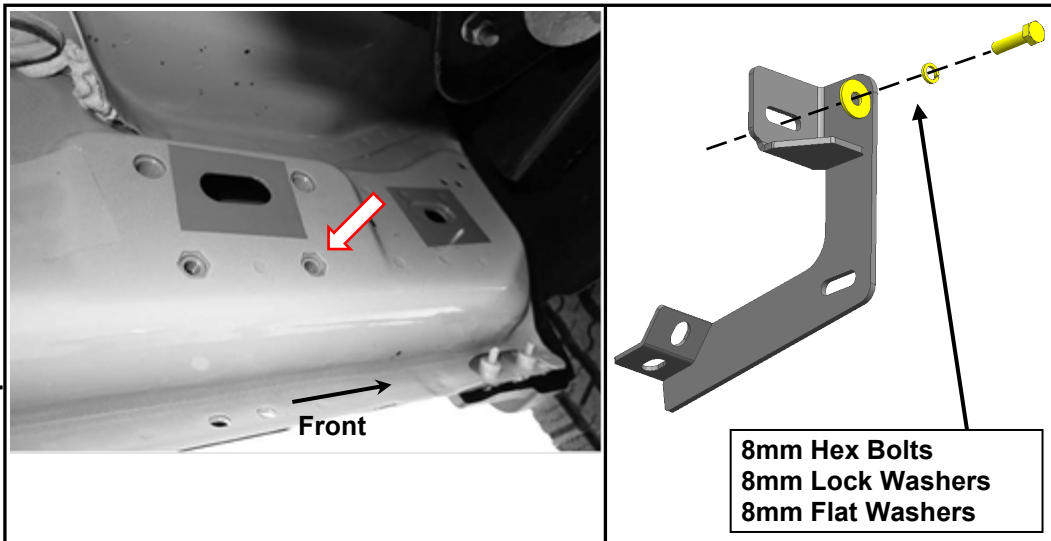
STEP 3.2

Start installation toward the front of the Driver/Left side of the vehicle.

Loosely fit the (1) Driver Front step bracket to the Front threaded hole using (1) M8 x 30mm hex bolts, (1) M8 lock washers, and (1) M8 x 24mm flat washers. Do not fully tighten to allow for later adjustments. Repeat this step for all Driver step brackets.

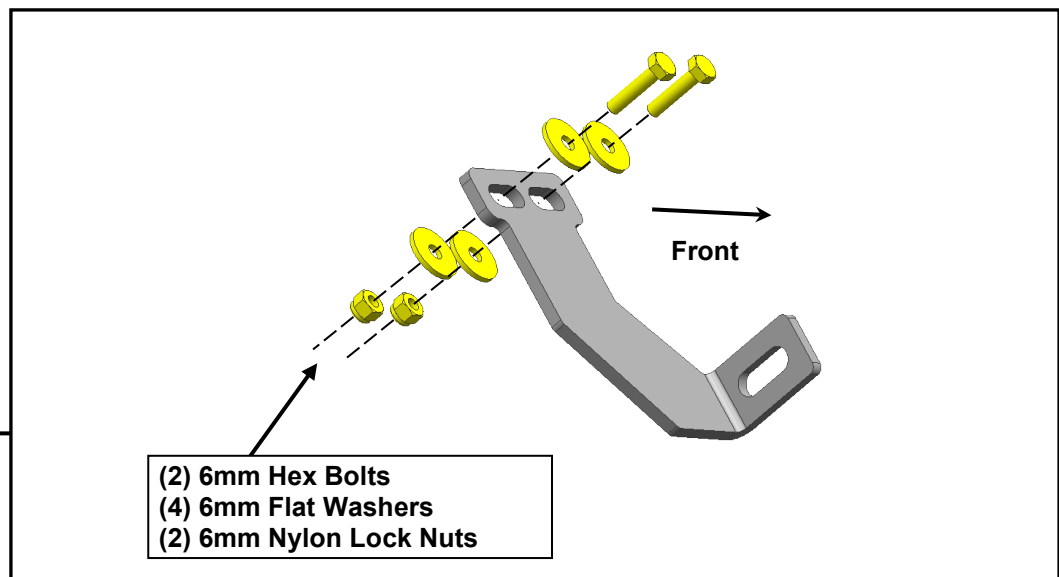
STEP 4

Loosely connect the (1) Driver Front reinforcement bracket to the back of the pinch weld using (2) M6 x 25mm hex bolts, (4) M6 x 22mm flat washers, and (2) M6 nylon lock nuts.

Repeat this step for all Driver reinforcement brackets.

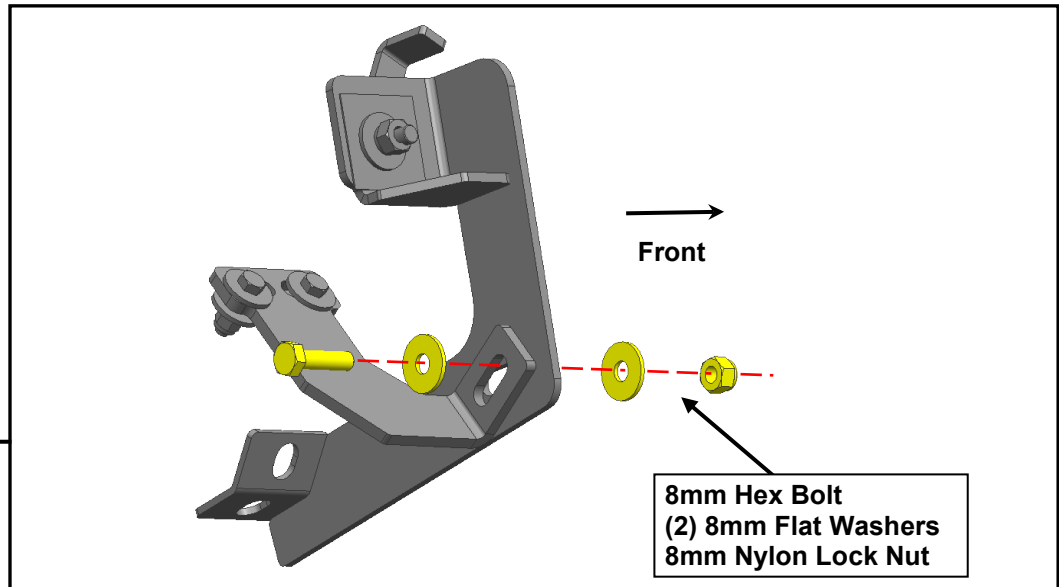
STEP 5

Loosely connect the (1) Driver Front step bracket to the (1) Driver Front reinforcement bracket using (1) M8 × 25mm hex bolt, (2) M8 × 24mm flat washers, and (1) M8 nylon lock nut.

Repeat this step for all Driver step brackets.

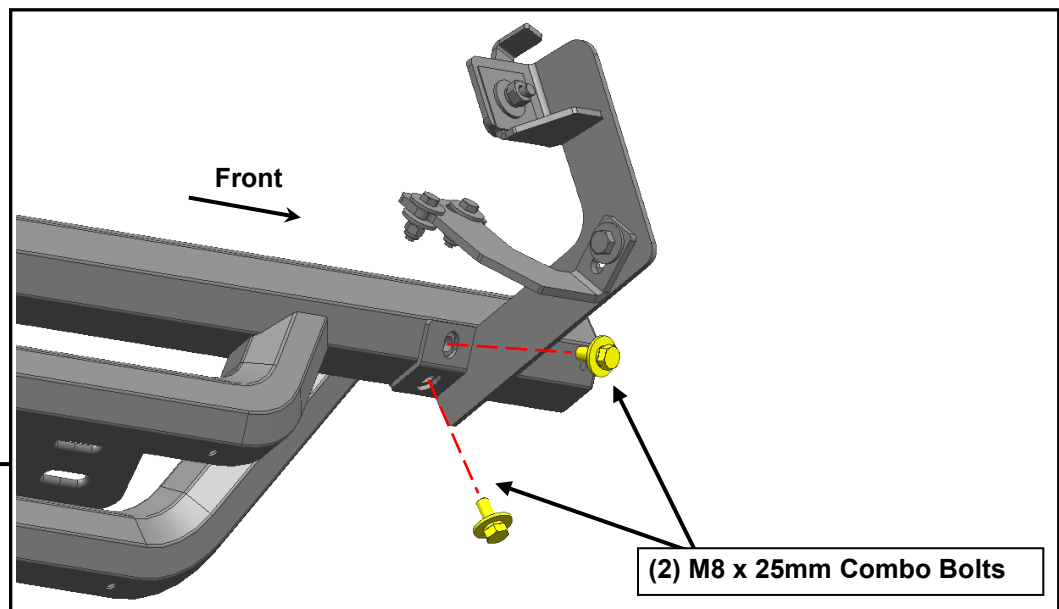
STEP 6

With all brackets loosely mounted to the vehicle, fit the Driver/Left Drop Step onto the brackets, and loosely secure into place using (6) M8 x 25mm combo bolts.

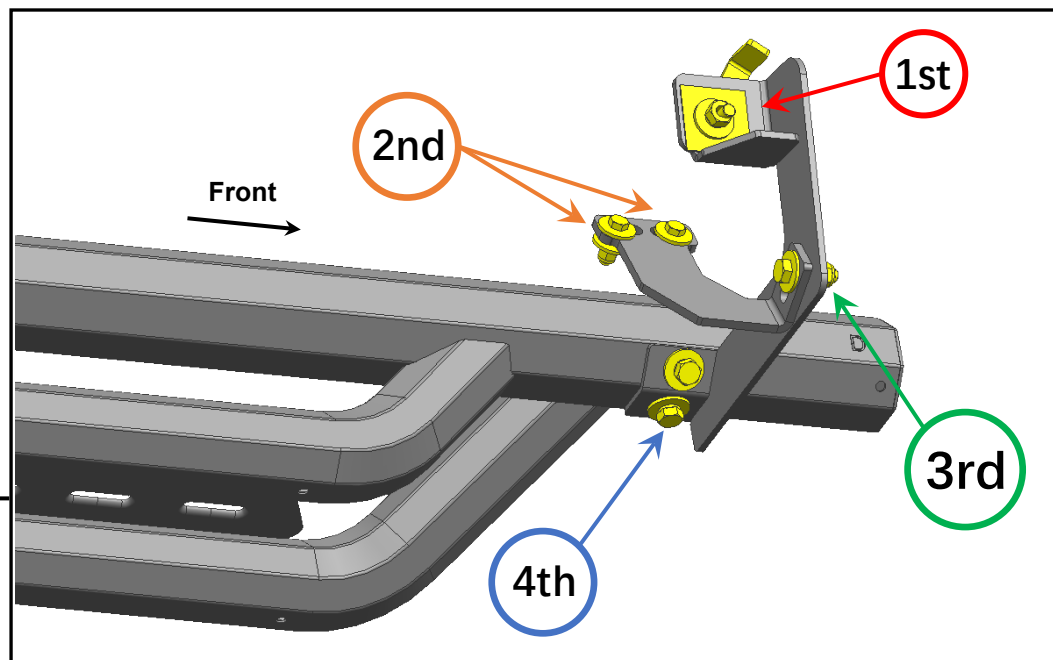
STEP 7

Tighten the mounting brackets to the vehicle. Adjust the Drop Step to the desired angle, and tighten the M8 combo bolts to secure the step into place. See photo for tightening order visual.

Repeat steps 1-7 for the remaining Drop Step.

Installation is now complete.