

**LD2 FRONT BUMPER PARKING SENSOR INSTALL KIT  
2019-20 CHEVY SILVERADO 1500 (INCLUDES DIESEL, EXCLUDES "LD")**

**PARTS LIST:**

2	Small Outer Mesh Plate	2	Wiring Harness Extensions
2	Small Inner Mesh Plate	1	Sensor Cover Kit
4	Plastic Sensor Sleeve	8	6-1.00mm x 20mm Combo Bolt
4	Sensor Sleeve Hex Nut	8	6mm Flange Nut
4	20mm x 10mm Foam Spacer	8	4mm Flat Head Self Tapping Screws
4	Retaining Caps	1	4mm Wrench

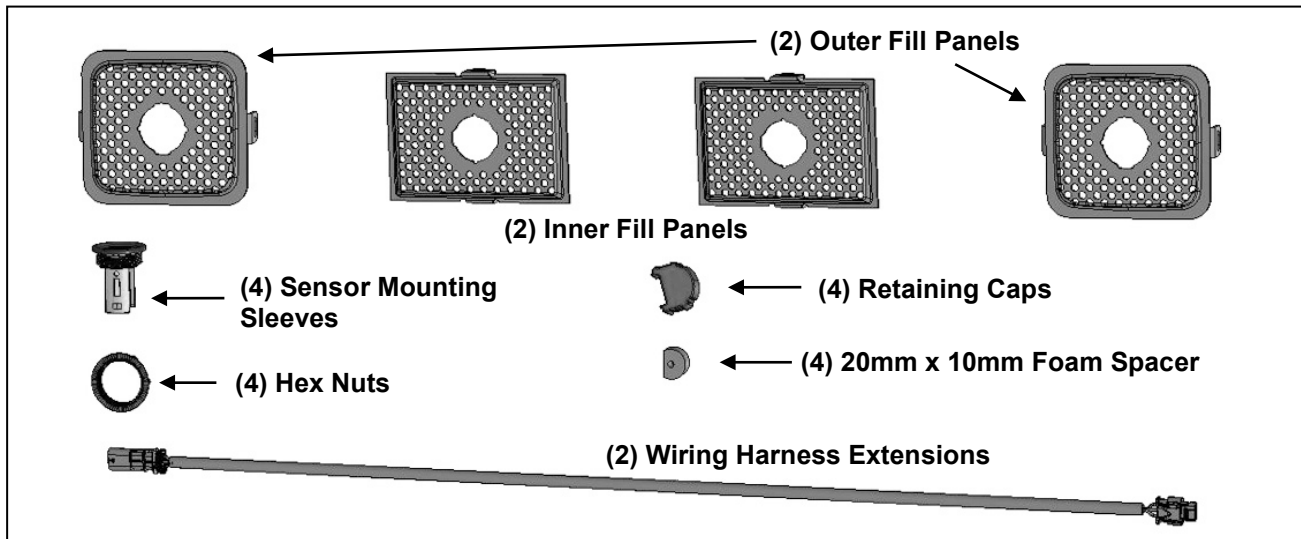

**PROCEDURE:**

**REMOVE CONTENTS FROM BOX. VERIFY ALL PARTS ARE PRESENT. READ INSTRUCTIONS CAREFULLY BEFORE STARTING INSTALLATION.**

1. Remove the wiring harness and sensors from the factory bumper, **(Figure 1)**. Pay close attention to location of sensors in bumper.
2. From the back of the LD2 front bumper, remove the passenger/right small outer mesh panel attached to the back of the Bumper if installed.
3. Select (1) Outer Mesh Panel for Sensor. From the front of the Panel, insert (1) Sensor Sleeve into and through the hole in the Panel, **(Figure 2)**. Secure the Sleeve to the Panel with the included Large Hex Nut. Rotate the slot in the Sleeve to match the factory bumper, (sensor will be horizontal). Tighten Hex Nut.
4. Select the passenger/right outer sensor. Push the sensor into the back of the Sleeve, **(Figure 3)**. Push (1) Foam Spacer onto the back of the sensor. Snap (1) Sensor Retaining Cap onto the Sensor Sleeve, **(Figure 3)**.
5. Attach the outer mesh Panel with Sensor to the bumper with the included (2) 6mm Combo Bolts and (2) 6mm Flange Nuts, **(Figures 4 & 5)**.
6. Repeat the previous Steps to install the remaining sensors in the (2) inner Mesh Panels and driver/left Outer Mesh Panel.
7. Install the factory wiring harness for sensors as equipped. Run wiring harness over or through Bumper Brackets to reach sensors, **(Figure 5)**. **NOTE:** (2) Wire Harness Extensions have been included to extend the factory harness to reach the outer sensors as needed. Plug harness into main wiring harness on the vehicle.
8. Do periodic inspections to the installation to make sure that all hardware is secure and tight.

**To protect your investment,** Do not use any type of polish or wax that may contain abrasives that could damage the finish. Mild soap may be used to clean the Front Bumper assembly.

**LD2 FRONT BUMPER PARKING SENSOR INSTALL KIT  
2019-20 CHEVY SILVERADO 1500 (INCLUDES DIESEL, EXCLUDES "LD")**

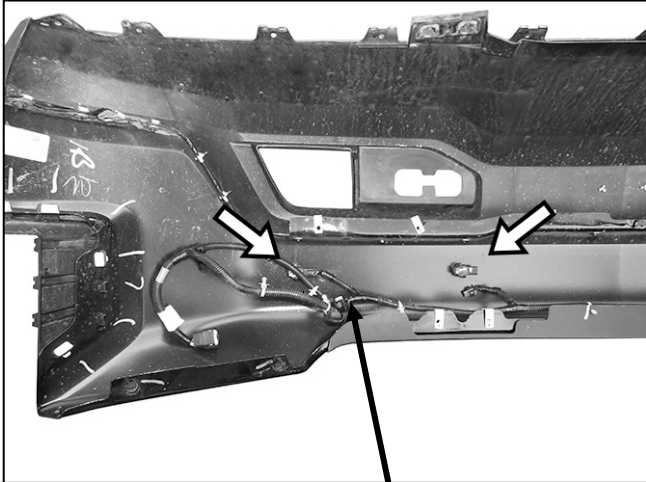

**(Fig 1) Disassemble factory bumper to remove sensors (arrows) and wiring harness.**

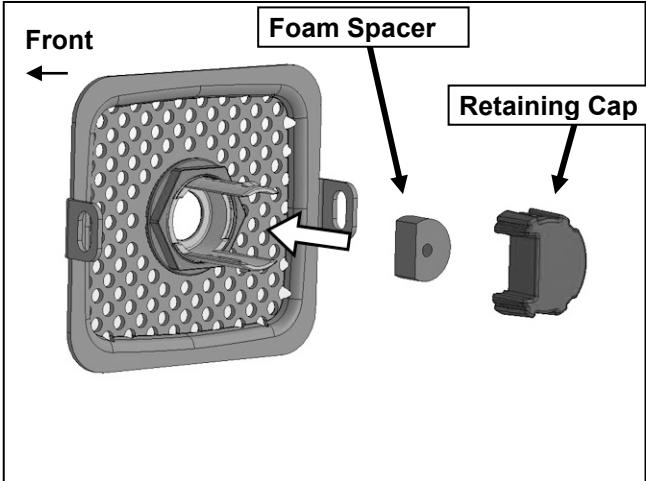

**(Fig 3) Insert sensor into Sleeve (arrow). Slide Foam Spacer onto sensor and snap Retaining Cap onto end of Sleeve**

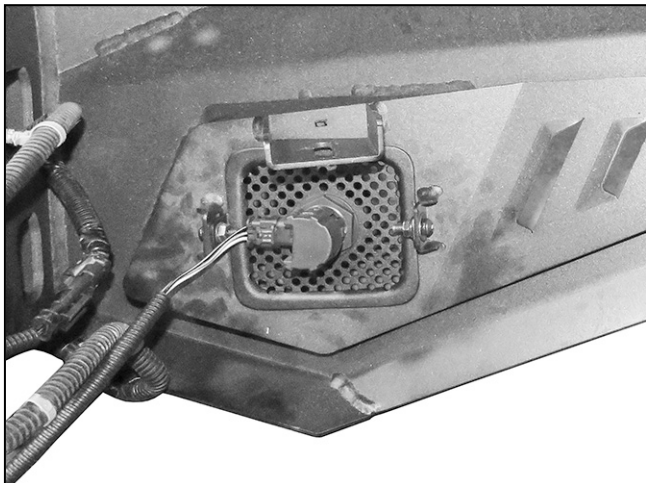

**(Fig 5) Outer Fill Panel with sensor installed**

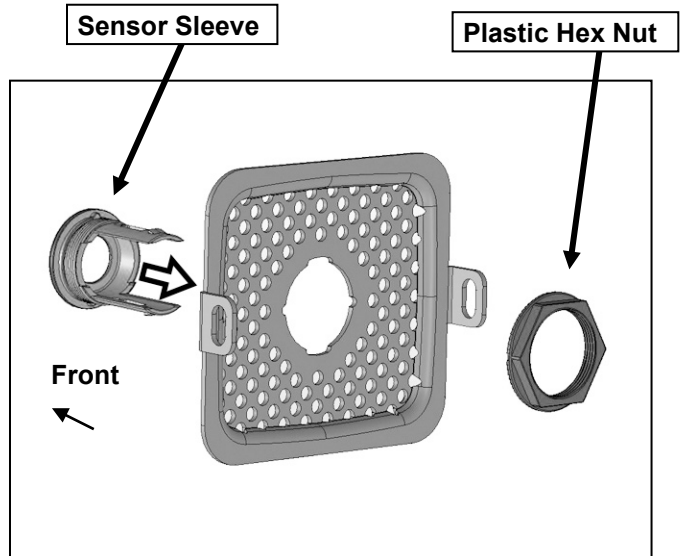

**(Fig 2) Insert Sensor Sleeve into and through Fill Panel. Secure Sleeve to panel with Hex Nut**

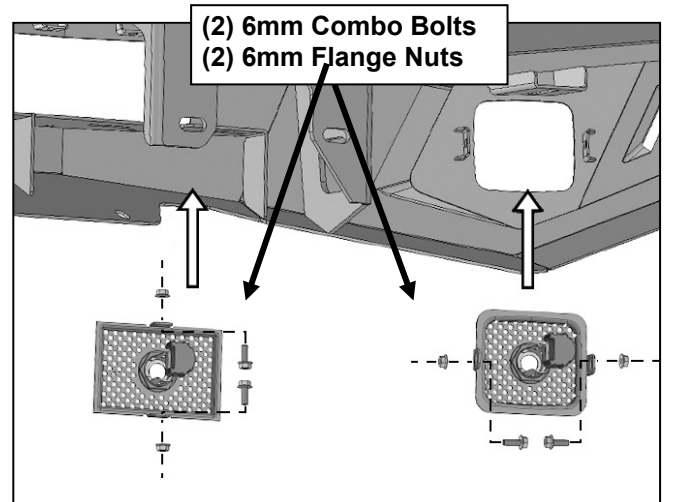

**(Fig 4) Attach Fill Panels with sensors to Bumper. Use included Wire Harness Extensions to reach outer sensors as needed (passenger/right side illustrated)**