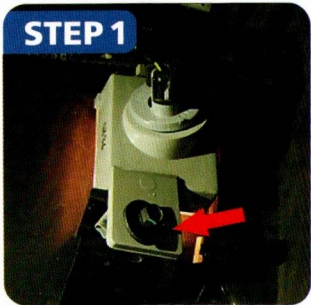

PLATE LIGHT INSTALLATION GUIDE

STEP 1



In order to remove the OEM license plate light from the vehicle, locate this screw that holds the housing from under the bumper

STEP 2

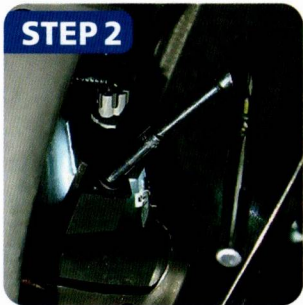

Use a 7mm socket wrench to remove the screw. The housing can now be removed.

STEP 3



Unplug the old OEM plug and plug in the new LED housing plug into the factory bulb socket.

STEP 4



Install the new LED License Plate light back onto the vehicle. Don't forget to install the 7mm screw back into the housing.