

TRUKID

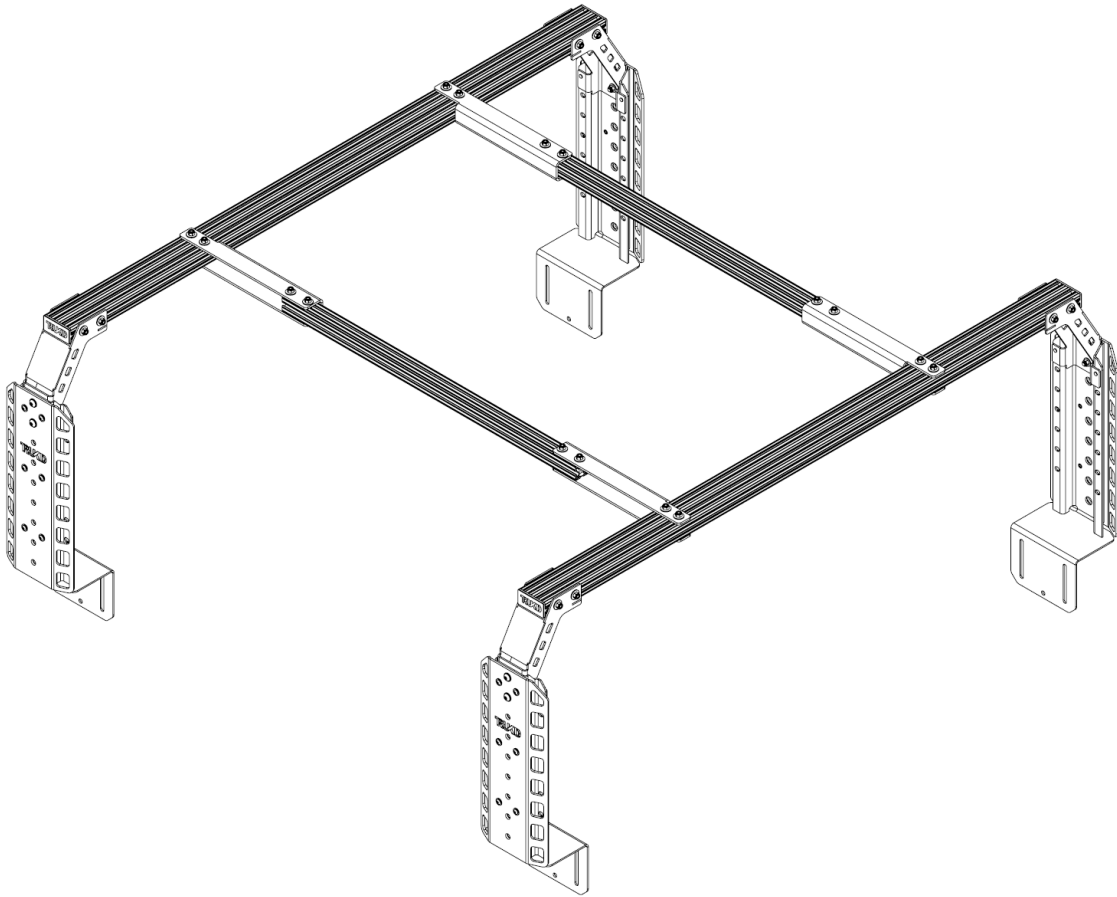

INSTALLATION GUIDE FOR 24.5" BED RACKS



Scan the QR Code for the online installation guide video!

PRODUCT CONTENTS

Make sure your received everything in the correct quantities for installation:

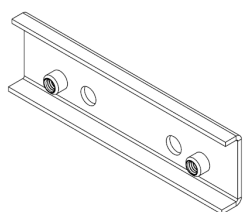
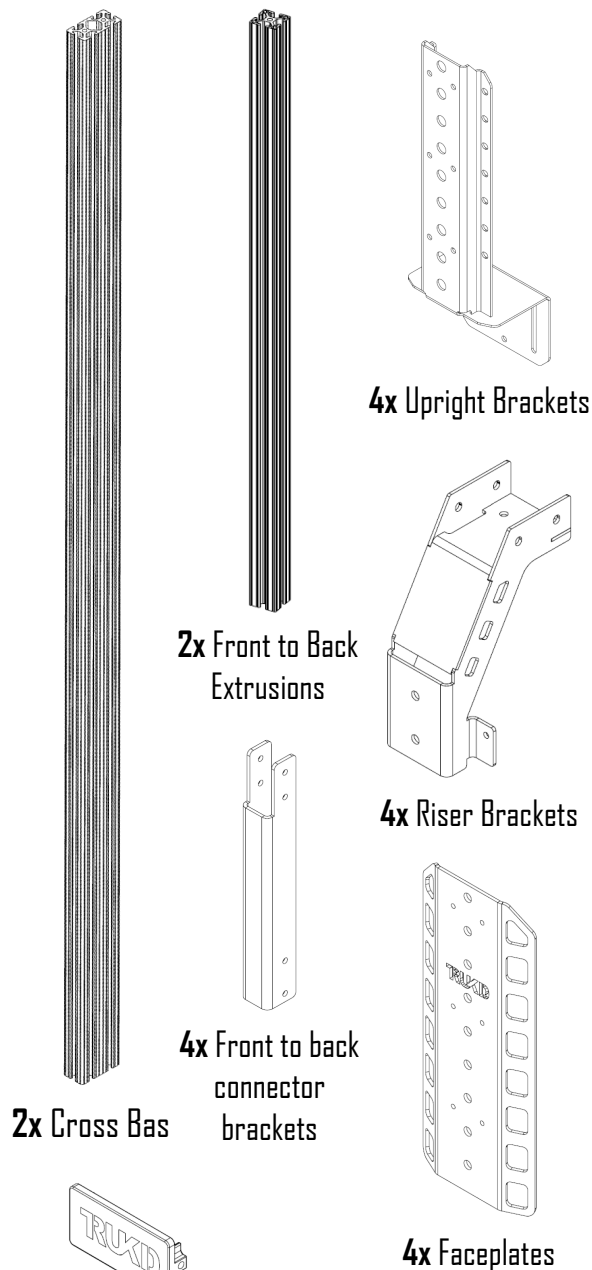

Bag 1 - Bolts

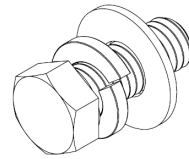

8x 3/8-16 Bolts with washers & lock washers

Bag 2B - Screws and Washers



24x 1/4-20 x 3/8" Screws & Washers

Bag 3 - Screws and Washers (Upright to Bar Bracket)

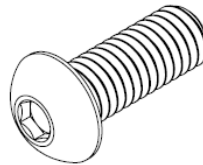

8x 3/8-16 x 1" screws



8x 3/8" Washers

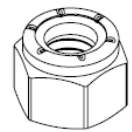

8x Locknuts



8x large shoulder washers



8x small shoulder washers

Bag 4B - T-nuts and screws (Crossbar to bar brackets)

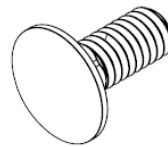

56x 5/16" carriage bolts

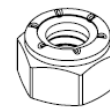

56x 5/16" lock nuts



56x 5/16" washers



12x 5/16" Lock Nuts

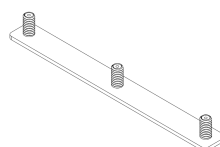

4x T-slot Plate
(truck models with T-slot rails)

Tools Required (not included):

- Measuring Tape
- Hex Driver 5/32
- Hex Driver 7/32
- 9/16" Socket Wrench
- 1/2" Socket Wrench

****Do not use power tools****

****Use SAE Sized tools only, no metric****

PRE INSTALL NOTES:

You will likely need to remove your Tonneau cover to attach the brackets in step 7.

After the brackets are installed and in position you will need to reinstall your Tonneau cover.

Covers with bedside rails must be removed, and depending on placement of the uprights, others may need to be removed as well.

Step 1

Prepare Screws and Brackets

Using the screws, washers, and lock nuts from Bag 4B pre install 6 into each riser bracket and 4 into each front to back connector bracket, 56 total.

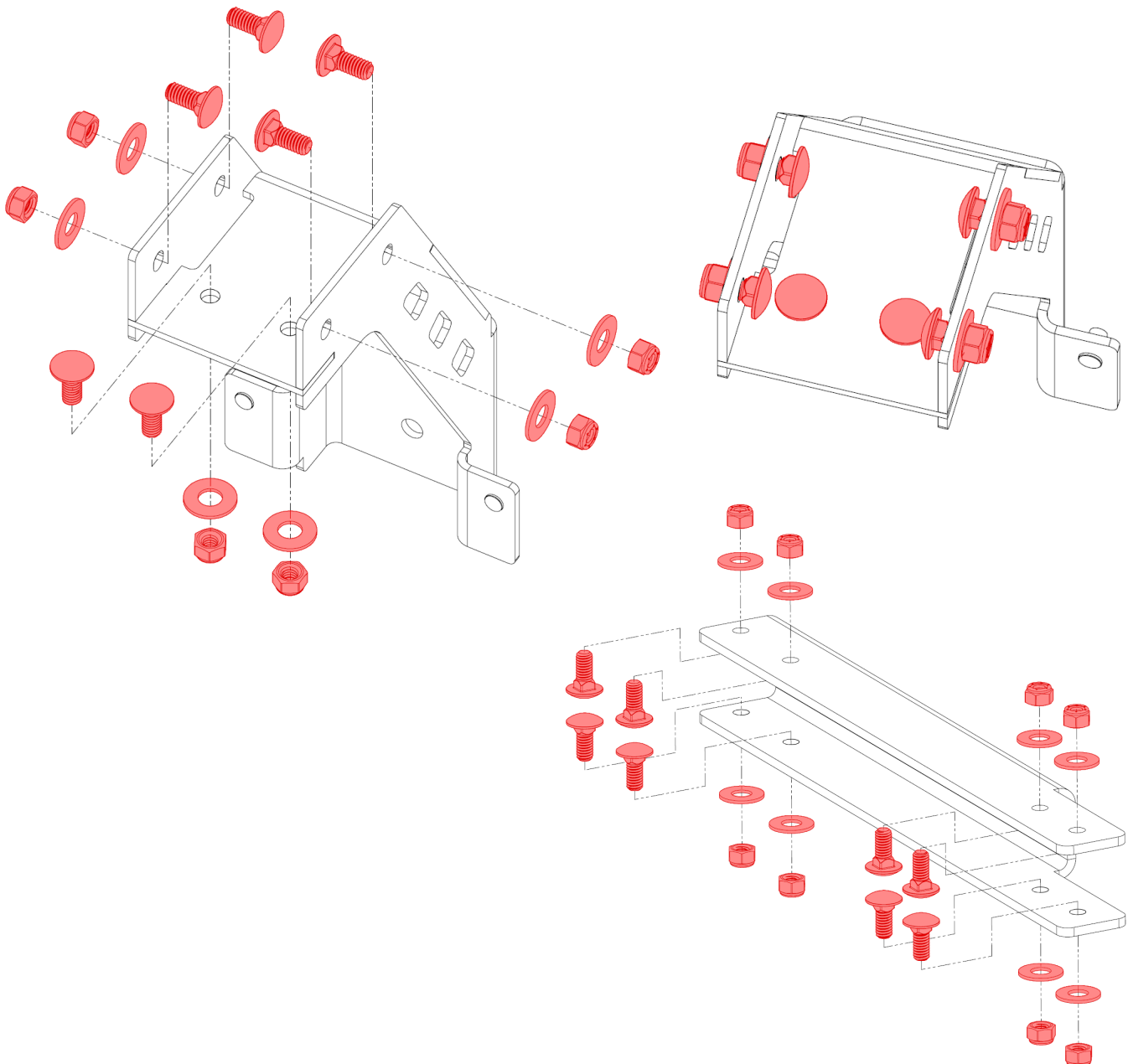

Step 2

Slide Front to back connector Brackets onto Crossbars.

Align the carriage bolts with the t slot extrusions and slide the brackets onto the crossbars. You'll want to align it so that the "C" shape of the bracket faces inside or outside based on your aesthetic preference. If you are planning to add a MSP at any point, the "C" will need to face outward.

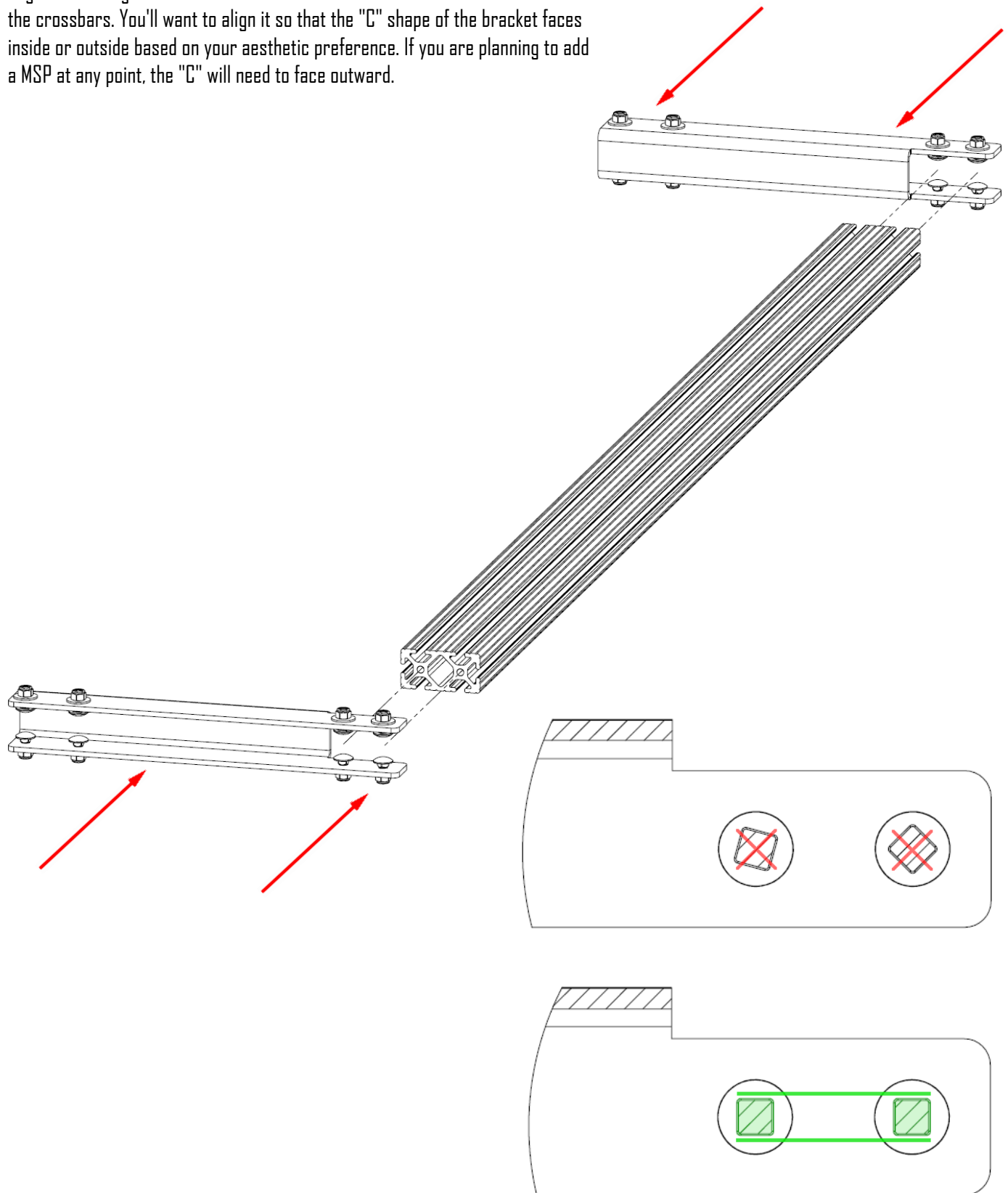

Step 3

Attach Faceplates or Accessory Panels to Upright Brackets.

Use the screws and washers from Bag 2B to attach your faceplates or accessory panels to each Upright bracket. Tighten these down now.

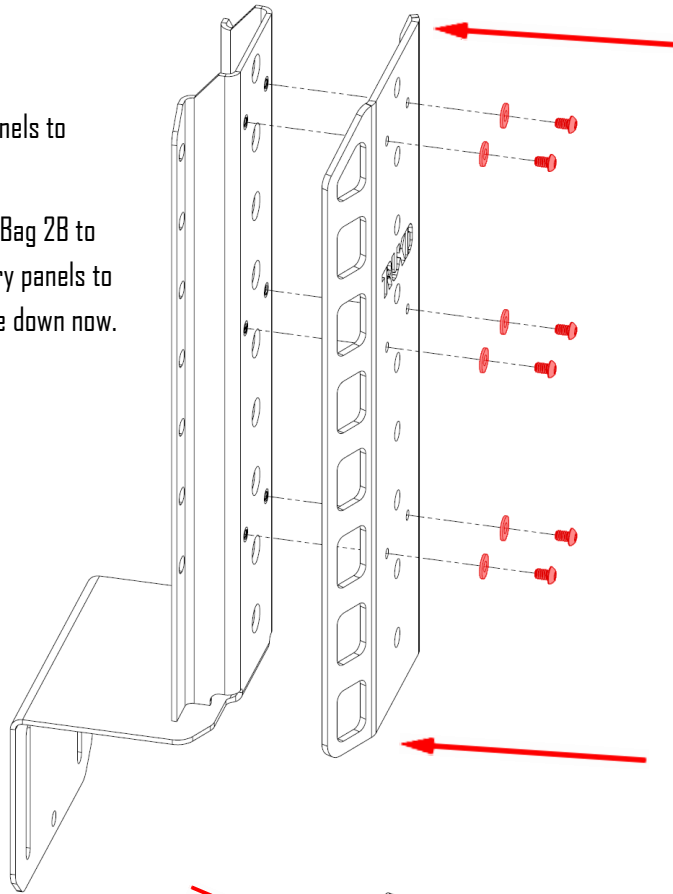

Step 4

Attach riser brackets to your uprights.

Use the screws, shoulder washers, washers and lock nuts from bag 3A to attach your bar end brackets to your 18.5" uprights.

Make sure you put two plastic shoulder washers on the positioning pins and that you use the larger shoulder washers on the outside of the upright with the 3/8" screw. The washer and the locknut go on the inside of the bracket.

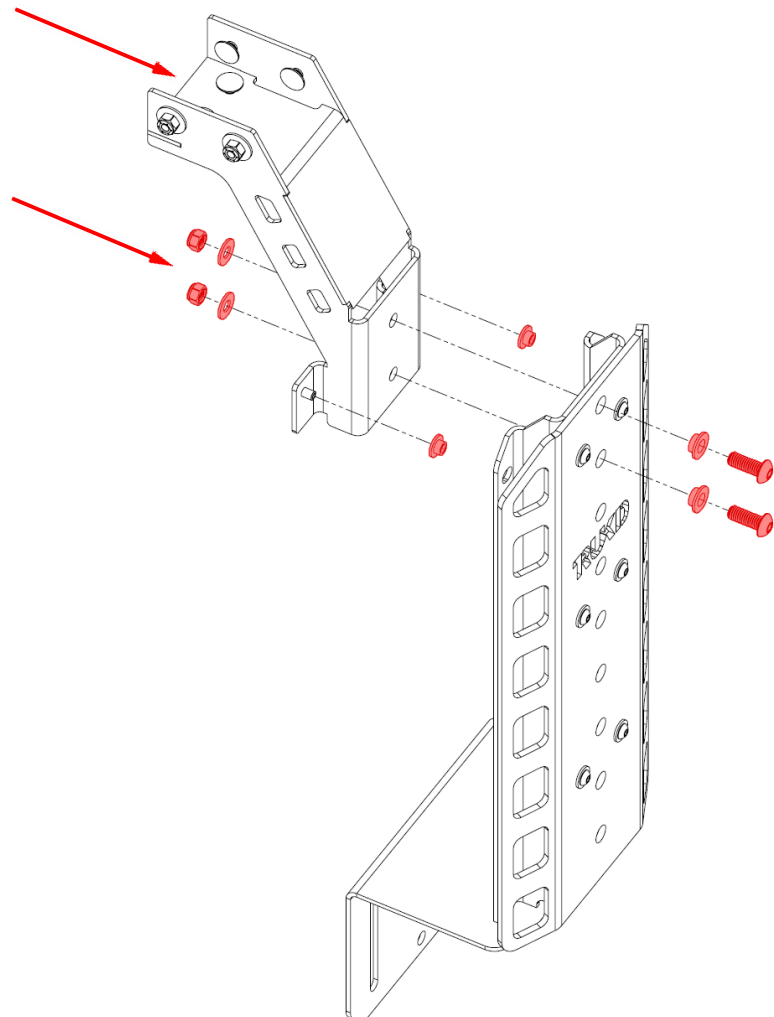

Step 5

Attach the Cross Bars. Slide one end of your crossbar into each upright bracket and loosely tighten one of the lock nuts to prevent it from sliding off.

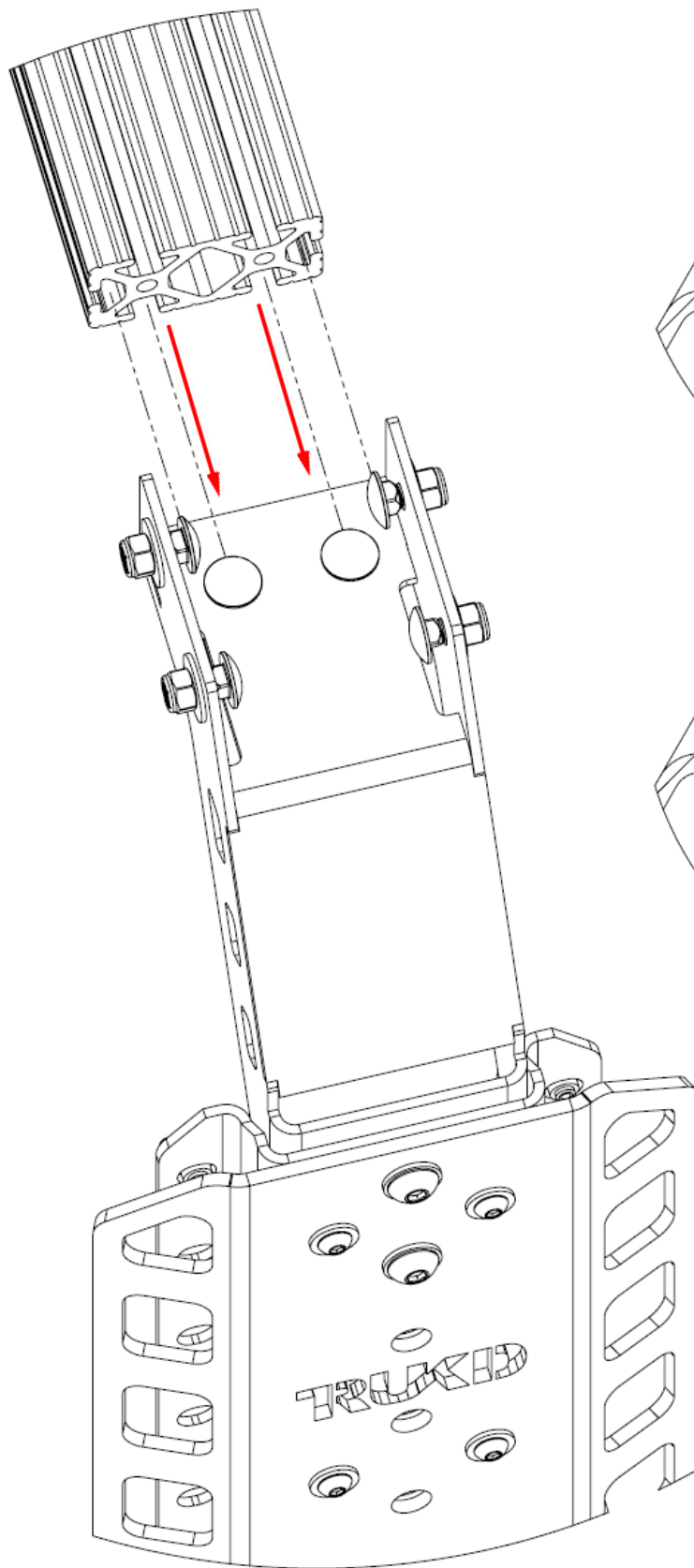

You may need to spin the carriage bolts to get the squares to line up with the crossbar T slots.

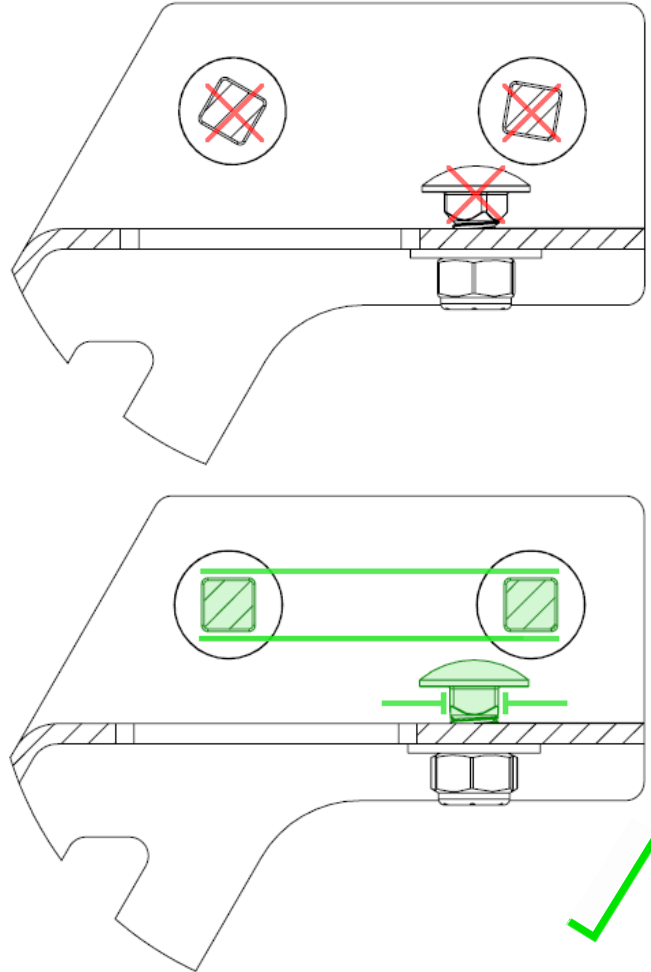

Step 6

Connect the Front Crossbar to the Back Crossbar

Use the two pieces of 1.5" square extrusion to slide into the "C"Shaped front to back connector brackets (already attached to your crossbars in step 1&2). Connect one end at a time and evenly space it between your crossbars. When finished with this step, your rack should be one complete unit. **Loosely tighten one bolt per connection in order to move the unit to your truck.**

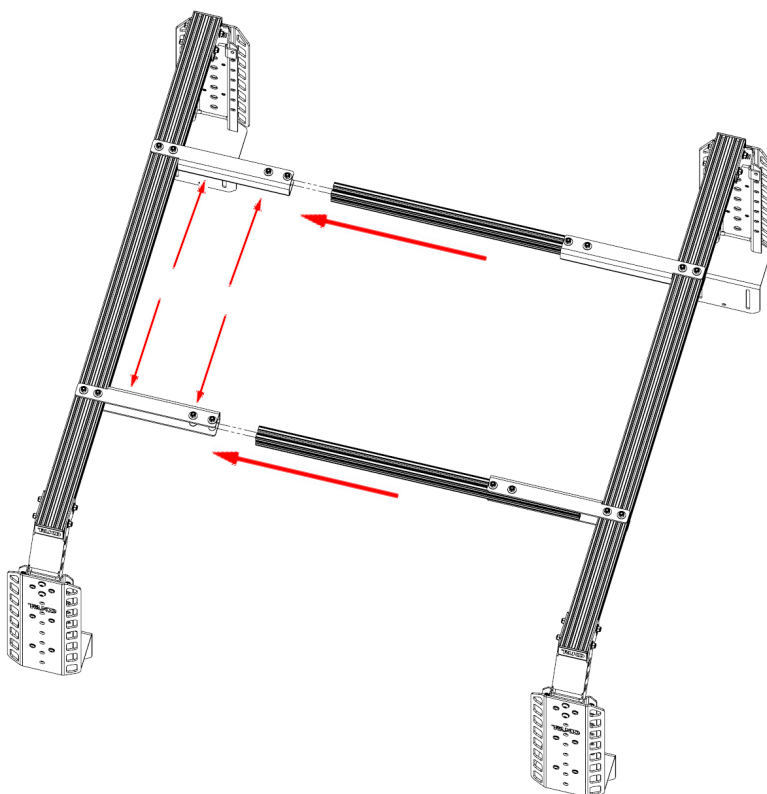
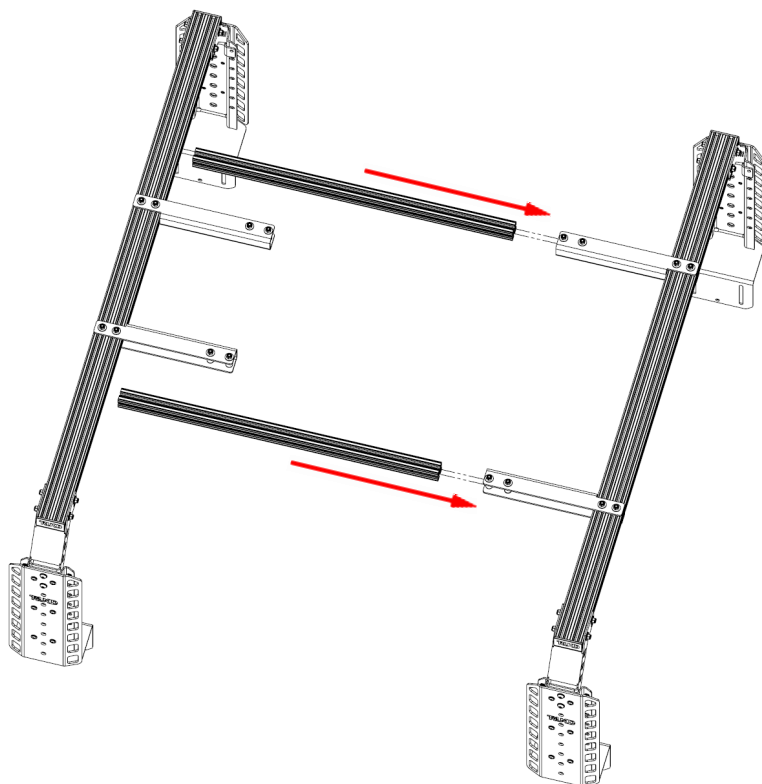

Step 7 (No Utility Rail)

Lift the rack as a single unit onto the truck bed with all four uprights sitting on the bedside.

It is recommended that you have an extra pair of hands for this step to avoid damage to the rack or personal injury.

Using the supplied bed clamps, use the 3/8-16 bolts and washers from Bag 1, to loosely attach the rack to your truck bed.

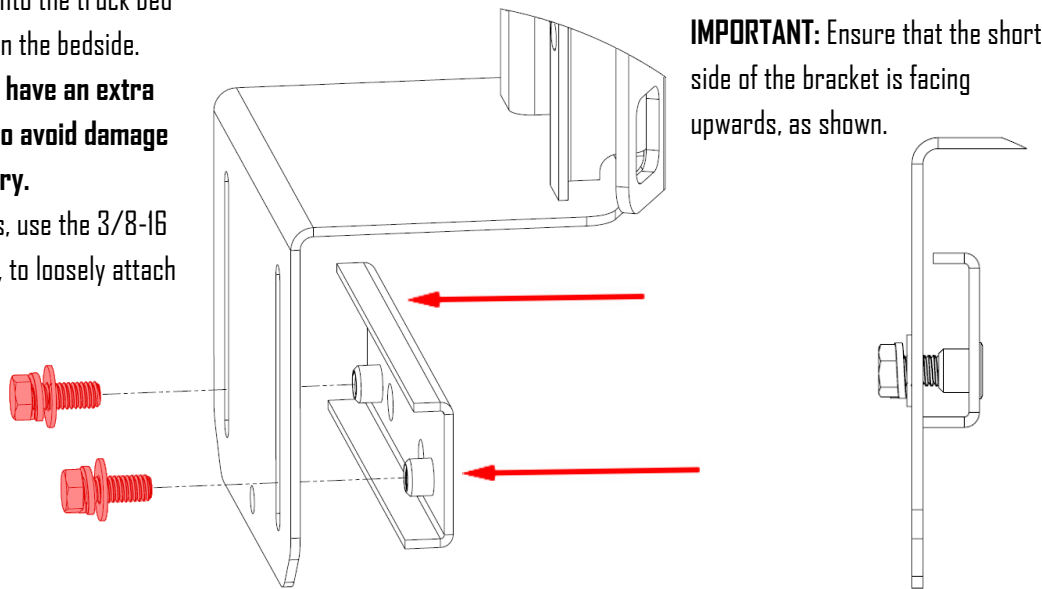

IMPORTANT: Ensure that the short side of the bracket is facing upwards, as shown.

IMPORTANT: Adjust the width of the rack to match the bed precisely. You may need to adjust the location of the bracket on the crossbar to ensure each bracket is vertical.

Once the brackets are aligned, tighten them down making sure the upright is vertical. Adjust if needed to ensure each bracket is vertical.

Once vertical, tighten all 6 locknuts on each bar end with a ratchet and socket. Finally adjust the length of your rack to your desired length and position using the front to back connector brackets. Once in position tighten the nuts on the front to back connectors and the connections to the truck bed.

Tighten the bolts until the clamp grabs the bedside and the upright bracket cannot move front to back, and tighten an additional turn. **Do not over tighten to avoid damage to the clamp and rivet nuts. You can deform the steel by over tightening.**

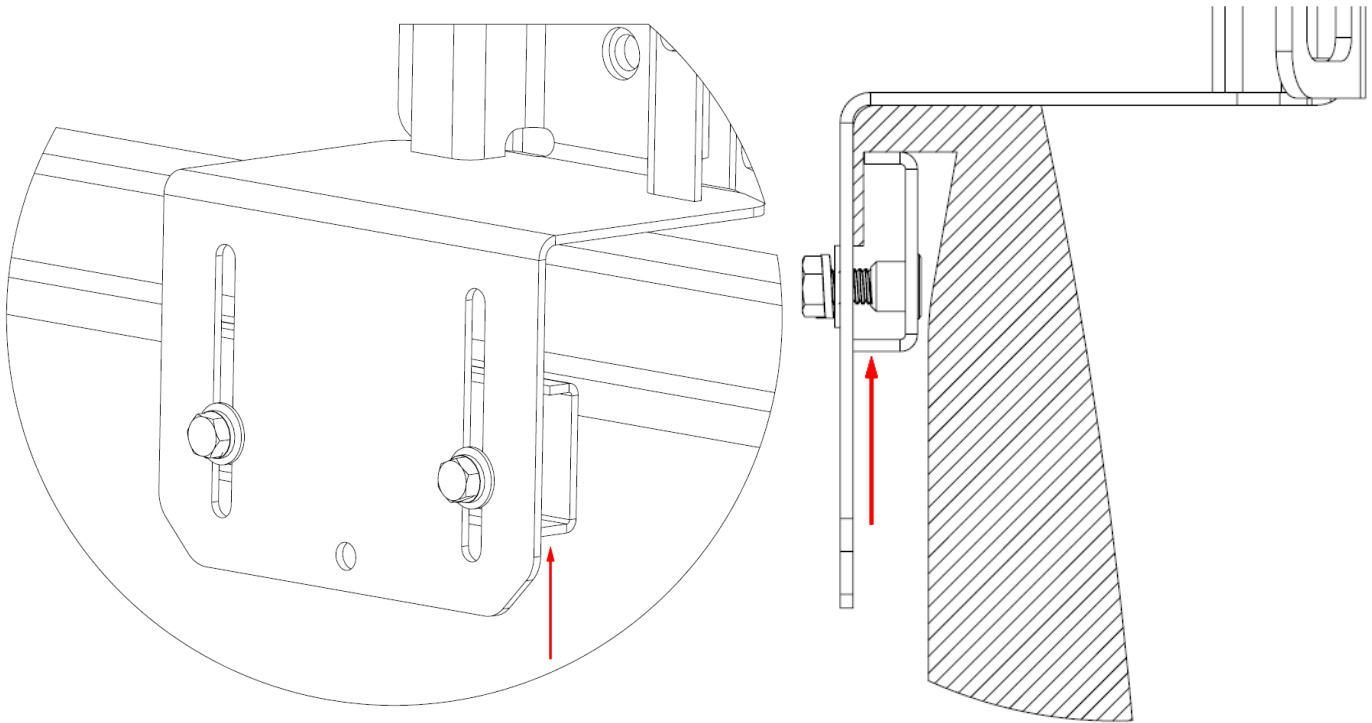

Step 7 (Utility Rail Mount)

Lift the rack as a single unit onto the truck bed with all four uprights sitting on the bedside.

It is recommended that you have an extra pair of hands for this step to avoid damage to the rack or personal injury.

Using the supplied utility rail nuts, use the 3/8-16 bolts and washers from Bag 1, to loosely attach the rack to your truck bed.

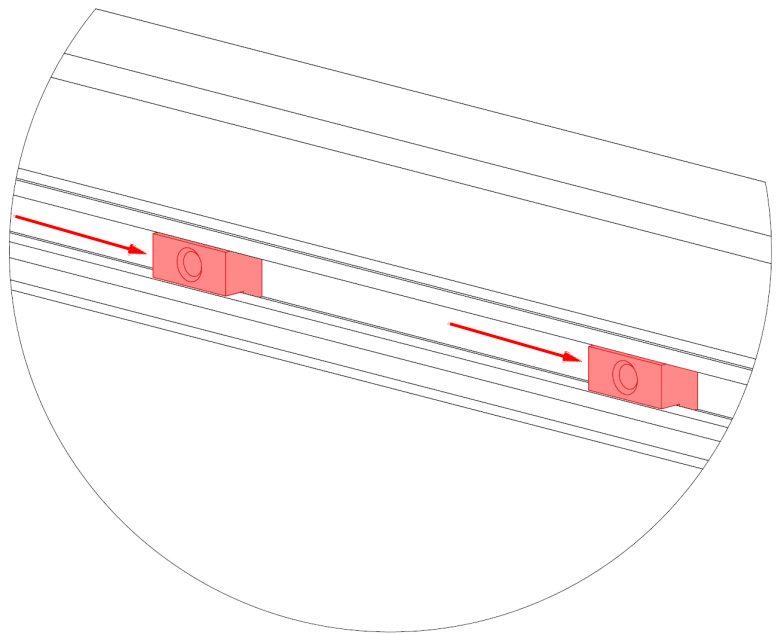

IMPORTANT: Adjust the width of the rack to match the bed precisely. You may need to adjust the location of the bracket on the crossbar to ensure each bracket is vertical.

Once the brackets are aligned, tighten them down making sure the upright is vertical. Adjust if needed to ensure each bracket is vertical.

Once vertical, tighten all 6 locknuts on each bar end with a ratchet and socket. Finally adjust the length of your rack to your desired length and position using the front to back connector brackets. Once in position tighten the nuts on the front to back connectors and the connections to the truck bed.

Tighten the bolts until the clamp grabs the bedside and the upright bracket cannot move front to back, and tighten an additional turn. **Do not over tighten to avoid damage to the clamp and rivet nuts. You can deform the steel by over tightening.**

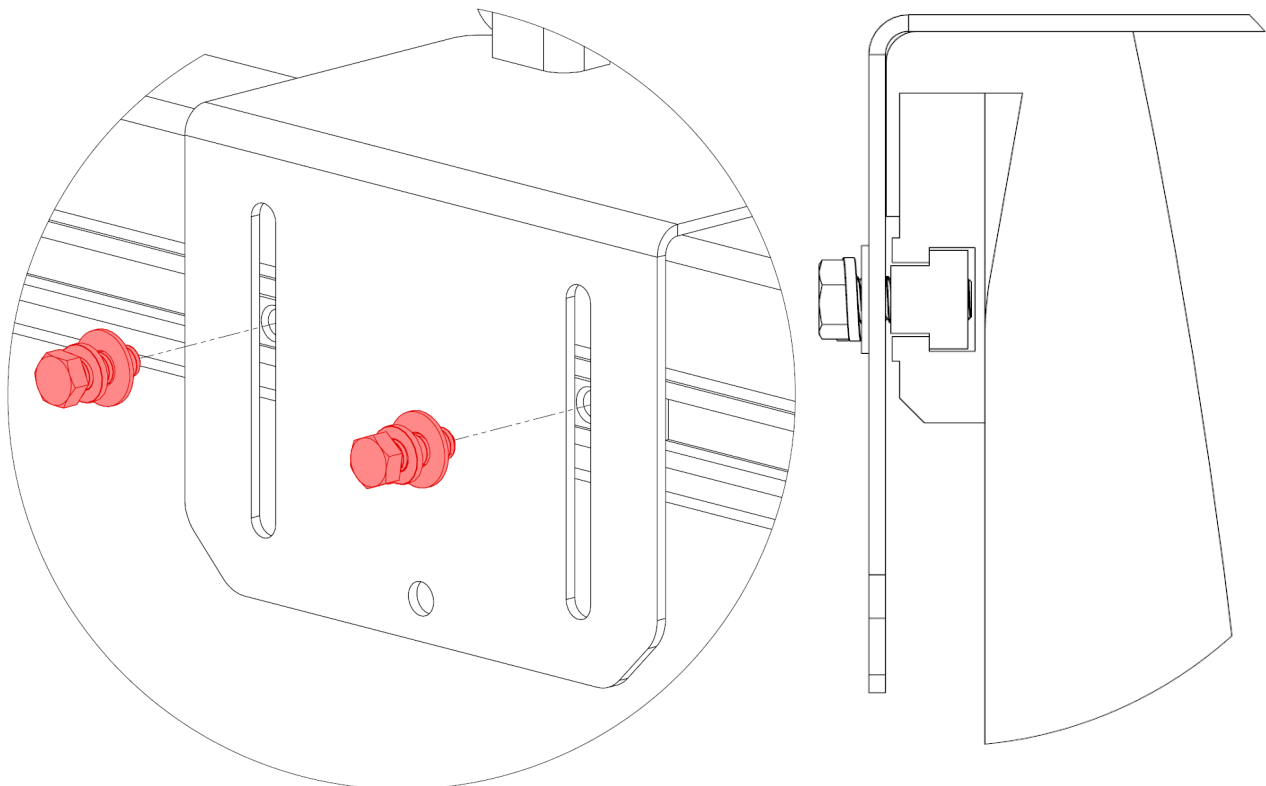

Step 7 (T-Slot Rail Mount)

Lift the rack as a single unit onto the truck bed with all four uprights sitting on the bedside.

It is recommended that you have an extra pair of hands for this step to avoid damage to the rack or personal injury.

Using the supplied stud plates, use the 3/8-16 bolts and washers from Bag 1, to loosely attach the rack to your truck bed.

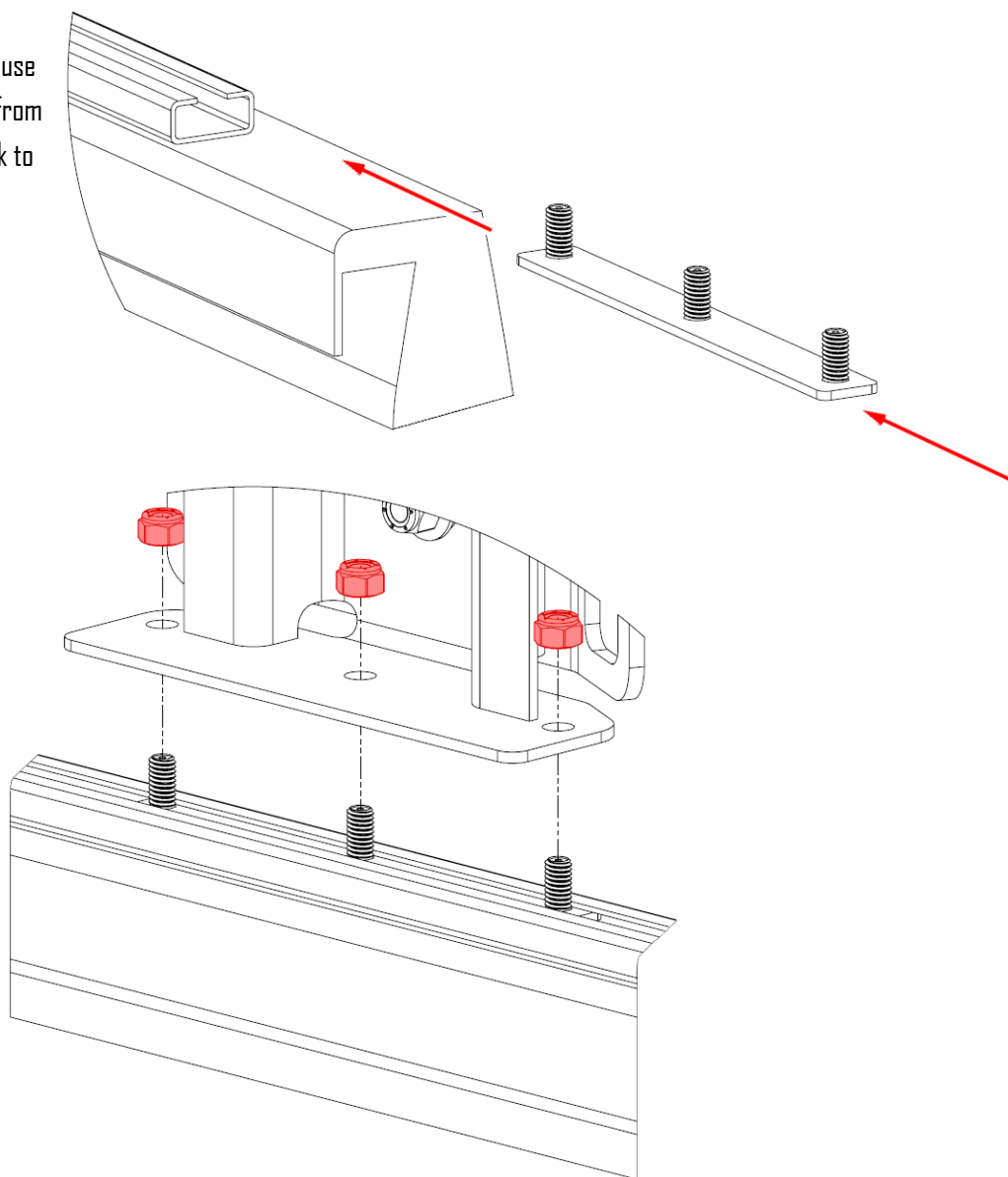

IMPORTANT: Adjust the width of the rack to match the bed precisely. You may need to adjust the location of the bracket on the crossbar to ensure each bracket is vertical.

Once the brackets are aligned, tighten them down making sure the upright is vertical. Adjust if needed to ensure each bracket is vertical.

Once vertical, tighten all 6 locknuts on each bar end with a ratchet and socket. Finally adjust the length of your rack to your desired length and position using the front to back connector brackets. Once in position tighten the nuts on the front to back connectors and the connections to the truck bed.

Tighten the bolts until the clamp grabs the bedside and the upright bracket cannot move front to back, and tighten an additional turn. **Do not over tighten to avoid damage to the clamp and rivet nuts. You can deform the steel by over tightening.**

Step 8

Tighten All Screws

Go over every screw in the system and ensure that it is tight. Once everything is tight your rack should feel very solid.

If you push on the side and there is play, something did not go together correctly.

Contact us if you have any issues.

Excessive play will also cause parts to rub on each other wearing through the powder coat and opening up the possibility for rust to occur.

After driving with the rack installed for 25-50 miles on road or 10 miles offroad, check and tighten all bolts.

Bolts may loosen as the rack settles. **Periodically check your bolts to make sure they remain tight.**

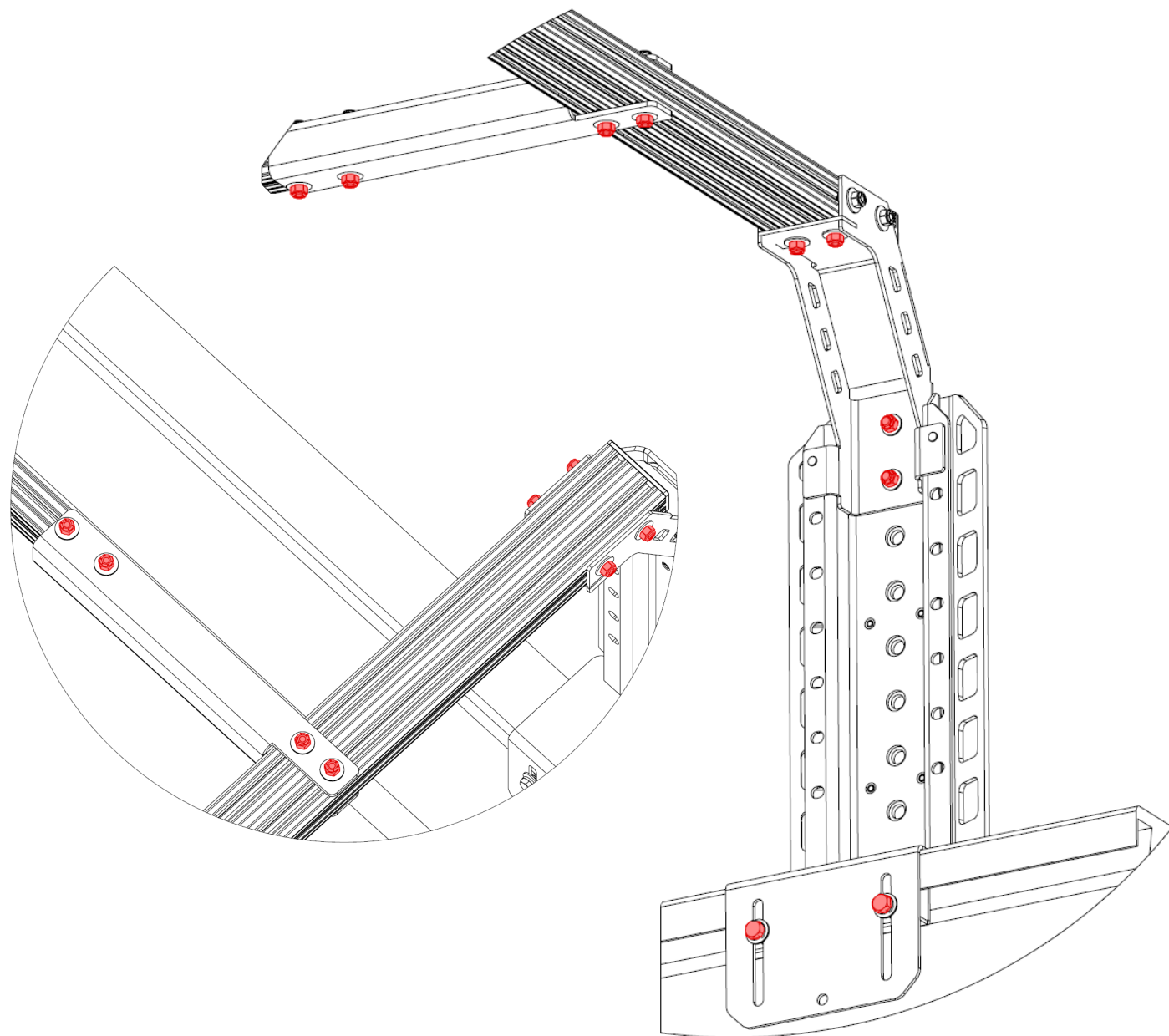

Step 9

With everything positioned correctly and all bolts tightened, attach the 4 bar end caps onto each exposed end of the crossbars.

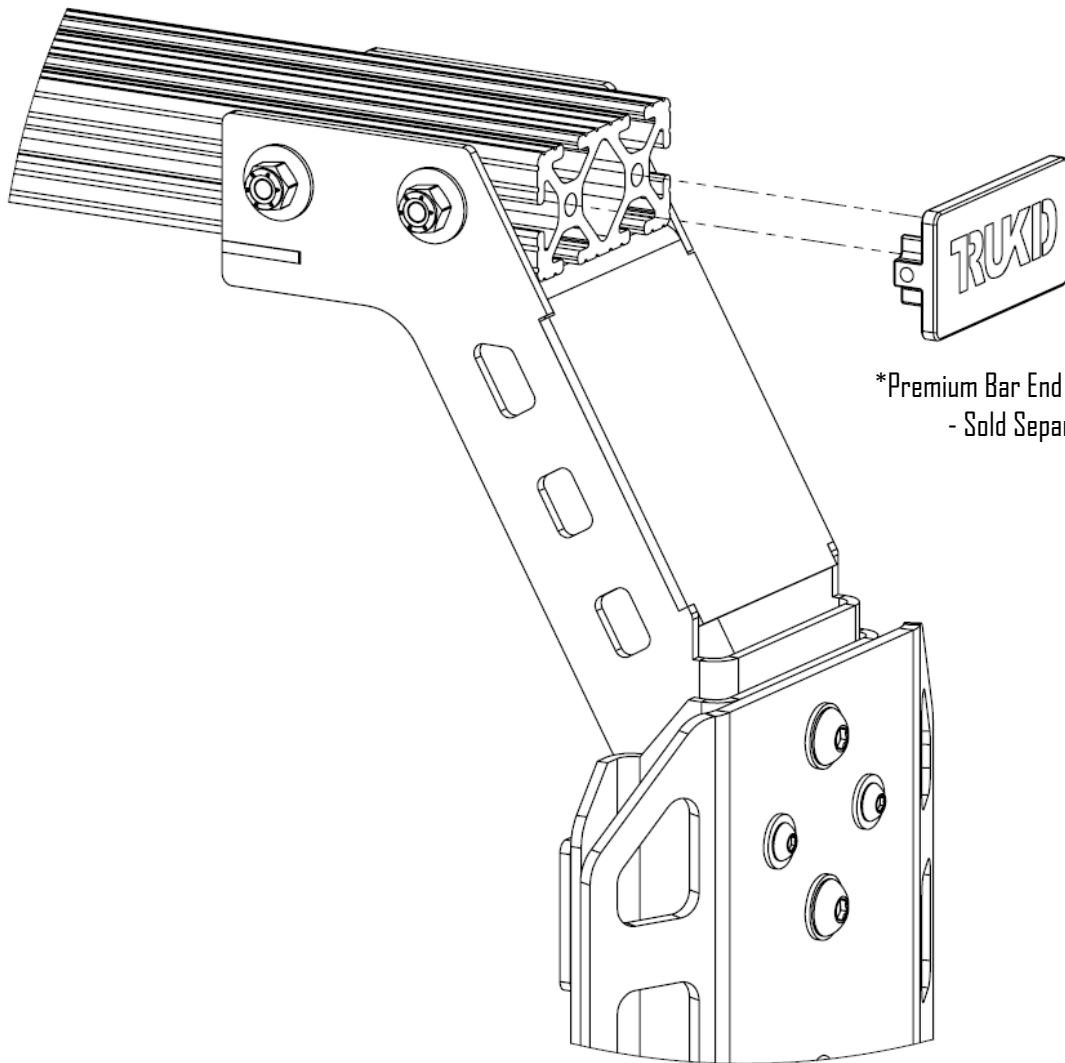

*Premium Bar End Cap Pictured
- Sold Separately-

Final Words

Special Notes: This rack is designed for off-road use; however, this is not a jump rated or high speed rated product. Do not overload your rack. This rack is officially rated for 250lbs of driving load and 1000lbs of parked load or your truck's bedside load rating (driving and parked), whichever is lower. Overweight racks or reckless driving is dangerous to you, your truck, and others around you. Please drive responsibly and tread lightly.

Shipping Damage: If your product arrives damaged, please let us know within 7 days so that we can start a claim with UPS. We will not be able to process a shipping claim without pictures of the original packaging. Small bumps or scratches can happen during shipping, these are not covered and are impossible to completely prevent even though we do our best. We recommend touching these up, contact us for the best match paint recommendation.

Warranty: Typical wear and tear through use is not covered, but any type of manufacturer's defect has a lifetime warranty. Misuse as specified above is not covered under the lifetime warranty. We stand behind this product and expect it to last a very long time, if it doesn't please reach out.

Thank You: Thanks for purchasing from TRUKD. We are a small business based out of Pittsburgh, with every part of our racks made in the USA. We appreciate every one of our customers, we wouldn't be here without you. If you are truly thrilled by our product, please leave us a review, post some pictures and tag us, or buy some accessories! We hope to see you on the trails!