

INSTALLATION INSTRUCTIONS

PARTS LIST:

Qty	Description	Qty	Description
1	CS1 HD Front Bumper Assembly	2	12-1.75mm Triple Nut Plates
1	Winch Tray	14	12mm x 37mm x 3mm Flat Washers
1	Center Fill Plate	6	12mm Lock Washers
1	License Plate Bracket	8	12mm Nylon Lock Nuts
2	Plastic Plugs for License Plate	6	12mm x 45mm Hex Bolts
2	Driver/Left Triple Bolt Plates	4	10mm x 30mm x 2.5mm Flat Washers
2	Passenger/Right Triple Bolt Plates	6	10mm Nylon Lock Nuts
1	Driver/Left Side Fill Panel	2	10mm x 30mm Button Head Bolts
1	Passenger/Right Side Fill Panel	8	8mm x 24mm x 2mm Flat Washers
2	LED Light Brackets	4	8mm Lock Washers
2	Plastic Sensor Covers	4	8mm Hex Nuts
2	Sensor Extension Harness	2	8mm x 16mm Hex Bolts
2	Sensor Retaining Caps	4	8mm x 25mm Hex Bolts
1	Parking Sensor Cover Kit	4	6mm Flange Nuts
2	15.5mm x 25mm x 2mm Foam Washers	4	6mm x 20mm Button Head Combo Bolts
2	20mm x 10mm Foam Washers	1	6mm Hex Wrench
10	Nylon Wire Ties	1	5mm Hex Wrench
2	1100mm Edge Trim	1	4mm Hex Wrench

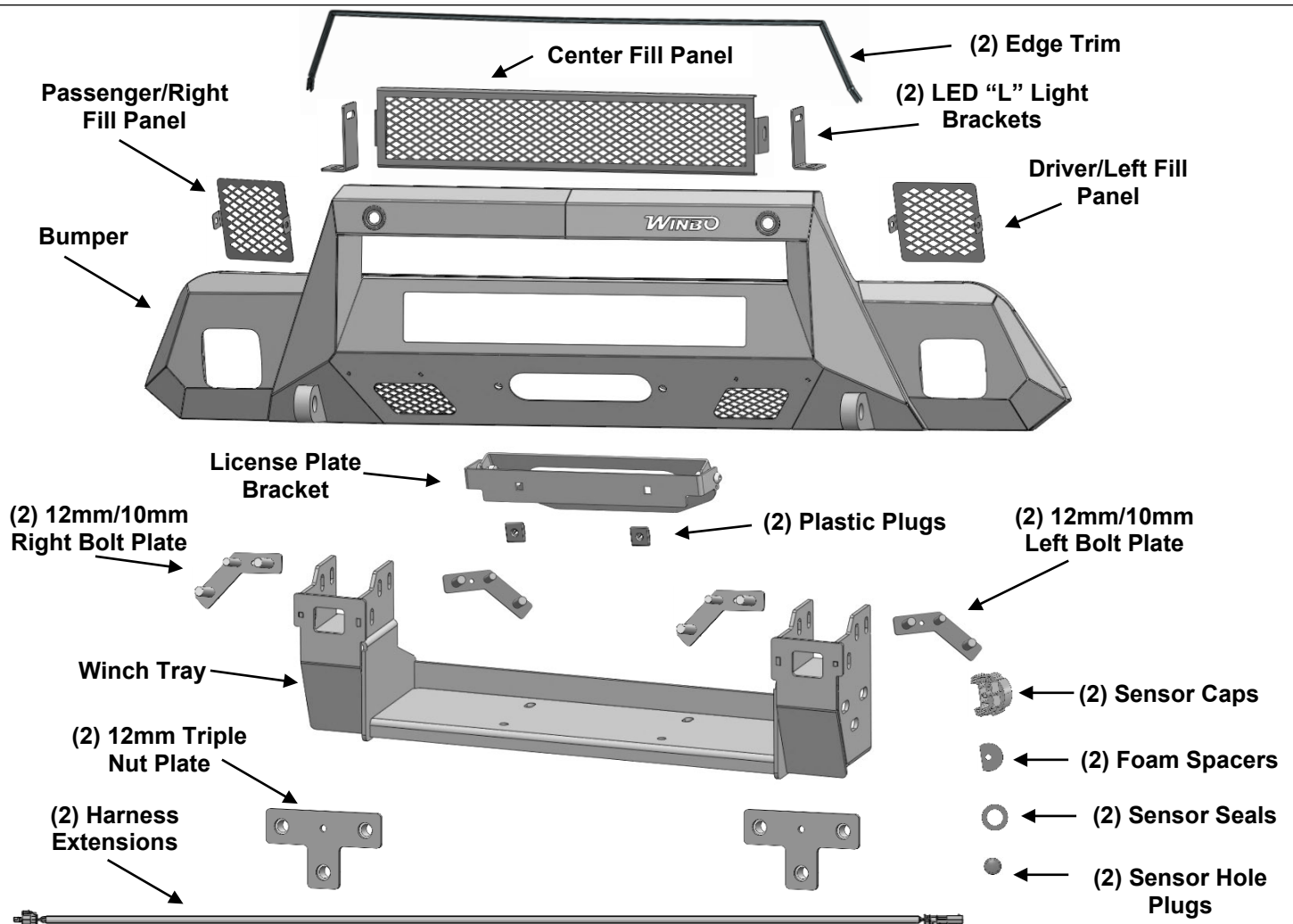

S182387 S182388

22-25 SILVERADO 1500 (Excl. 2022 1500 LTD, ZR2, Diesel and 4-Cylinder Turbo Gas)

Barricade HD Stubby Front Bumper



12mm Hex Bolt



8mm Hex Bolt



10mm Button Head Bolt

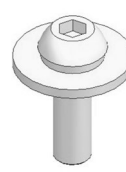

6mm Button Head Combo Bolt



12mm Lock Washer



8mm Lock Washer



12mm Flat Washer



10mm Flat Washer



8mm Flat Washer

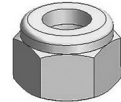

12mm Nylon Lock Nut

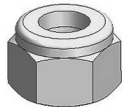

10mm Nylon Lock Nut

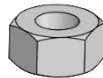

8mm Hex Nut



6mm Serrated Flange Nut



Hex Wrench

TOOLS REQUIRED



Ratchet



13mm Socket



Extensions



Wrench



21mm Socket



18mm Socket



16mm Socket



10mm Socket

1

Follow (Fig 1 – 14) to remove Front Bumper Assembly.

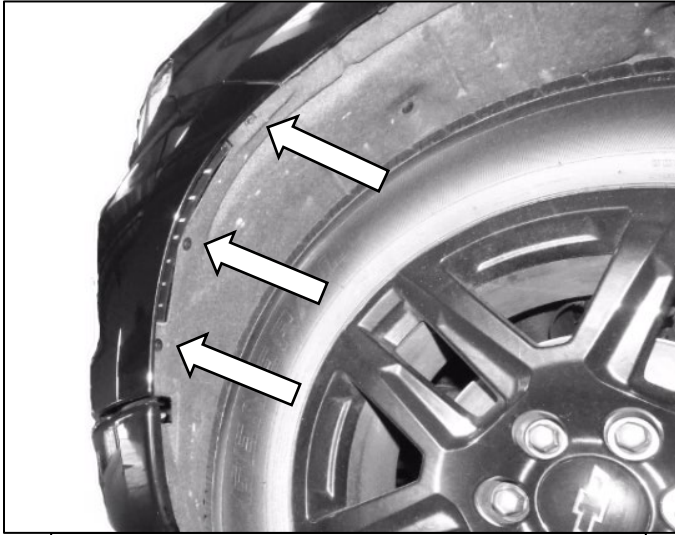

(Fig 1) Remove screws attaching driver/left fender liner to fascia body panel

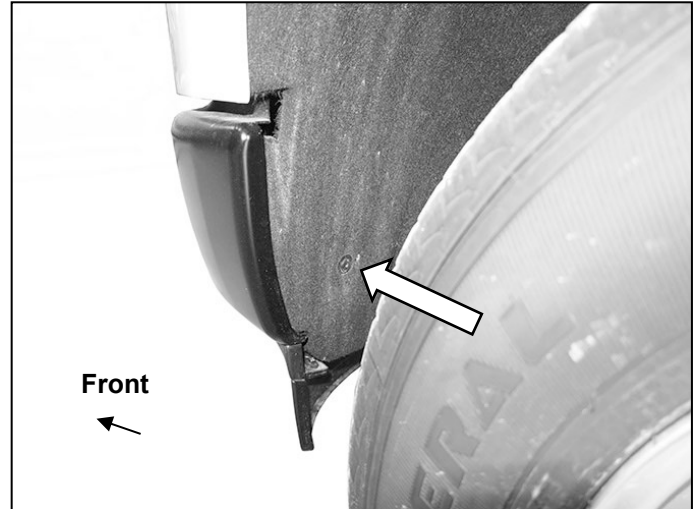

(Fig 2) Remove screws attaching driver/left fender liner to end of bumper

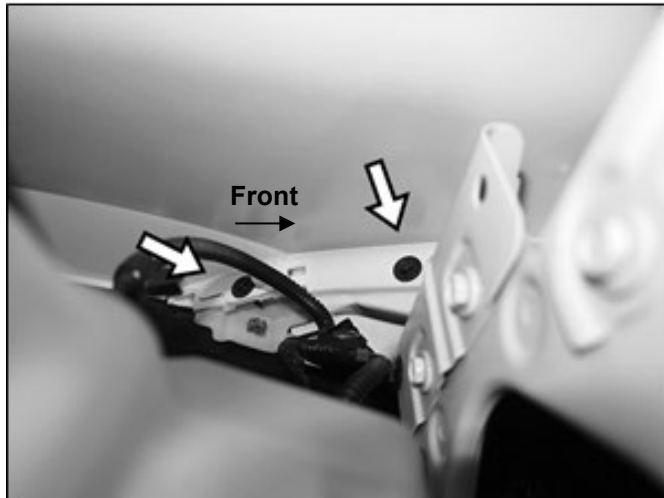

(Fig 3) Remove screws behind headlight attaching driver/left front end of fender to fascia body panel (arrows)



(Fig 4) Remove fascia body panel. If vehicle is equipped with front parking sensors/fog lights, disconnect the bumper harness on the passenger side

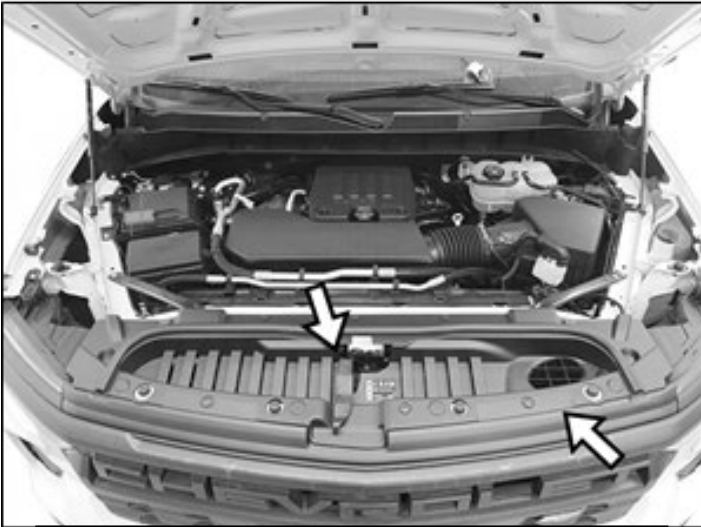

(Fig 5) Remove hood release handle and plastic cover. Reattach hood release handle

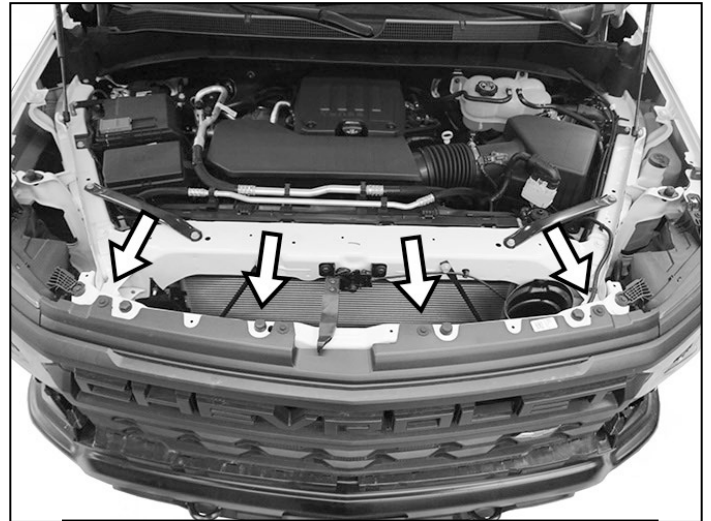

(Fig 6) Remove hardware attaching top of grille

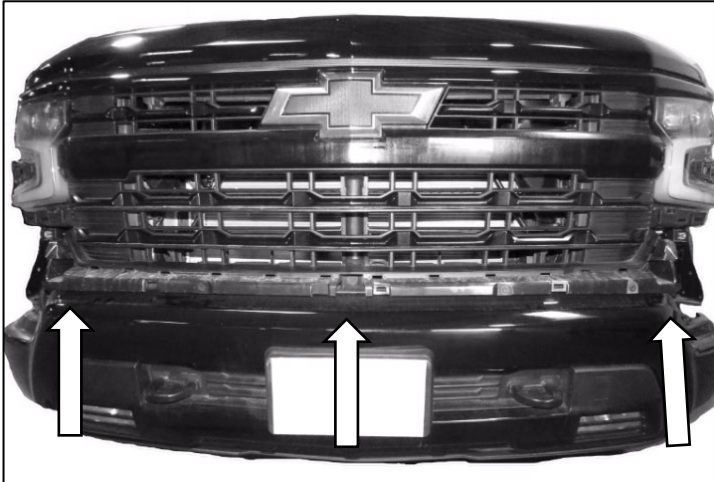

(Fig 7) Remove hardware attaching bottom of grille. Firmly pull grille straight out from vehicle

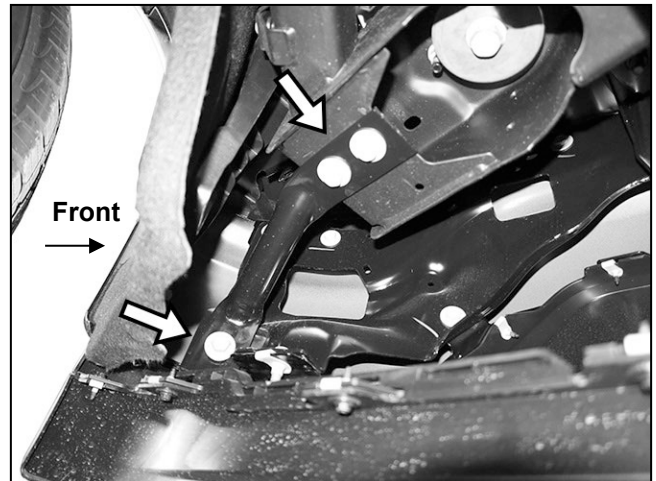

(Fig 8) Remove outer bumper supports (arrows)

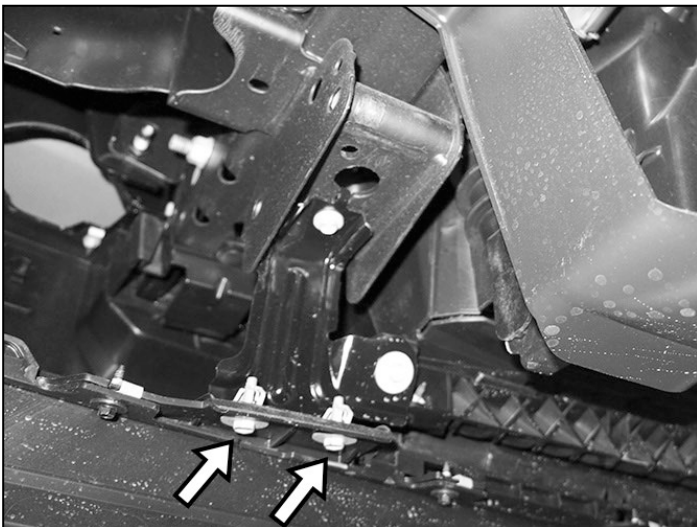

(Fig 9) Remove bolts attaching bottom of bumper to brackets (arrows).

S182387 S182388

22-25 SILVERADO 1500 (Excl. 2022 1500 LTD, ZR2, Diesel and 4-Cylinder Turbo Gas)

Barricade HD Stubby Front Bumper

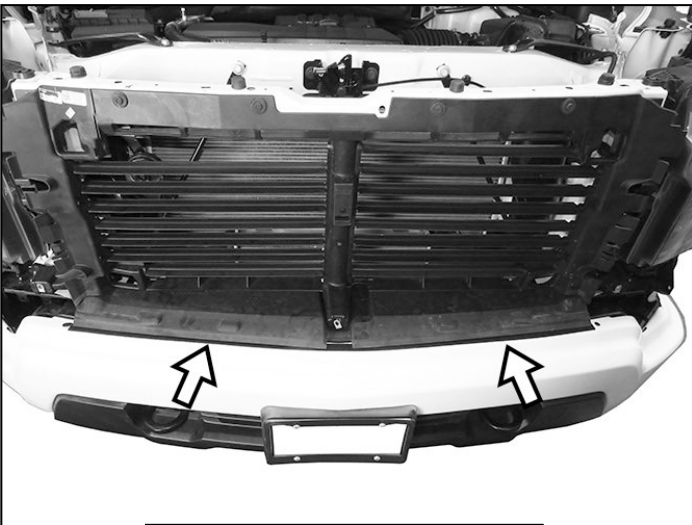

(Fig 10) Remove cover from top of bumper (arrows)

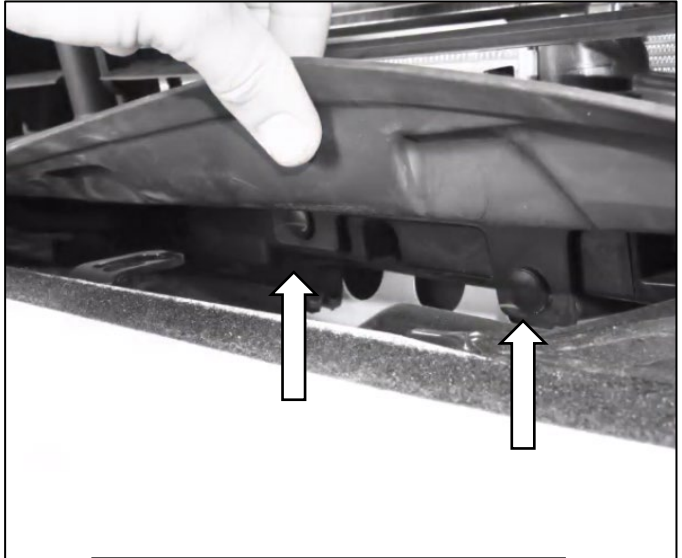

(Fig 11) The cover is held in place by plastic tabs underneath (7 total)

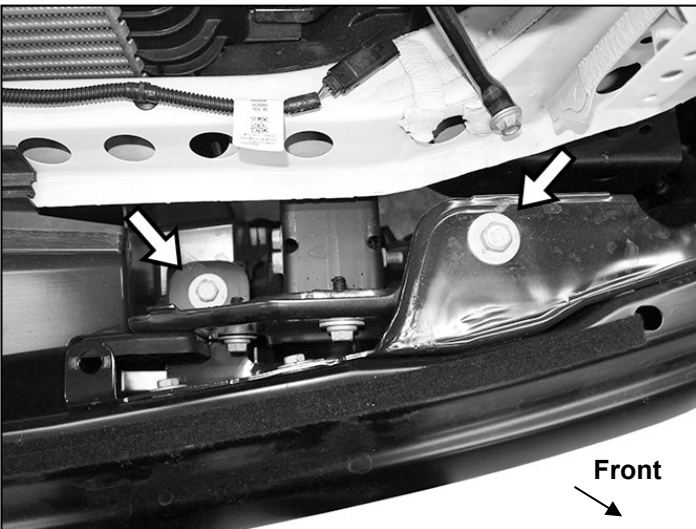

(Fig 12) Remove top bumper bolts to remove bumper, (arrows). Driver/left side pictured

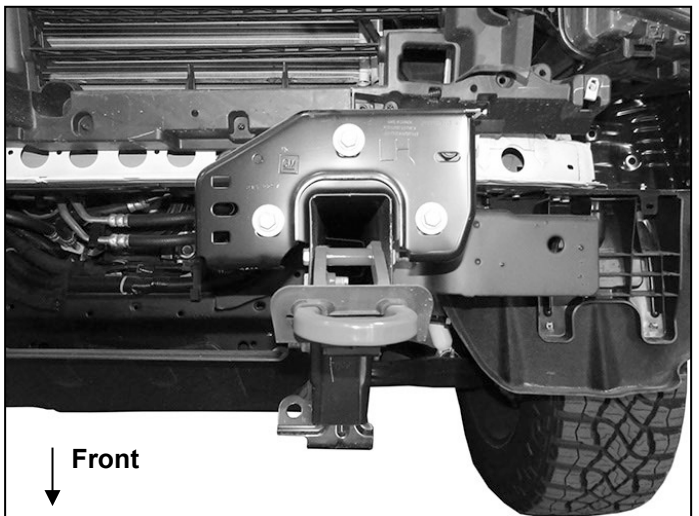

(Fig 13) Remove tow hooks from end of frame (if equipped)

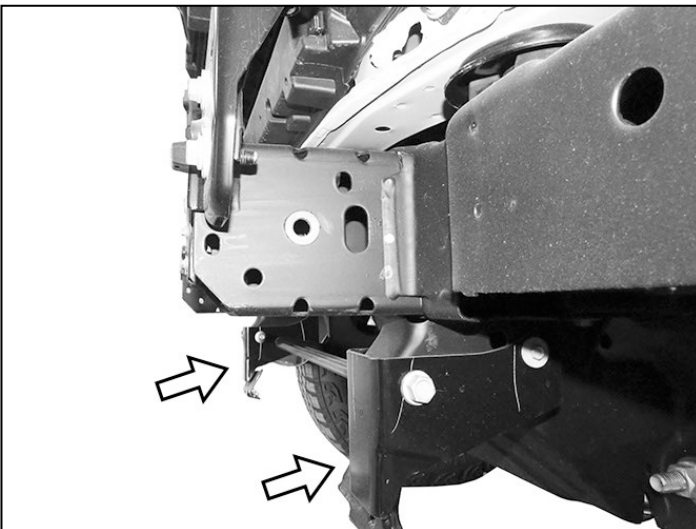

(Fig 14) Remove lower frame extensions (arrows)

2 Follow (Fig 15 – 19) to install Winch Tray. **Only loosely install hardware at this time.**

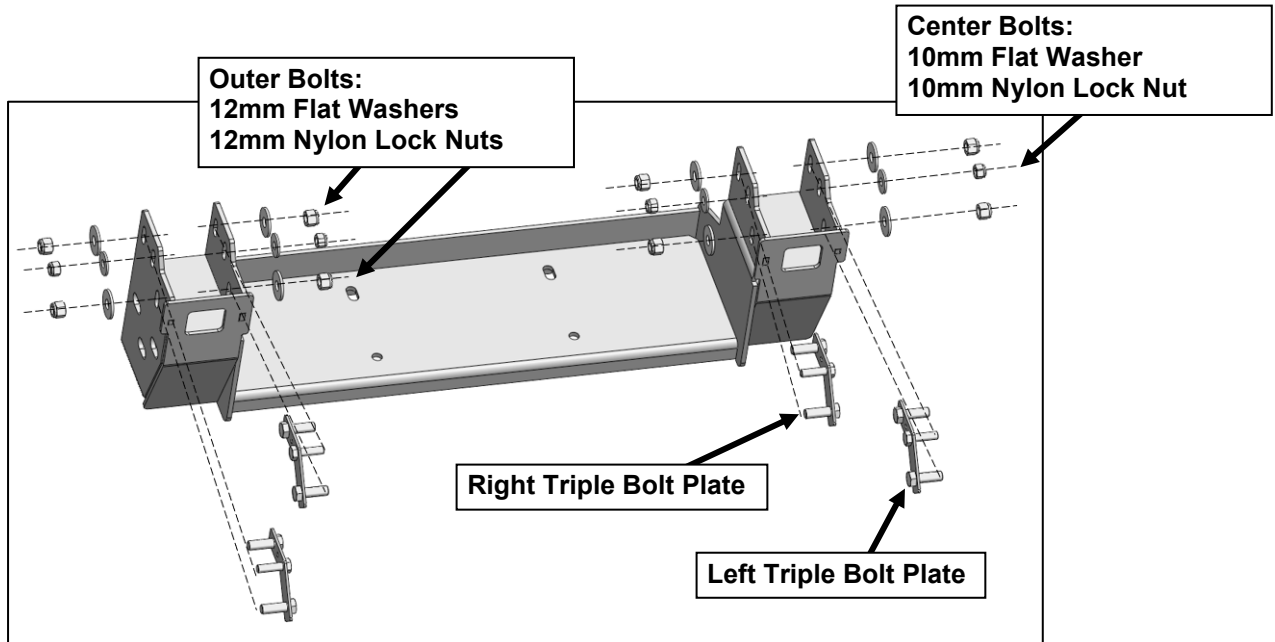

(Fig 15) With assistance, carefully lift the winch tray up to the frame, aligning the mounting slots in the winch tray with the corresponding holes on the frame. Use (1) left triple bolt plate and (1) right triple bolt plate on each side of the winch tray



(Fig 16) Slip (1) Left Triple Bolt Plate and (1) Right Triple Bolt Plate into the frame on each side (Driver side shown)

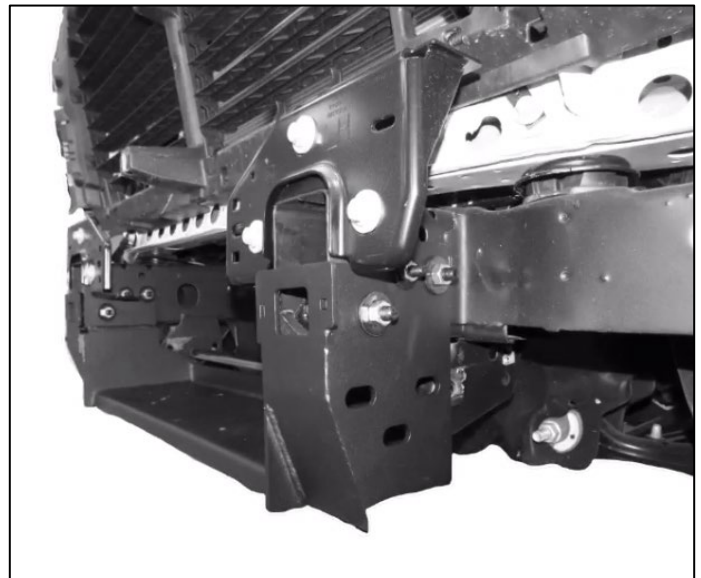

(Fig 17) Winch Tray installed

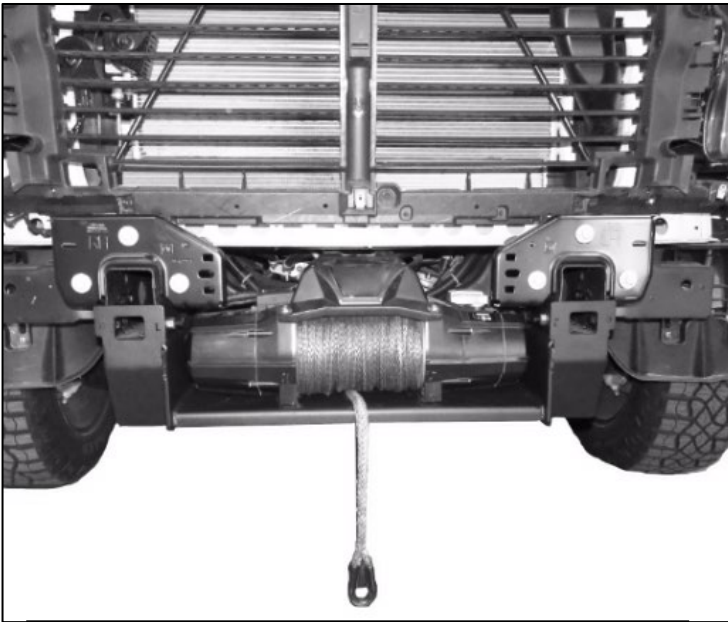

(Fig 18) If you plan on installing a winch, do it now

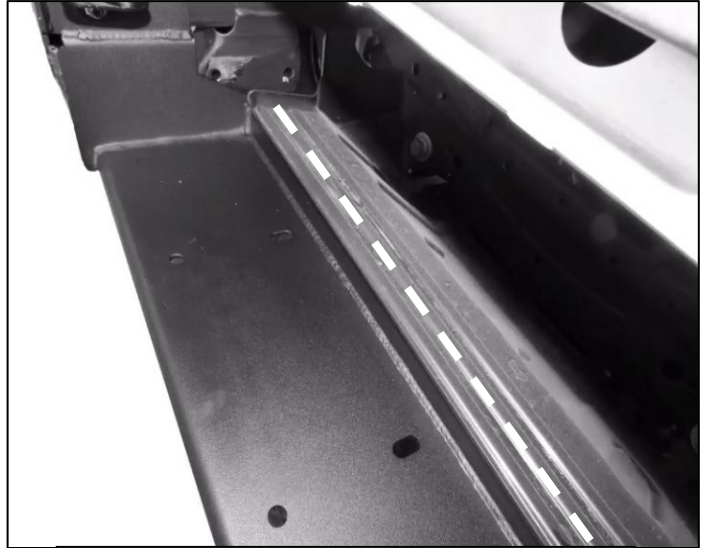

(Fig 19) The front of the plastic splash guard may be trimmed back about 1in/25mm if it interferes with the winch

- 3** Follow (Fig 20 - 31) to prepare vehicle and Center Bumper Guard. **Only loosely install hardware at this time.**



(Fig 20) Separate bottom plastic bumper from upper piece

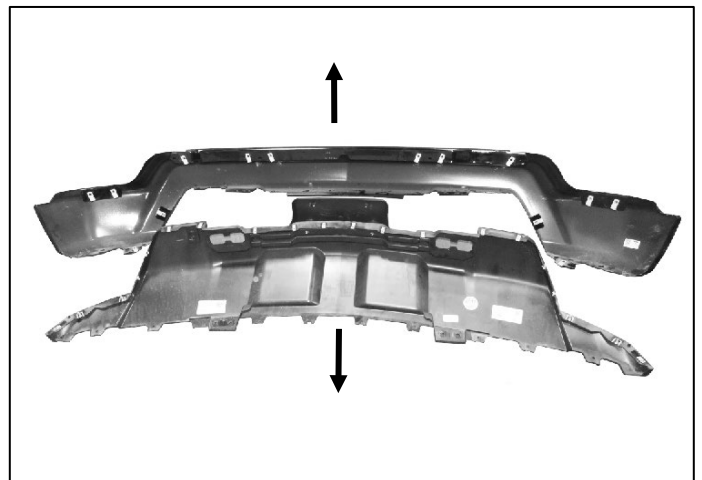

(Fig 21) Separated bottom plastic bumper from upper piece



(Fig 22) Reinstall factory grille and upper bumper section to vehicle.

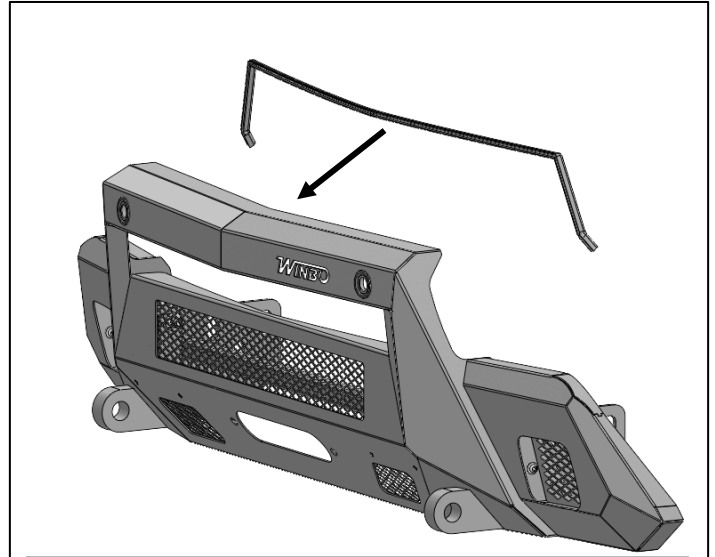

(Fig 23) Install protective edge trim onto upper edge of Center Bumper Guard Hoop.

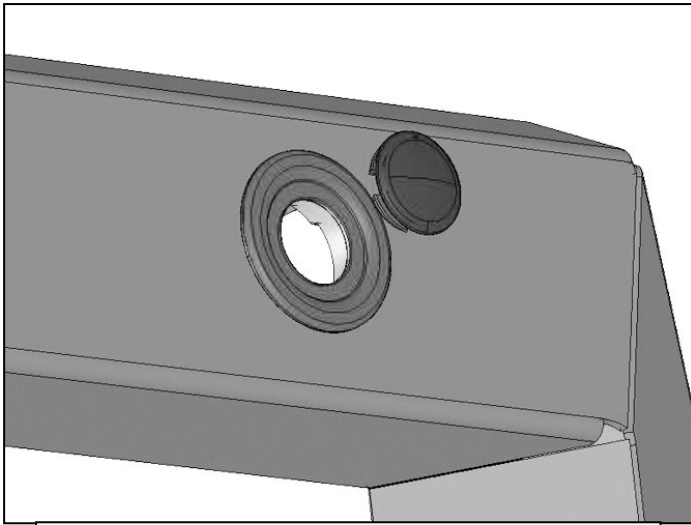

(Fig 24) Models without sensors, insert Plastic Plugs into sensor mounts on Bumper Hoop

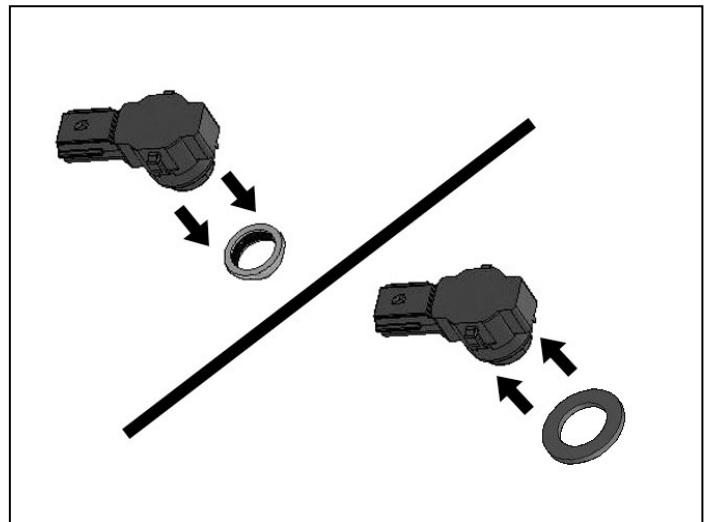

(Fig 25) Remove silicone seal from sensor. Slide large Seal over end of sensor (arrow)

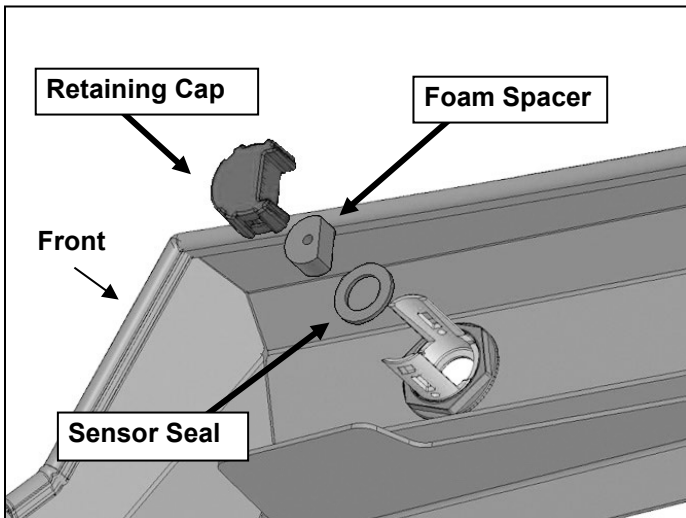

(Fig 26) Push sensor plug into mounting sleeve

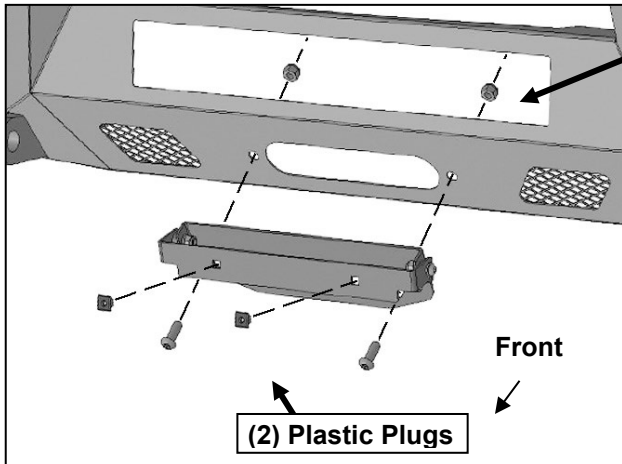

(Fig 27) Attach License Plate Bracket to Bumper

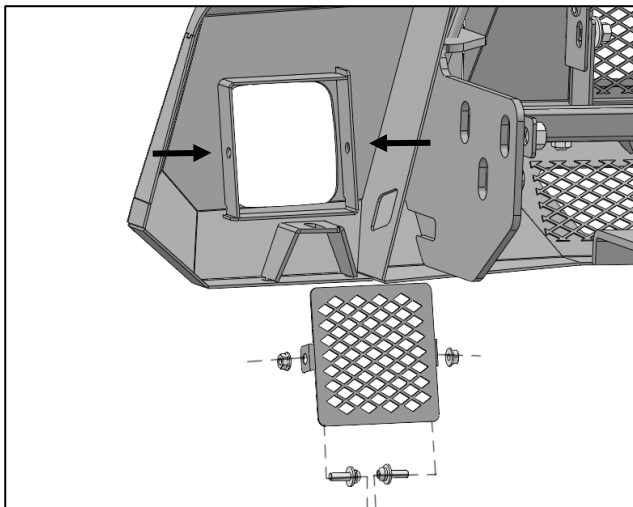

(Fig 29) If not using LED cube lights, install fill panels using indicated hardware on each side

- (1) 8mm x 25mm Hex Bolt
- (1) 8mm Lock Washer
- (2) 8mm x 24mm x 1.6mm Flat Washer
- (1) 8mm Hex Nut

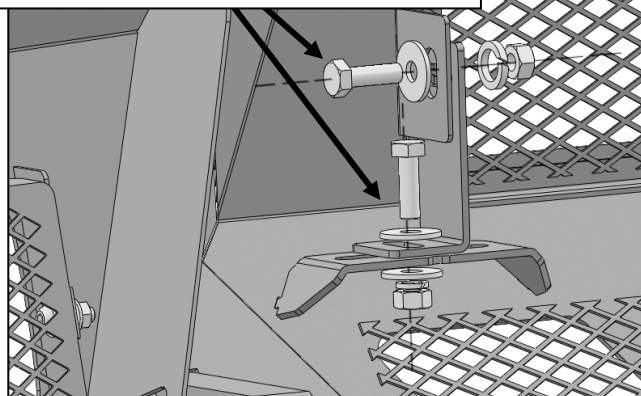

(Fig 31) If not using LED Light Bar, install center mesh plate instead using indicated hardware

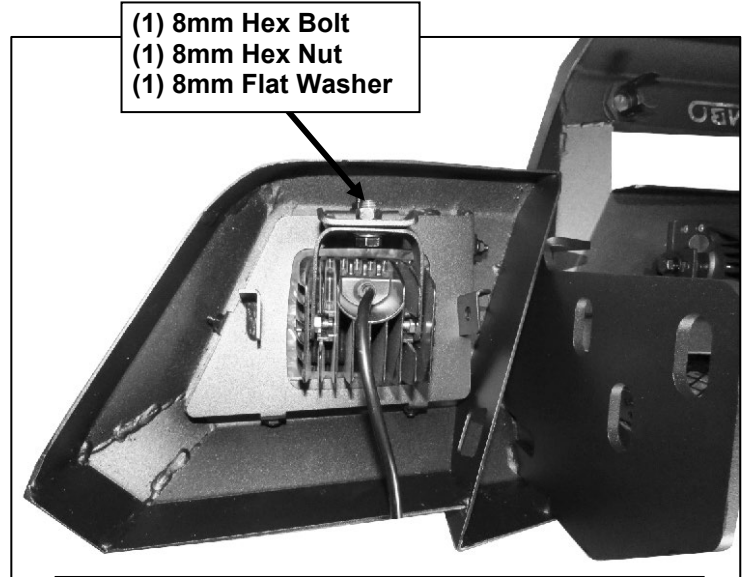

(Fig 28) If using LED Cubes, use indicated hardware to attach to LED mounting bracket

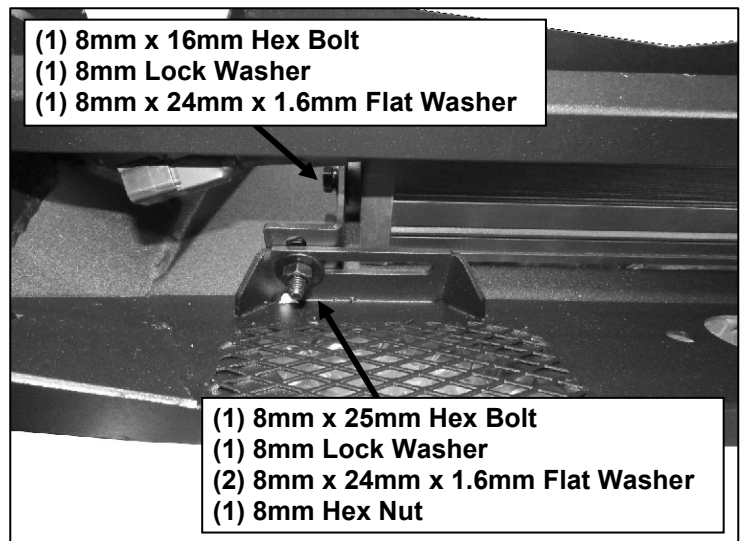

(Fig 30) If using LED Light Bar, use indicated hardware and brackets

3

Follow (Fig 32 – 42) to install Center Bumper Guard. **Only loosely install hardware at this time.**

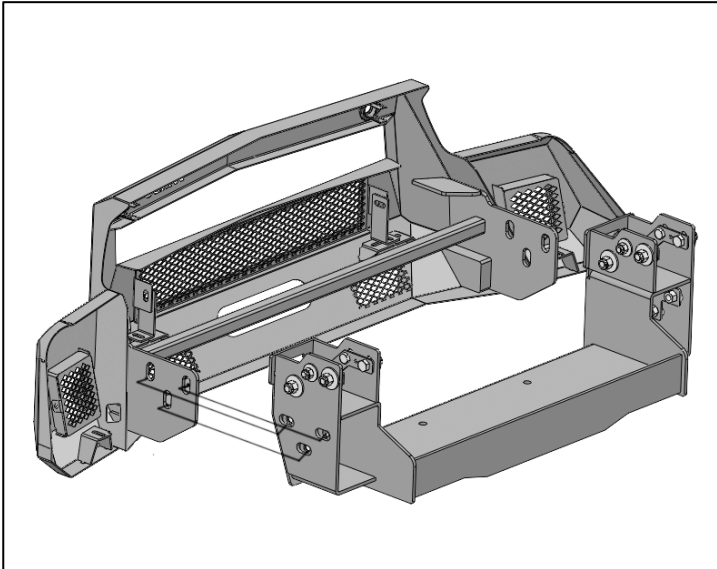

(Fig 32) With assistance, carefully line up the Center Bumper Guard bracket slots to the Winch Tray bottom mounting slots.

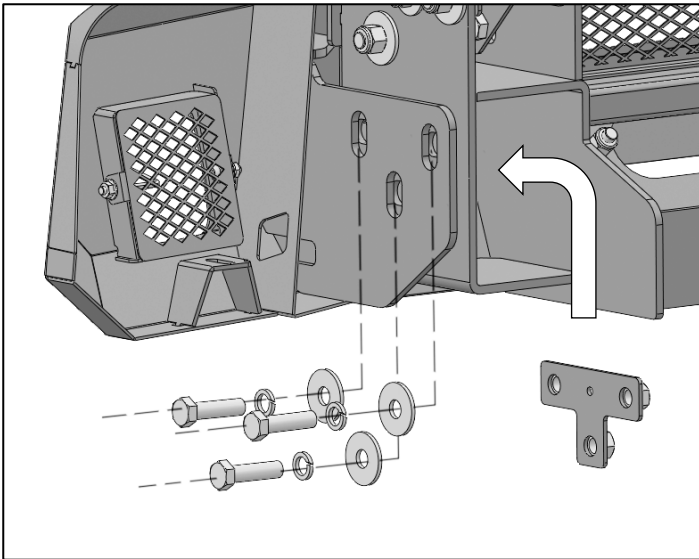

(Fig 34) Use triple bolt plate on inner side of Winch Tray to secure Center Bumper Guard

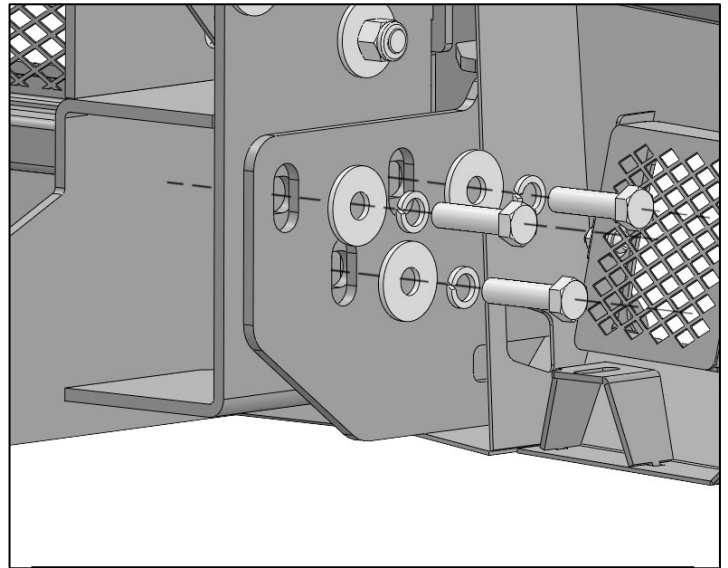

(Fig 33) From underneath, mount the Center Bumper Guard using indicated hardware from outer side, and triple bolt plate on inner side.

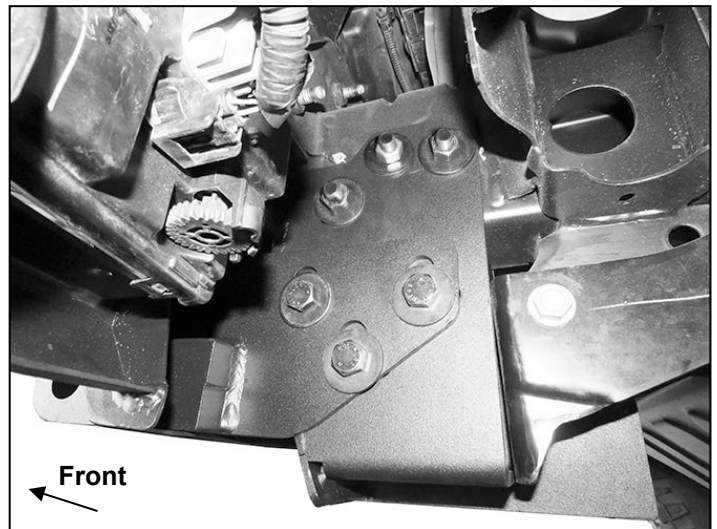

(Fig 35) Driver/left side of CS1 Bumper attached to Frame Bracket (Note OEM light installation). If any adjustment is necessary, slightly loosen hardware, and adjust bumper to desired position before fully tightening.

4

Check and adjust Center Bumper Guard fitment if necessary. Plug in any loose wire harnesses and **fully tighten all hardware at this time.**



(Fig 36) Installation Complete