



Ford 2015-25 F-150 Crew Bluetooth Step

Thank you for choosing Rough Country for all your vehicle needs.

Please read instructions before beginning installation. Check the kit hardware against the kit contents shown below. Be sure you have all needed parts and know where they go.

If question exist, please call us @1-800-222-7023. We will be happy to answer any questions concerning this product.

Check all fasteners for proper torque. Check to ensure for adequate clearance between all components.

Periodically check all hardware for tightness.

Kit Contents:

Step Mounts x6
Step Boards x2
Module x1
Wiring Harness x1
Projectors x4

Tools Needed:

10mm Wrench or Socket
13mm Wrench or Socket

Hardware Included:

8mm Lock Nut x18
8mm Flat Washer x18
6mm Flange Nut x12
6mm X 20mm T-Bolt x12

See separate sheet for Bluetooth App Instructions



Torque Specs:

Size	Grade 5	Grade 8	Size	Class 8.8	Class 10.9
5/16"	15 ft/lbs	20ft/lbs	6MM	5ft/lbs	9ft/lbs
3/8"	30 ft/lbs	35ft/lbs	8MM	18ft/lbs	23ft/lbs
7/16"	45 ft/lbs	60ft/lbs	10MM	32ft/lbs	45ft/lbs
1/2"	65 ft/lbs	90ft/lbs	12MM	55ft/lbs	75ft/lbs
9/16"	95 ft/lbs	130ft/lbs	14MM	85ft/lbs	120ft/lbs
5/8"	135ft/lbs	175ft/lbs	16MM	130ft/lbs	165ft/lbs
3/4"	185ft/lbs	280ft/lbs	18MM	170ft/lbs	240ft/lbs



INSTALLATION INSTRUCTIONS

1. Locate the step brackets and wiring harness. **See Photo 1.**
2. Install the module on to the drivers side step board using (4) of the supplied T-bolts and (4) nuts. Hand tighten. **See Photo 2.**

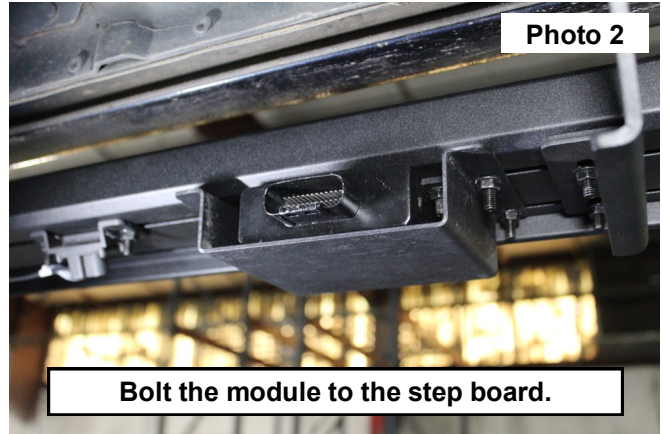
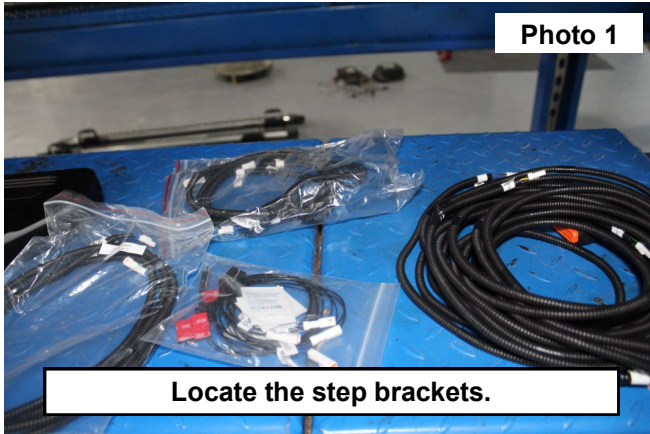

3. Install the first and second step brackets using (3) of the supplied lock nuts and flat washers. Hand tighten loosely. **See Photo 3.**
4. Install the rear step bracket using (3) of the supplied lock nuts and flat washers. Hand tighten loosely. **See Photo 4.**

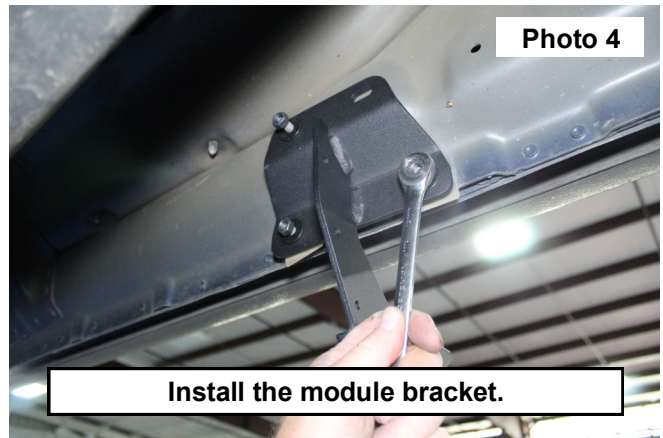

5. Install the T-Bolts into the step. (7) bolts will be installed into the track on the body side of the step. (3) bolts will be installed on the outer side of the step. **See Photo 5.**
6. Place the (2) projectors onto (2) of the bolts and secure using (2) of the flange nuts. The projectors will need to be in-between the front and rear step mounts and pointed in the outward position. **See Photo 6.**

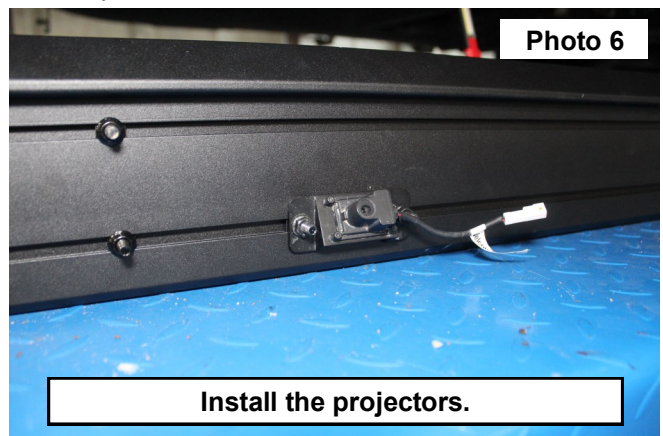
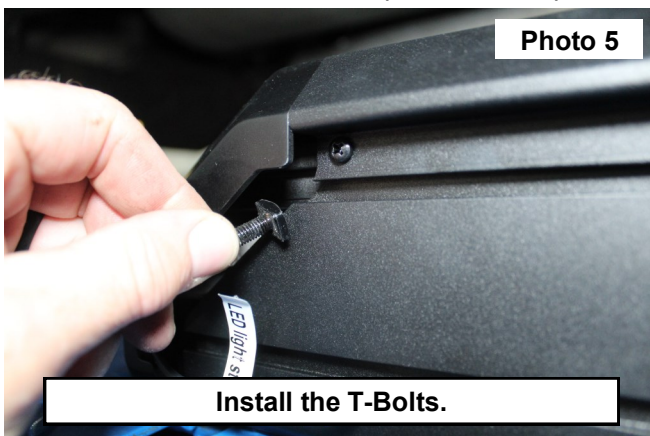

7. Place the step onto the mounting brackets. Placing the hardware into the slotted holes. Secure the step using the supplied flange nuts on each of the mounting brackets. **See Photo 7.**
8. Center the step to the body of the vehicle and tighten all step hardware. **See Photo 8.**
9. Install the opposite side step mounting brackets to the body and the step.

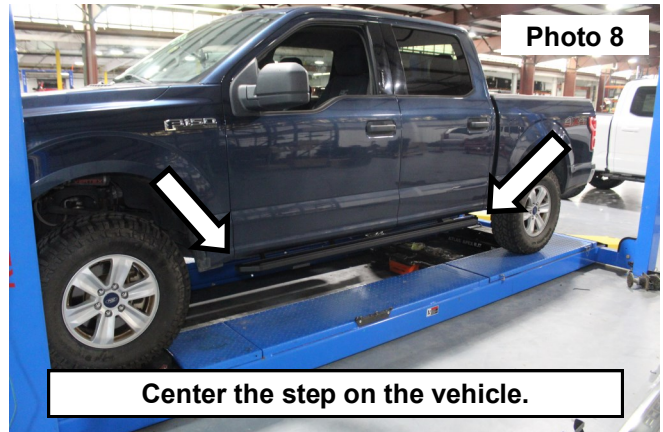
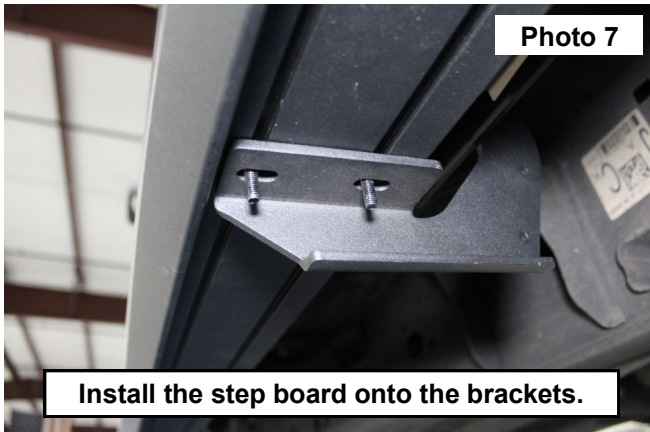

10. Connect the light wiring harness to the module. Connect the power wires to the battery. **See Photo 9.**
11. Plug the harness to the (4) projector lights on each side of the vehicle. **See Photo 10.**



12. Route the harness to the (top step plate light) located at the front of the step connector. **See Photo 11.**
13. Pass the harness through the crossmember to the passengers side of the vehicle. **See Photo 12.**

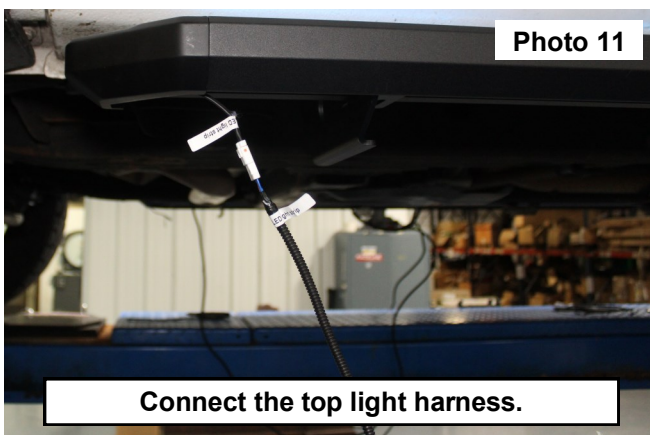

14. Remove the front scuff plate from the interior of the vehicle. **See Photo 13.** Repeat on passengers side.
15. Lift the carpet to expose the floor of the cab. Trim a X into the plug for an access hole for the light wiring harness plugs. **See Photo 14.** Repeat on passengers side.



16. Place the harness through the hole in the plug. **See Photo 15.** Repeat on passengers side.
17. Select a location by the latch on the front door and place the sensor. Use the double sided tape on the back of the sensor to apply to the cab of the vehicle. **See Photo 16.** Repeat on passengers side.

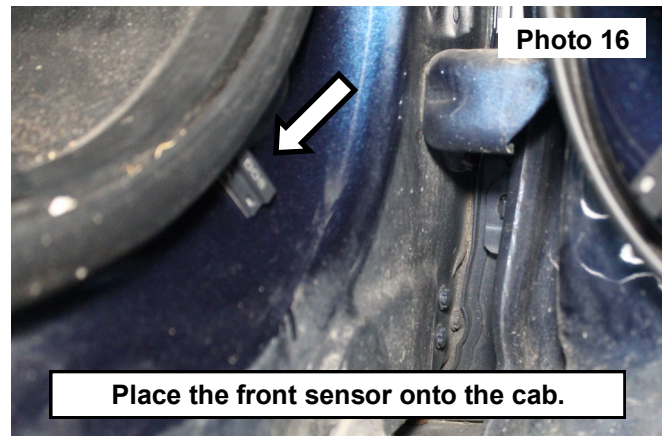

18. Align the door magnet with the sensor applied by the latch. **Notes:** The magnet can be taped onto the door to set the correct placement before the double sided tape is applied. Place the magnet onto the door using the double sided tape on the back of the magnet. **See Photo 17.** Repeat on passengers side.
19. Select a location for the rear door sensor under the door check stop limiter and place the sensor to the cab of the vehicle. Use the double sided tape on the back of the sensor to apply to the cab of the vehicle. **See Photo 18.** Repeat on passengers side.

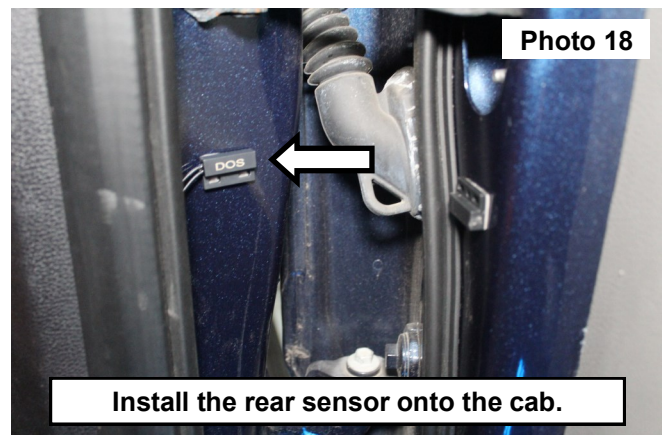
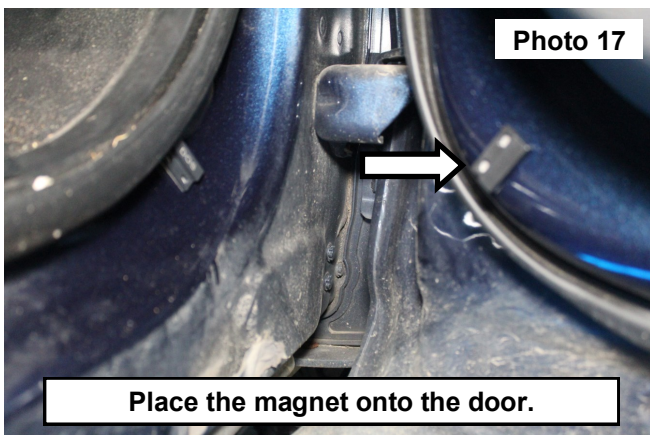

20. Align the door magnet with the rear sensor. **Notes:** The magnet can be taped onto the door to set the correct placement before the double sided tape is applied. Place the magnet onto the door using the double sided tape on the back of the magnet. **See Photo 19.** Repeat on passengers side.
21. Replace the interior scuff plate. **See Photo 20.** Repeat on passengers side.

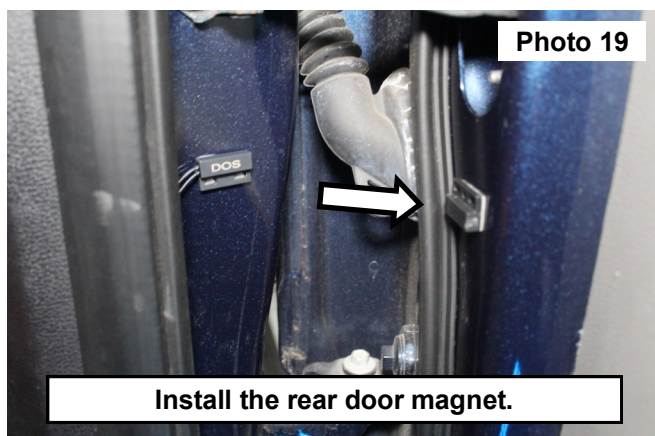

By purchasing any item sold by Rough Country, LLC, the buyer expressly warrants that he/she is in compliance with all applicable, State, and Local laws and regulations regarding the purchase, ownership, and use of the item. It shall be the buyers responsibility to comply with all Federal, State and Local laws governing the sales of any items listed, illustrated or sold. The buyer expressly agrees to indemnify and hold harmless Rough Country, LLC for all claims resulting directly or indirectly from the purchase, ownership, or use of the items.



