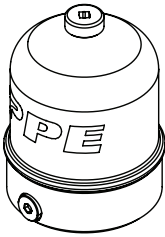
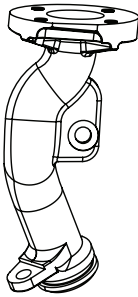
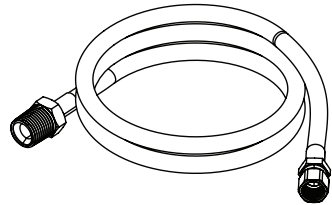
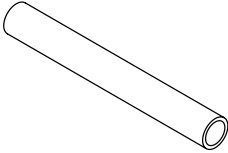
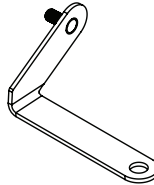

Oil Centrifuge Filtration Kit

2001-2010 GM Duramax 6.6L

(114010200)

Installation Guide

A**B****C****D****E****F****G****H****I****J****K****L**

CONTENTS

- A. (1) Oil Centrifuge Assembly
- B. (1) Oil Filler Tube Pedestal
- C. (1) Oil Feed Line
- D. (1) Heat Sleeve
- E. (1) 90 Deg Fitting
- F. (1) Straight Fitting w/ O-Ring
- G. (1) O-Ring, Centrifuge to Pedestal
- H. (1) O-Ring, Pedestal to Engine
- I. (4) M8-1.25X20mmL Flange Bolt
- J. (4) M8 Compound Washer
- K. (1) *Fan Shroud Bracket
- L. (1) *M8-1.25 Flange Nut

*applies to 2006-2010 model years

INSTALLATION

1. *Applies to 2001-2005 model years. Remove the PCM cover. Remove the PCM from the fan shroud then rotate it out of the way (**Fig. 1 & 2**)

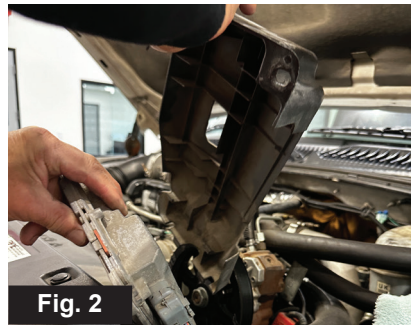
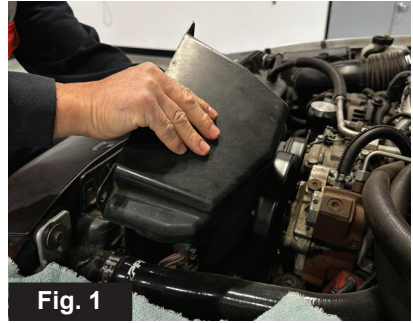

2. Remove the upper fan shroud. (**Fig. 3 & 4**)



3. Loosen the radiator fan nut then remove the fan. (Fig. 5 & 6)

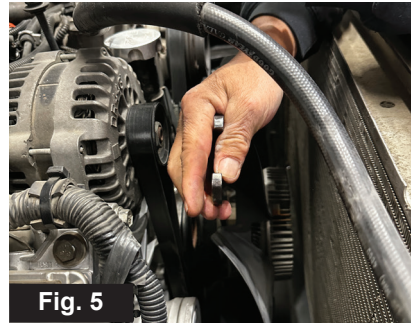

4. Remove the two bolts securing the factory oil filler tube, then remove it. (Fig. 7 & 8)

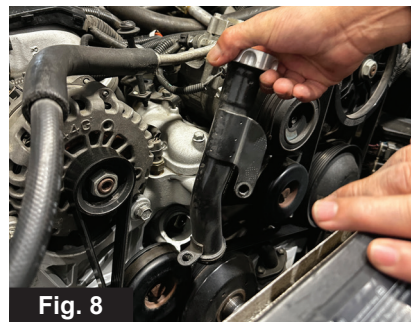
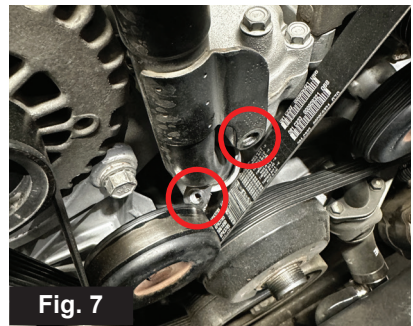

5. Install the O-Ring (G) into the groove at the bottom of the Oil Centrifuge Assembly (A). (Fig. 9)



Fig. 9

6. Install the O-Ring (H) into the groove at the bottom of the Oil Filler Tube Pedestal (B). (Fig. 10)



Fig. 10

7. Loosen the nut on top of the Oil Centrifuge Assembly (A) then turn to separate the centrifuge cover from the base. (Fig. 11) Note: There is a retaining clip on the inside of the centrifuge cover. Be careful not to forcefully remove the nut.



Fig. 11

8. Install the Flange Bolt (I) & Compound Washer (J) to secure the centrifuge assembly base to the Oil Filler Tube Pedestal (B). Be careful not to overtighten to prevent damage to the threads. (Fig. 12)



Fig. 12

9. Install the Straight Fitting w/ O-Ring (F) into the centrifuge assembly base. (Fig. 13)



Fig. 13

10. Install the oil filler pedestal base onto the engine. (Fig. 14)



Fig. 14

11. Loosen the belt tensioner and move the serpentine belt out of the way. Remove the pulley to gain clearance to fit a tool to tighten the bolt. (Fig. 15 & 16)



Fig. 15

12. Reinstall the serpentine belt and pulley. Remove the front driver's side wheel fender liner.



Fig. 16

13. From under the vehicle, remove the engine oil filter and set it aside. **(Fig. 17)**



14. On the side of the engine oil cooler, locate and remove the NPT plug. **(Fig. 18)**



15. Apply teflon onto the male NPT threads on the 90 Deg Fitting (E). **(Fig. 19)**



16. Install the 90 Deg Fitting (E) onto the engine oil cooler. See **(Fig. 20)** for the correct orientation.



17. If equipped, remove the intake tube resonator. Route the Oil Feed Line (C) to the oil centrifuge assembly. Leave the hose connector loose. (Fig. 21 & 22)



18. Through the front driver side wheel well, install the Heat Sleeve (D) over the Oil Feed Line (C). (Fig. 23)



19. Finish routing the oil feed line to the engine oil cooler. Tighten the hose on the 90 Deg fitting (E). (Fig. 24) Slide the heat sleeve onto the fitting and secure the sleeve with a zip tie. (Fig. 25)



Fig. 24



Fig. 25

20. Tighten the oil feed line (C) onto the oil centrifuge assembly. (Fig. 26)



Fig. 26

21. Install the centrifuge rotor assembly. **(Fig. 27)**



22. Reinstall the centrifuge cover. Tighten the nut and torque to 40 in-lb. **(Fig. 28)** Do not overtighten.



23. *Applies to 2006-2010 model years. Install the Fan Shroud Bracket **(K)** and M8 Flange Nut **(L)**. **(Fig. 29)**



Installation Complete

MAINTENANCE SERVICE/ASSEMBLY GUIDE

1. Loosen the nut (**Fig. 1**) and carefully remove the oil centrifuge cover. (**Fig. 2**) Do not forcefully separate the nut from the centrifuge cover.



2. Remove the centrifuge rotor assembly. (**Fig. 3**)



3. Remove the rotor nut. (**Fig. 4**)



4. Lightly tap on the shaft to separate the rotor components (Fig. 5)

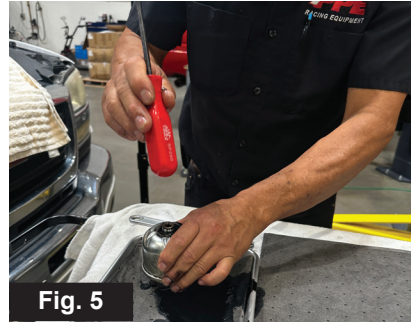

5. Clean the inner rotor wall of the centrifuge housing of all debris and contaminants. (Fig. 6 & 7)

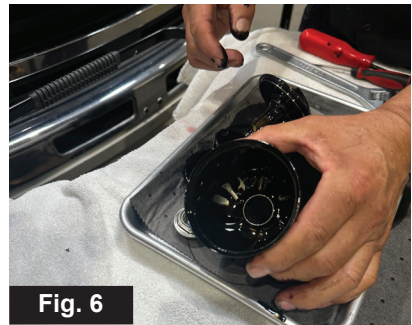

6. Clean the rest of the components before reassembly. (Fig. 8)



7. Reinstall the oil centrifuge in this order.
 - a. O-Ring (**Fig. 9**)
 - b. Plastic Drain Back (**Fig. 10**)
 - c. Centrifuge Rotor Housing (**Fig. 11**)
 - d. Centrifuge Rotor Nut (**Fig. 12**)



8. Place the rotor assembly back onto the base and install the centrifuge cover. Tighten to 40 in-lb. (Fig. 13 & 14)



Maintenance Completed

DISCLAIMER OF LIABILITY

Performance products can increase horsepower above and beyond factory specifications. Additional horsepower creates more stress on the drive-train components, which could result in drive-train failure.

Note regarding emissions-related, non-E.O.-legal products: THESE PRODUCTS ARE LEGAL IN CALIFORNIA ONLY FOR RACING VEHICLES THAT MAY NEVER BE USED, OR REGISTERED OR LICENSED FOR HIGHWAY OR OFF-ROAD USE.

This agreement sets forth the terms and conditions for the use of PPE products. The installation of this product indicates that the Buyer has read and understands this agreement and accepts the terms and conditions. PPE (Pacific Performance Engineering) Inc., its distributors, employees, and dealers (the "Seller") shall not be responsible for the product's proper use and service. The buyer hereby waives all liability claims. The Buyer hereby acknowledges no reliance on the Seller's skill or judgment to select or furnish goods suitable for any particular purpose and that there are no liabilities which extend beyond the description on the face hereof, and the Buyer hereby waives all remedies or liabilities expressed or implied, arising by law or otherwise (including without any obligation of the Seller with respect to fitness, merchantability and consequential damages), or whether or not occasioned by the Seller's negligence. The Seller disclaims any warranty and expressly disclaims any liability for personal injury or damages. The Buyer acknowledges and agrees that the disclaimer of any liability for personal injury is a material term for this agreement and the Buyer agrees to indemnify the Seller and to hold the Seller harmless from any claim related to the item of equipment purchased. Under no circumstances will the Seller be liable for any damages or expenses by reason of use or sale of any such equipment. The Seller assumes no liability regarding the improper installation or misapplication of its products. It is the installer's responsibility to check for proper installation and if in doubt, contact the manufacturer. The Buyer is solely responsible for all warranty issues from the manufacturer.

LIMITATION OF WARRANTY

The Seller gives Limited Warranty as to description, quality, merchantability, and fitness for a particular purpose, productiveness, or any other matter of Seller's product sold herewith. The Seller shall not be responsible for the products proper use and service and the Buyer hereby waives all rights other than those expressly written herein. This warranty shall not be extended, altered or varied except by a written instrument signed by Seller and Buyer. The Warranty on PPE Manifolds and Up-Pipes Kits, OEM-Length Up-Pipes is three (3) years, a limited lifetime warranty on PPE cast aluminum pans and covers, and a limited lifetime warranty on PPE Transmission Coolers and one (1) year limited warranty on all other PPE products from the date of sale to original buyer and limited solely to the parts contained within the products kit. All products that are in question of Warranty must be returned prepaid to the Seller and must be accompanied by a dated proof of purchase receipt. All Warranty claims are subject to approval by Seller. Under no circumstances will the Seller be liable for any labor charged or travel time incurred in diagnosis for defects, removal, or re-installation - of this product or any other contingent expenses. Under no circumstances will the Seller be liable for any damage or expenses incurred by reason of the use or sale of any such equipment. In the event that the buyer does not agree with this agreement: the buyer may promptly return this product, in a new and unused condition in its original packaging, with a dated proof of purchase to the place of purchase within ten (10) days from date of purchase for a full refund. The installation of this product indicates that the buyer has read and understands this agreement and accepts its terms and conditions.

⚠ CA WARNING: Handling passenger or off-highway motor vehicle parts can expose you to chemicals such as phalates and lead, which can cause cancer and reproductive harm. To minimize exposure, service the vehicle in a well-ventilated area, wear gloves, and wash your hands. For more information see www.P65Warnings.ca.gov/motor-vehicle-parts.

