



AMERICAN MODIFIED

SKU # AMFMFA00121 & AMFMFA00122

ARMOR GRILLE

Product Installation Instructions

Fitment : 2017-2019 F250 / 350 / 450

STEP 1



Pop the hood,remove 14 push tabs on the top with a pry tool,then grab this plastic piece and set it aside.

STEP 2



Remove 8 bolts on the top of the grille with a 10 millimeter socket and a ratchet,then you can remove the grille.If you have a front camera,unplug the connector on the camera by pressing the release tab and sliding the connector off.Then disconnect the washer fluid hose fitting by prying up on one side of the locking collar then slide the hose fitting off to pull the grille off of the truck.

STEP 3



Remove metal clips with a little screwdriver (if the new grille comes with new metal clips)

STEP 4

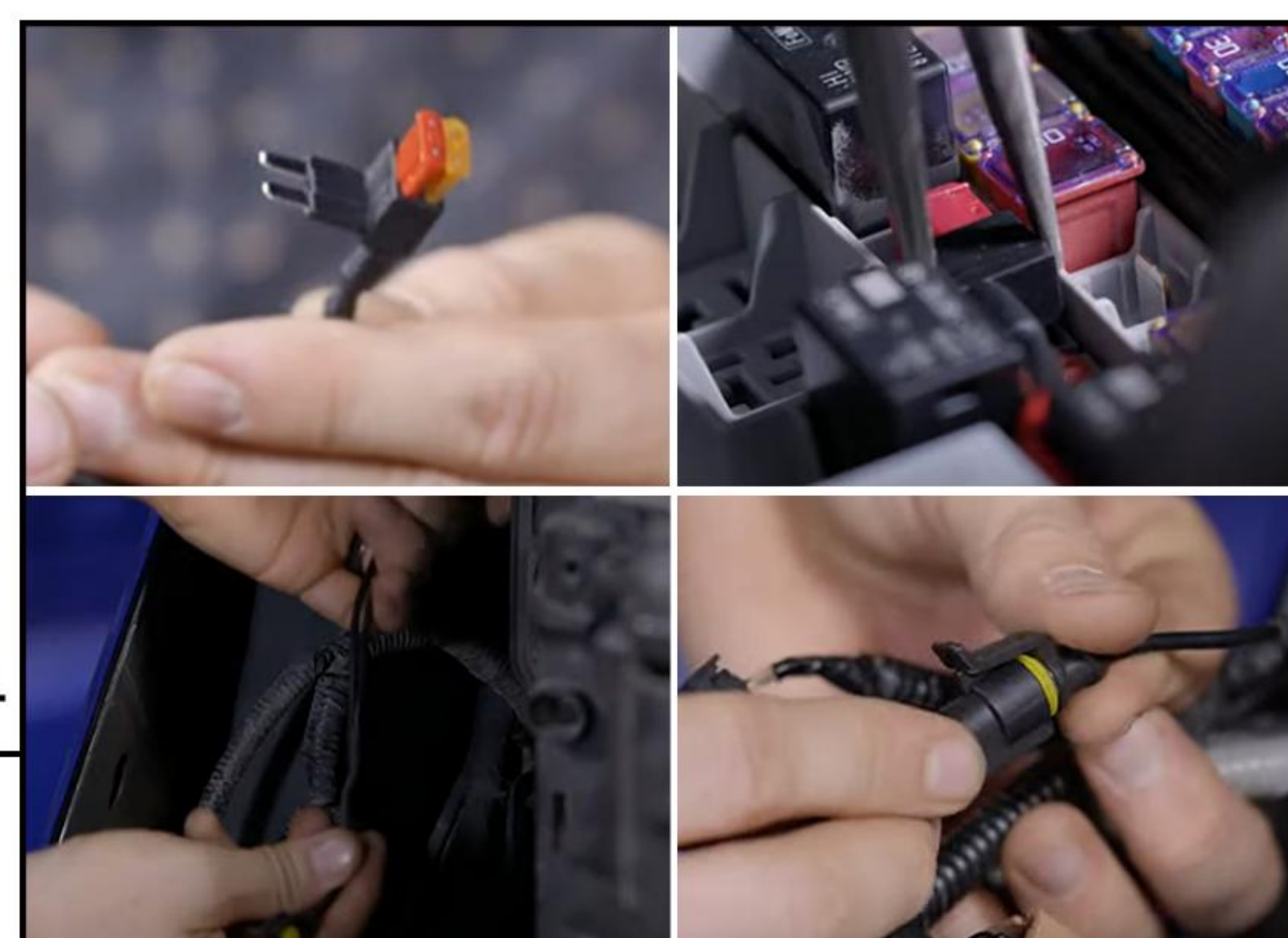

Remove the passenger's side headlight and disconnect it; Get this harness mounted into the fuse box to replace the fuse tap that's in the location 35,the other end of the harness is going to get ran down here by the battery and into the passenger headlight.If you have an oem led truck, you can use the one with the multi-pin connector to connect to the big connector.Wire DRL connection to the passenger side and reinstall the headlight.

STEP 5

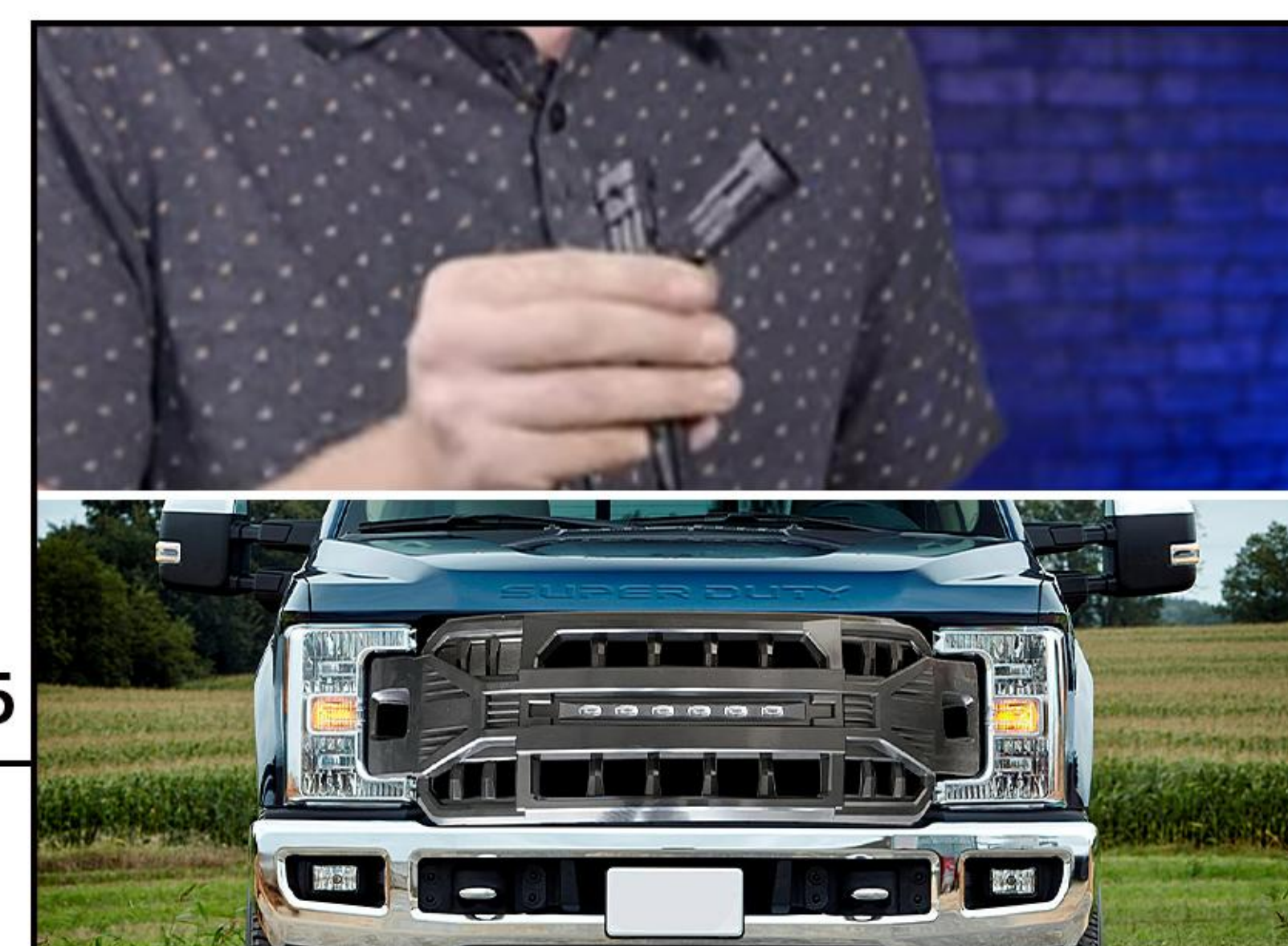

Connect the two plugs to your grille and push the grille back on(reinstall the camera wiring,connect the washer fluid hose), retighten 8 bolts on the top of the grille.Grab the cover,place it back on top of the grille and install 14 push tabs to complete the installation of the grille.