



# AMERICAN MODIFIED

SKU # AMFMFA00119 & AMFMFA00120

# ARMOR GRILLE

## Product Installation Instructions

Fitment : 2020-2022 F250 / 350 / 450

### STEP 1



Pop the hood,remove 14 plastic clips holding on the grille cover so that we can remove this cover.

### STEP 2



Remove the 6 10mm bolts on the top of the grille; On each side at the top of the grille on the back there's a stud that goes through with a 10mm nut that we need to remove;

### STEP 3



Remove this section which exposes this 10 mm bolt, then remove it.Go ahead and repeat on the opposite side.

### STEP 4



There are two tabs on each side of the grille that you have to pop out with a long screwdriver. If your grille have a front camera,you need to remove the washer line and disconnect the camera.Finally,you can pull the grille off of the car.

### STEP 5

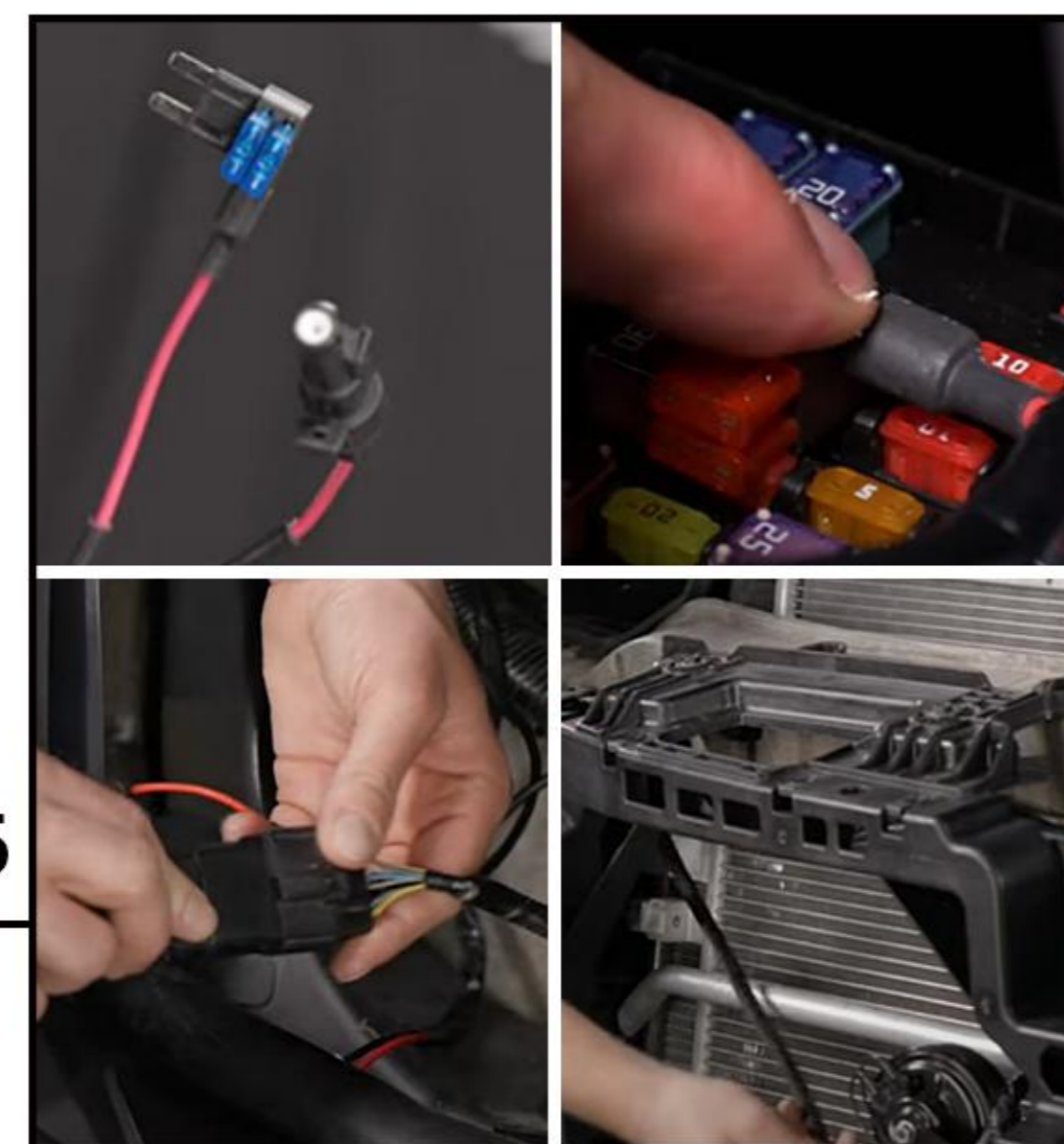

Remove the passenger's side headlight and disconnect it;Use this harness route it up to the fuse box and connect it to fuse16;(if you have XGB headlight,grab the DRL harness and swap out that 10 amp fuse with a 15 amp fuse as it comes supplied in the kit;if you are still using the stock headlights you can retain the 10 amp). Pop off the cover of the fuse box.Use the grille wiring harness and connect all the proper connections

### STEP 6



Get the necessary connectors connected back to the headlights and install the headlight;Connect the grille to the wiring harness coming off the headlight, then install the camera wiring,connect the washer fluid hose.Finally,push the grille in's easier to line up the top studs and snap it in,tighten the 10 mm nuts on the stud and 6 10mm bolts on the top of the grille.

### STEP 7



Grab the cover,place it back on top of the grille and install 14 push tabs to complete the installation of the grille.