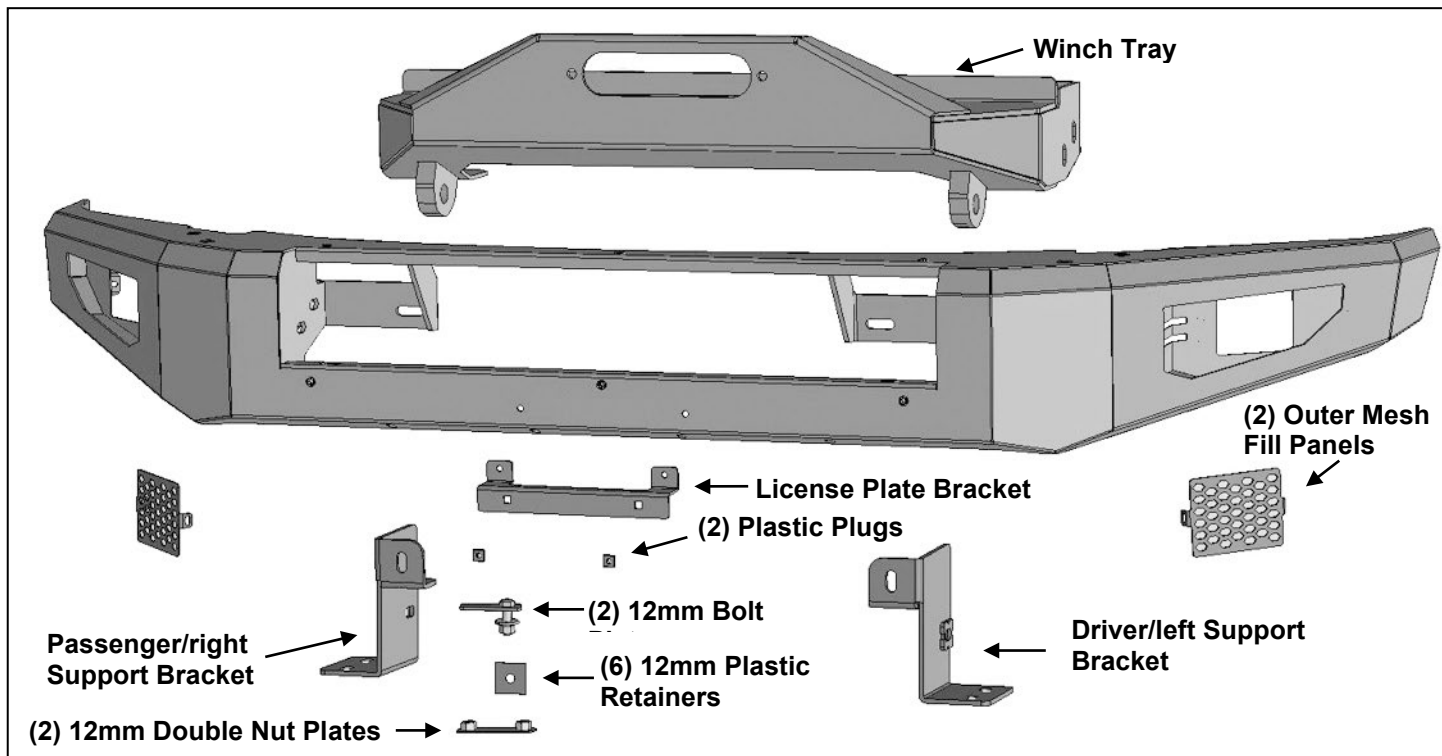

PARTS LIST:

1	HD3 HD Front Bumper	2	12mm Double Nut Plates
1	Winch Tray	6	12mm-1.75mm x 50mm Hex Bolts
1	Driver/left Support Bracket	8	12mm-1.75mm x 35mm Hex Bolts
1	Passenger/right Support Bracket	26	12mm x 32mm x 3mm Flat Washers
2	Outer Mesh Fill Panels	16	12mm Lock Washers
1	License Plate Bracket	12	12mm Hex Nuts
2	Plastic Plugs for license plate mount	12	6-1.0mm x 20mm Combo Bolts
6	12mm Plastic Retainers	6	6mm Flange Nuts
2	12mm-1.75mm x 40mm Bolt Plates	1	4mm Wrench

**PROCEDURE:**

REMOVE CONTENTS FROM BOX. VERIFY ALL PARTS ARE PRESENT. READ INSTRUCTIONS CAREFULLY BEFORE STARTING INSTALLATION. BUMPER IS HEAVY, ASSISTANCE IS HIGHLY RECOMMENDED TO AVOID POSSIBLE INJURY OR DAMAGE TO THE VEHICLE.

1. Remove the license plate and bracket, **(Figure 1)**. Remove the plastic bumper pad assembly, **(Figure 2)**. **NOTE:** Carefully pull bumper pad straight out away from bumper. Unplug and remove the adaptive cruise control, if equipped, **(Figure 3)**.
2. Unplug the fog lights, if equipped, **(Figure 4)**. Release the wiring harness from the clips attached to the back of the bumper. Move all wiring harnesses away from bumper.
3. Place blocks or jack stands under the front bumper to support it during mounting bolt removal. Once the bumper has been safely supported, remove the large hex nut, (1 per side), from the back of the bumper bracket attaching the lower bumper to the bumper bracket, **(Figure 5)**. Next, from the front of the bumper, remove the (2) factory hex nuts per side attaching the bumper to the bumper brackets, **(Figures 6 & 7)**. **WARNING!** Assistance is required to hold the bumper in place during bolt removal to prevent the bumper from falling. Carefully slide the bumper off over the tow hooks. **OPTIONAL-** On models with bolt on frame extensions, remove the extensions from outside of frame, **(Figure 8)**. **NOTE:** On some models the factory bolts may need to be cut to remove frame extensions.
4. Remove the double bolt plates from the bumper brackets on the end of the frame, **(Figure 7)**. **NOTE:** Use a flat blade screwdriver to pry off and remove the locks attaching the bolt plates to the frame.
5. Models with tow hooks, temporarily remove both tow hooks.

6. Select the driver/left Support Bracket, **(Figure 9)**. Insert (1) 12mm x 50mm Hex Bolt with (1) 12mm Flat Washer into the upper tab on the Support Bracket. Thread (1) 12mm Plastic Retainer onto the Hex Bolt to help hold the Hex Bolt in position, **(Figure 9)**.
7. Attach the Support Bracket to the inside wall of the frame with the included (1) 12mm Single Bolt Plate, (1) 12mm Flat Washer, (1) 12mm Lock Washer and (1) 12mm Hex Nut, **(Figure 10)**. **NOTE:** Insert the Bolt Plate into the end of the frame and out the inner wall on the frame. Do not fully tighten hardware.
8. Next, attach the Support Bracket to the holes in the bottom of the frame with the included (1) 12mm Double Nut Plate, (2) 12mm x 50mm Hex Bolts, (2) 12mm Lock Washers and (2) 12mm Flat Washers, **(Figure 11)**. Do not tighten hardware at this time. **NOTE:** Models with tow hooks, reinstall the tow hook over the Support Bracket with Bracket between the tow hook and the bottom of the frame.
9. Repeat **Steps 6—8** to attach the passenger/right Support Bracket.
10. Carefully unwrap the Bumper assembly. Plug the threaded holes around the opening for the winch tray with the included (6) 6mm Button Head Combo Bolts, **(Figure 12)**.
11. With assistance, position the Bumper Assembly up to the frame and over the (2) Hex Bolts in the Support Brackets, **(Figure 13)**. Temporarily support the weight of the Bumper. **WARNING:** To avoid possible injury or damage to the vehicle, do not proceed until the bumper is fully and safely supported.
12. From the front, attach the Bumper to the (2) 12mm Hex Bolts in the Support Brackets with the included (2) 12mm Flat Washers, (2) 12mm Lock Washers and (2) 12mm Hex Nuts, **(Figure 14)**. Leave loose.
13. Move to the driver/left side of the Bumper. Attach the Bumper to the end of the frame with the included (2) 12mm x 35mm Hex Bolts, (4) 12mm Flat Washers, (2) 12mm Lock Washers and (2) 12mm Hex Nuts, **(Figures 15 & 16)**. Do not fully tighten hardware at this time. Repeat this **Step** to attach the passenger/right side of the Bumper to the frame.
14. Level and adjust the Bumper to the vehicle and fully tighten all hardware.
15. From the front of the Bumper, temporarily remove the (2) 12mm Flat Washers, (2) 12mm Lock Washers and (2) 12mm Hex Nuts attaching the Bumper to the frame and Support Brackets, **(Figure 14)**.
16. Select the Winch Tray. Slide the Winch Tray into position in the opening in the Bumper. From the front, attach the Winch Tray to the (2) 12mm Hex Bolts with the (2) 12mm Flat Washers, (2) 12mm Lock Washers and (2) 12mm Hex Nuts from **Step 15**, **(Figure 17)**.
17. Attach the Tray to the inside of the Bumper with (4) 12mm x 35mm Hex Bolts, (8) 12mm Flat Washers, (4) 12mm Lock Washers and (4) 12mm Hex Nuts, **(Figures 18 & 19)**. Fully tighten hardware.
18. Determine if accessory lights, (not included), or Screen Fill Panels will be installed at this time.
Outer Screen Fill Panel Installation (do not install fill panels if installing lights).
 - a. Attach (1) Screen Fill Panel to the tabs on the back of the driver/left side of the Bumper with the included (2) 6mm Button Head Combo Bolts and (2) 6mm Flange Nuts, **(Figure 20)**. Fully tighten Fill Panel hardware at this time. Repeat this **Step** to install the remaining Fill Panel on the passenger/right side of the Bumper.
- Outer LED cube style light installation, (lights not included).**
 - a. Attach lights to the mounting tabs at the outer ends of the Bumper, **(Figure 20)**.
 - b. Follow the light manufacturer's instruction to properly wire lights once Bumper is installed.
19. Attach the License Plate Bracket to Bumper with the included (2) 6mm x 20mm Button Head Screws, (4) 6mm Flat Washers and (2) 6mm Nylon Lock Nuts, **(Figure 21)**. Insert (2) Plastic Plugs into the square holes in the Bracket. Reuse the factory screws to attach the license plate.
20. Do periodic inspections to the installation to make sure that all hardware is secure and tight.

To protect your investment, Do not use any type of polish or wax that may contain abrasives that could damage the finish. Mild soap may be used to clean the Bumper assembly.

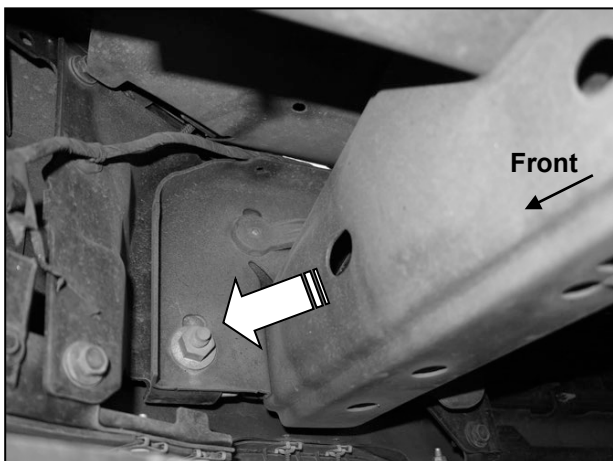
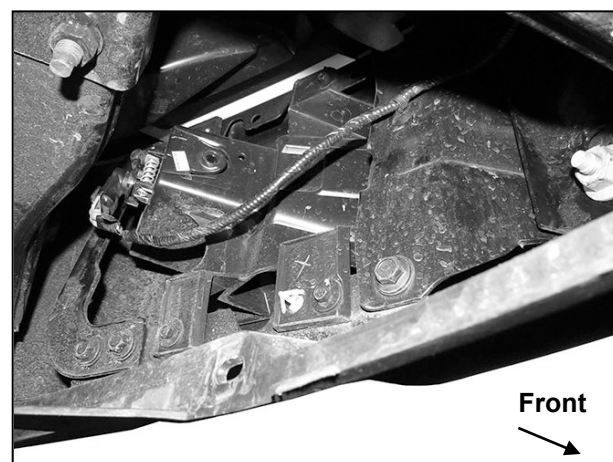
Driver/left Side Installation Pictured**(Fig 1) Remove license plate from Bumper****(Fig 3) Unplug and remove adaptive cruise control sensor from driver/left side of frame, if equipped****(Fig 5) Remove factory hex nut (arrow) from back of bumper bracket (driver/left side pictured)****(Fig 2) Remove the plastic bumper pad from the front of the Bumper****(Fig 4) Unplug and move factory wiring harness for fog lights (if equipped)****Driver/left Side Installation Pictured**

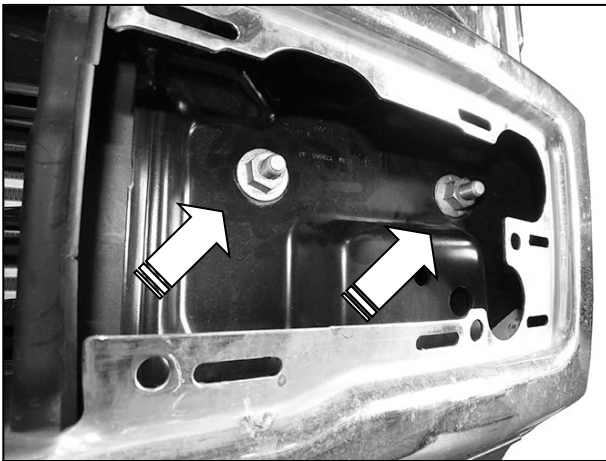

(Fig 6) Remove the (2) factory hex nuts from each side (driver/left side pictured)



(Fig 8) Optional, remove the factory frame extensions, if equipped

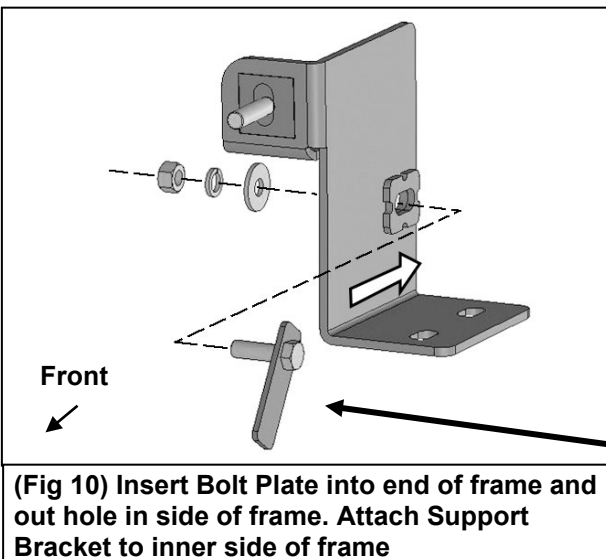

(Fig 10) Insert Bolt Plate into end of frame and out hole in side of frame. Attach Support Bracket to inner side of frame

WARNING! Do not remove bumper bolts unless the bumper is properly supported on blocks or stands or it may fall.

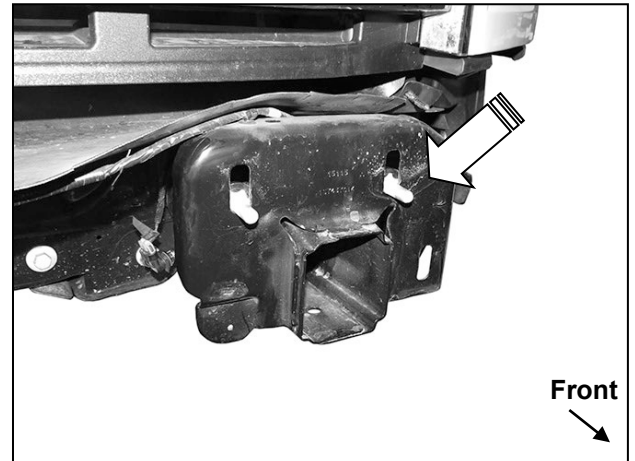

(Fig 7) Remove factory bumper. Use a flat blade screwdriver to pry off lock washers and remove the bolt plates from the frame (arrow)

12mm x 50mm Hex Bolt
12mm Flat Washer

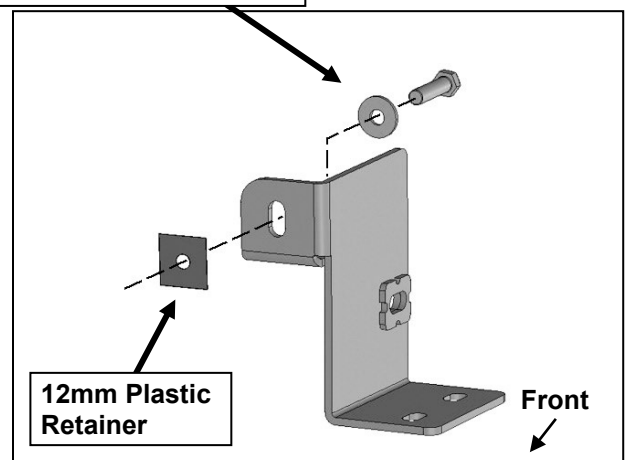

(Fig 9) Insert Hex Bolt with Flat Washer through driver/left Support Bracket. Secure Bolt to Bracket with 12mm Plastic Retainer

12mm Bolt Plate
12mm Flat Washer
12mm Lock Washer
12mm Hex Nut

Driver/left Side Installation Pictured

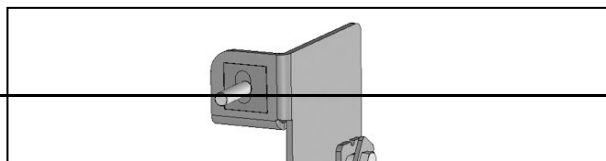

12mm Double Nut Plate
(2) 12mm x 50mm Hex Bolts
(2) 12mm Lock Washers
(2) 12mm Flat Washers

Front

(Fig 11) Attach Support Bracket to bottom of frame, between tow hook and frame (if equipped). Models without tow hooks, insert 12mm Double Nut Plates into end of frame

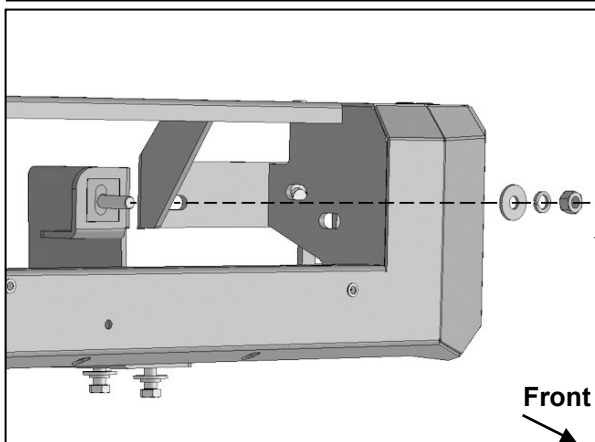

(Fig 14) Temporarily attach Bumper to Hex Bolt in frame and Support Bracket



(Fig 16) Driver/left side of Bumper installed

(6) 6mm Combo Bolts

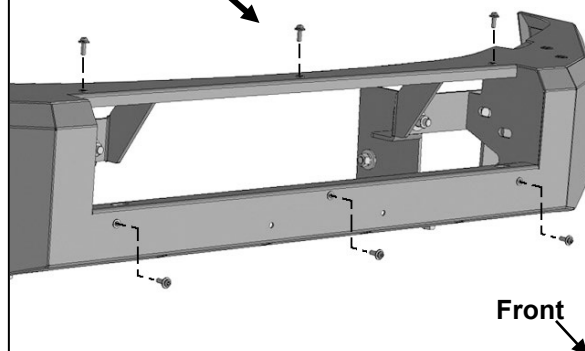

(Fig 12) Plug unused threaded holes in Bumper

12mm Flat Washer
12mm Lock Washer
12mm Hex Nut

(2) 12mm x 35mm Hex Bolts
(4) 12mm Flat Washers
(2) 12mm Lock Washers
(2) 12mm Hex Nuts

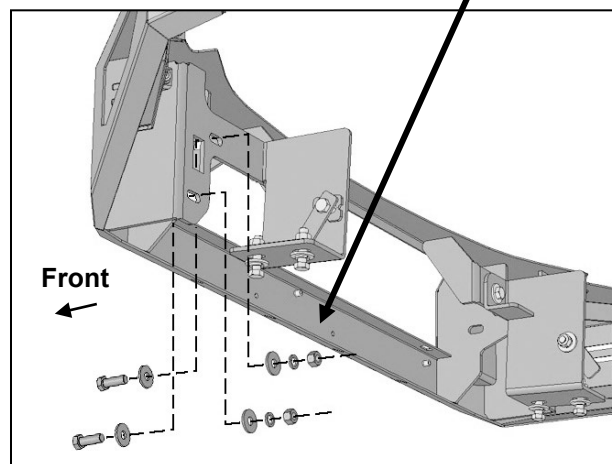

(Fig 15) Attach Bumper to end of frame

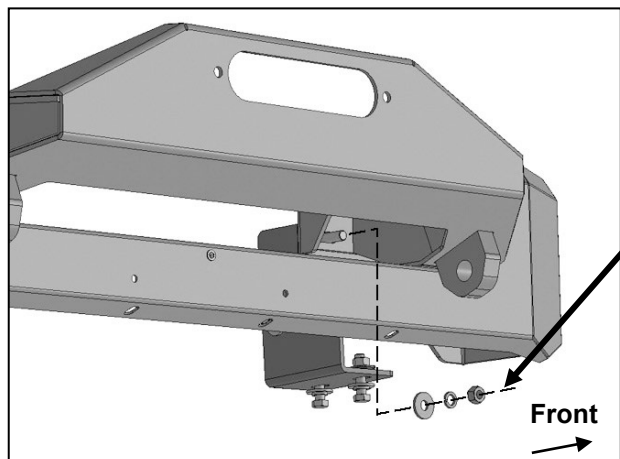
Driver/left Side Installation Pictured

(Fig 17) Attach Winch Tray to Hex Bolts in frame and Support Brackets

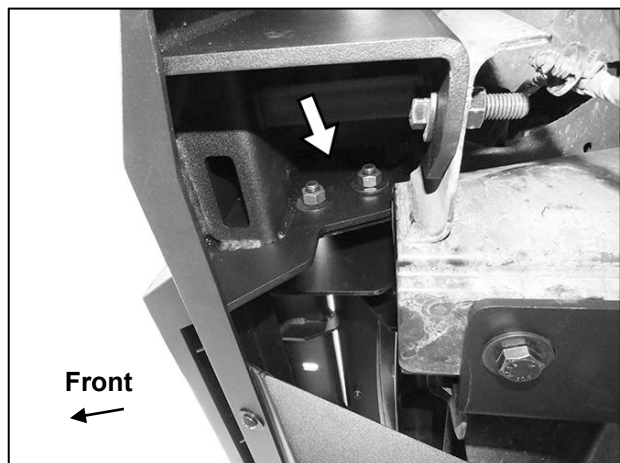

(Fig 19) Driver/left side of Winch Tray and Bumper pictured from below

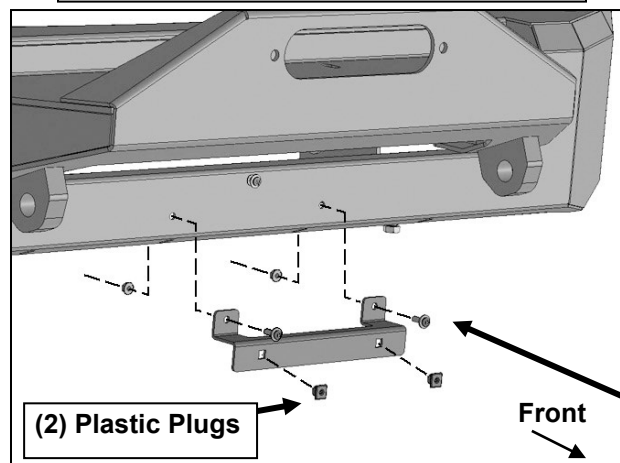

(Fig 21) Attach License Plate Bracket to front of Bumper

12mm Flat Washer
12mm Lock Washer
12mm Hex Nut

(2) 12mm x 35mm Hex Bolts
(4) 12mm Flat Washers
(2) 12mm Lock Washers
(2) 12mm Hex Nuts

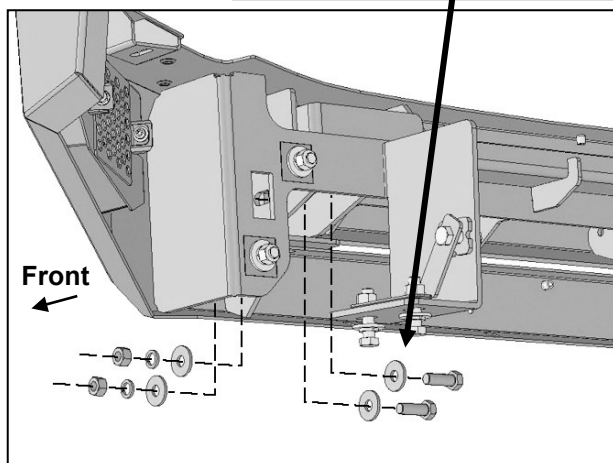

(Fig 18) Attach driver/left side of Winch Tray to mount inside of Bumper

(2) 6mm Combo Bolts
(2) 6mm Flange Nuts

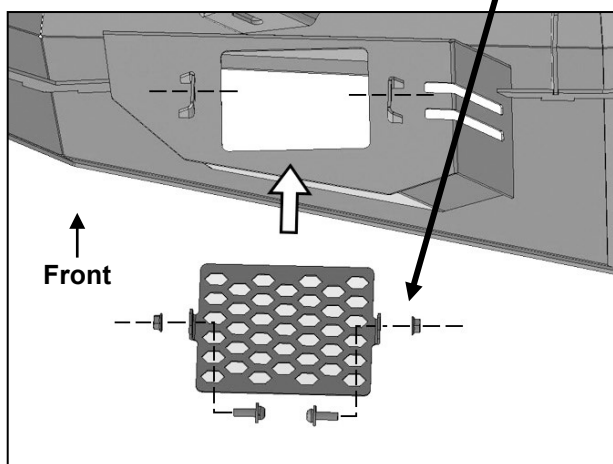

(Fig 20) Attach the Outer Mesh Panels to the tabs on the back of the Bumper

(2) 6mm Combo Bolts
(2) 6mm Flange Nuts