

TRUKID

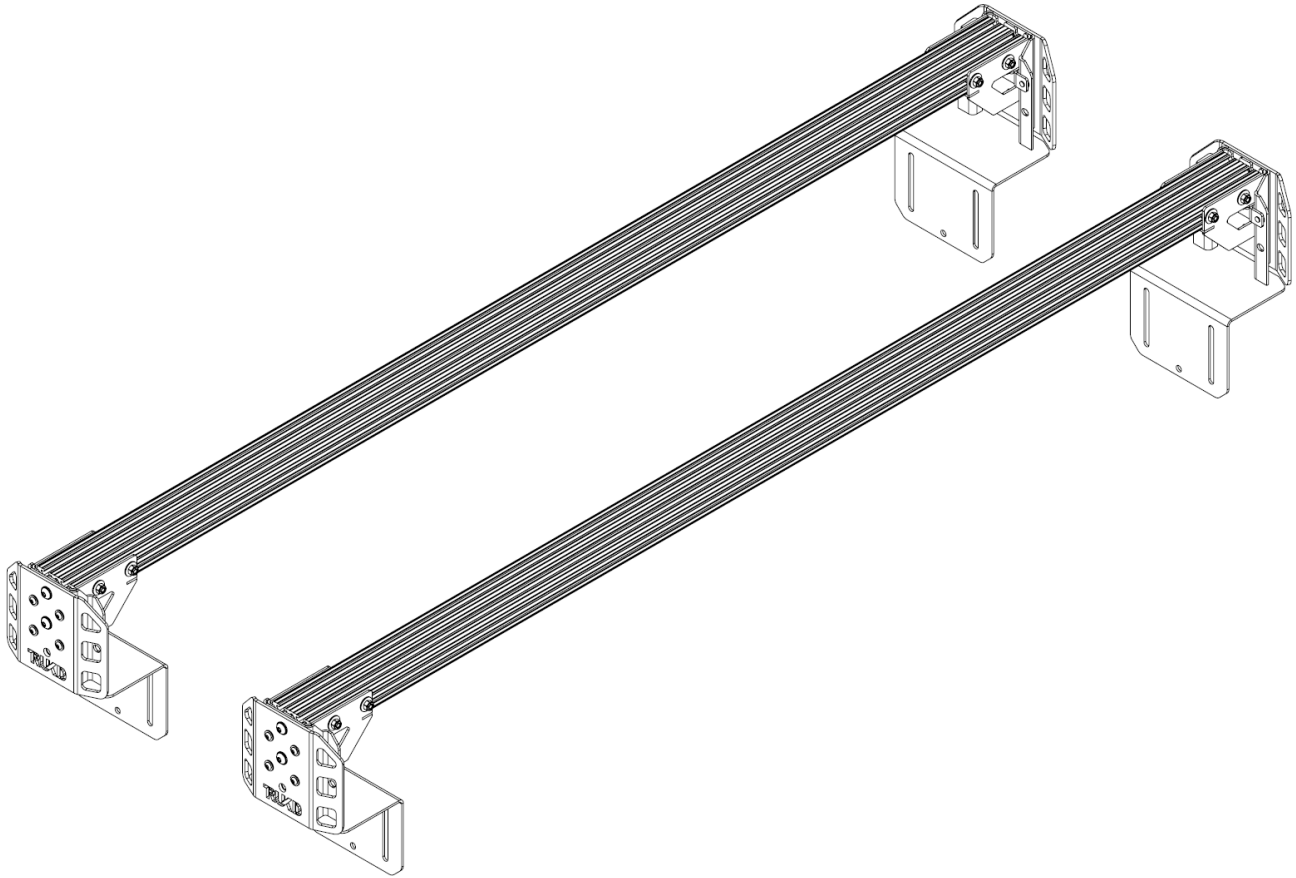

INSTALLATION GUIDE FOR 6.5" BED RACKS



Scan the QR Code for the online installation guide video!

PRODUCT CONTENTS

Make sure your received everything in the correct quantities for installation:

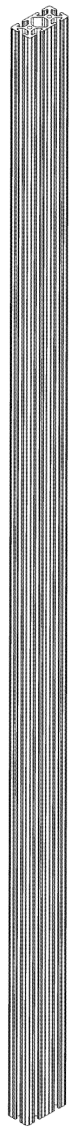

2x Cross Bars

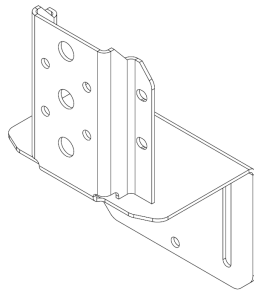

4x Upright Brackets

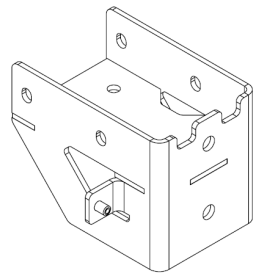

4x Bar Brackets

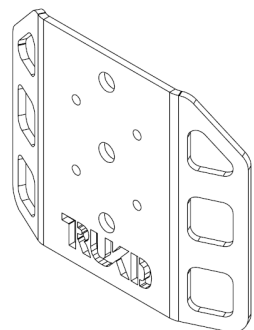

4x Faceplates



12x 5/16" Lock Nuts

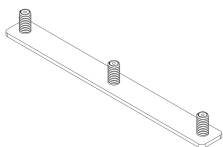

4x T-slot Plate
(truck models
with T-slot rails)

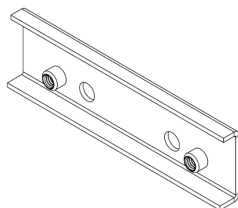

4x Bed Clamps
(truck models without
bed side utility rails)

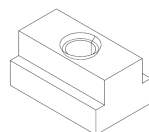

8x Utility Rail T-nuts
(truck models with
bed side utility rails)

Bag 1 - Bolts

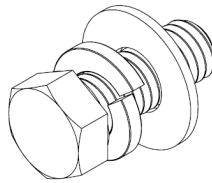

**8x 3/8-16 Bolts with
washers and lock washers**

Bag 2A - Screws and Washers



16x 1/4-20 x 3/8" Screws and Washers

Bag 3 - Screws and Washers (Upright to Bar Bracket)

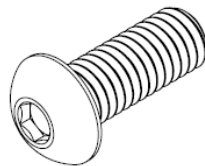

8x 3/8-16 x 1" screws



8x 3/8" Washers

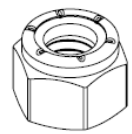

8x Locknuts



8x large shoulder washers



8x small shoulder washers

Bag 4A - T-nuts and screws (Crossbar to bar brackets)

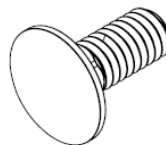

24x 5/16" Carriage Bolts

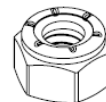

24x 5/16" Lock Nuts



24x 5/16" Washers

Tools Required (not included):

- Measuring Tape
- Hex Driver 5/32
- Hex Driver 7/32
- Socket Wrench Set

****Do not use power tools or****

****metric wrench sizes instead of SAE****

PRE INSTALL NOTES:

You will likely need to remove your Tonneau cover to attach the brackets in step 4.

After the brackets are installed and in position you will need to reinstall your Tonneau cover before attaching the crossbars.

Racks with bedside rails must be removed and depending on placement of the uprights, Others may need to be removed as well.

Step 1

Prepare Screws and Brackets

Using the screws, washers, and lock nuts from Bag 4A pre-install 6 into each bar bracket, 24 total.

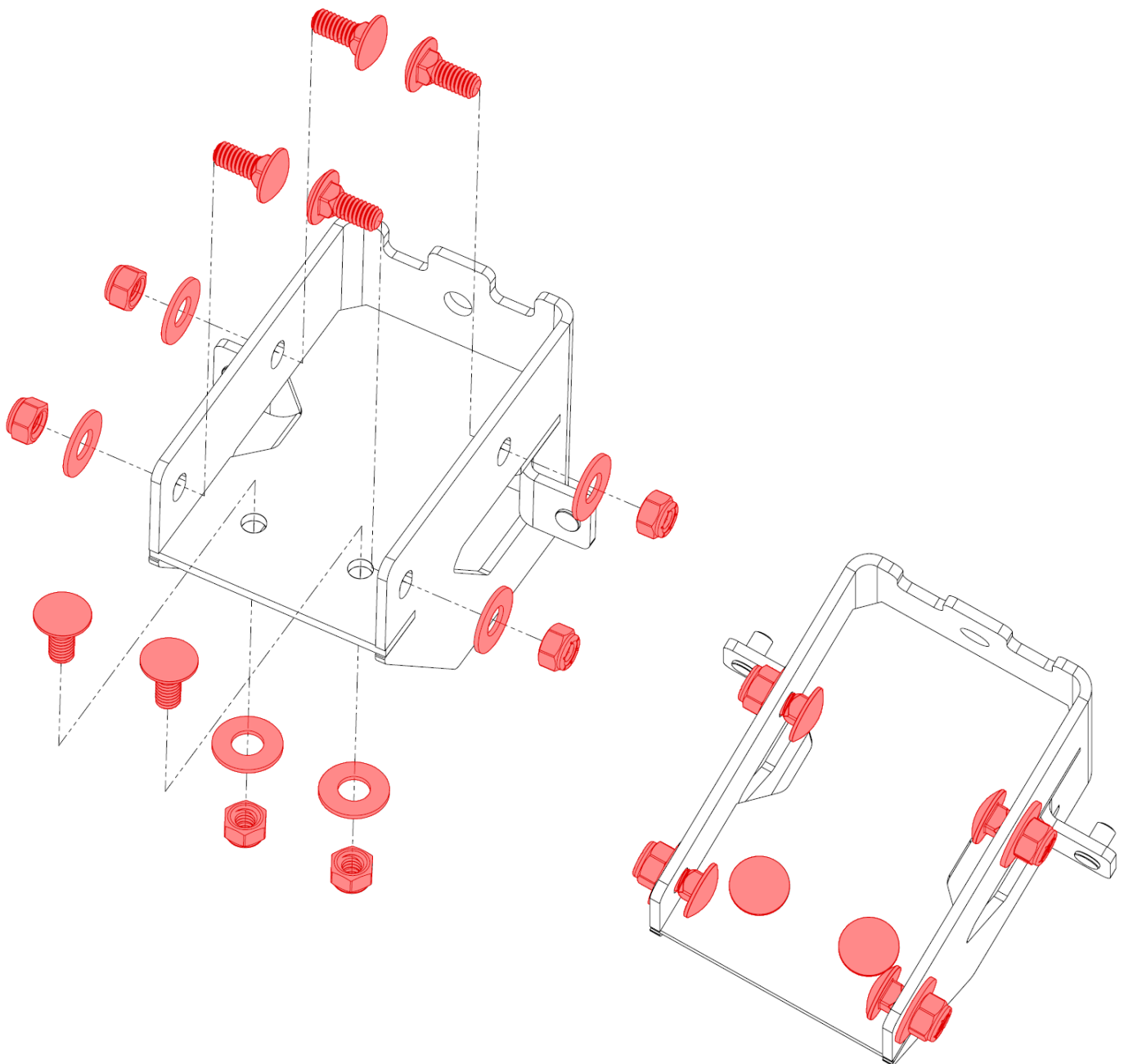

Step 2

Attach Faceplates to Upright Brackets

Use the screws and washers from Bag 2A to attach your faceplates to each corner bracket. Tighten these down now.

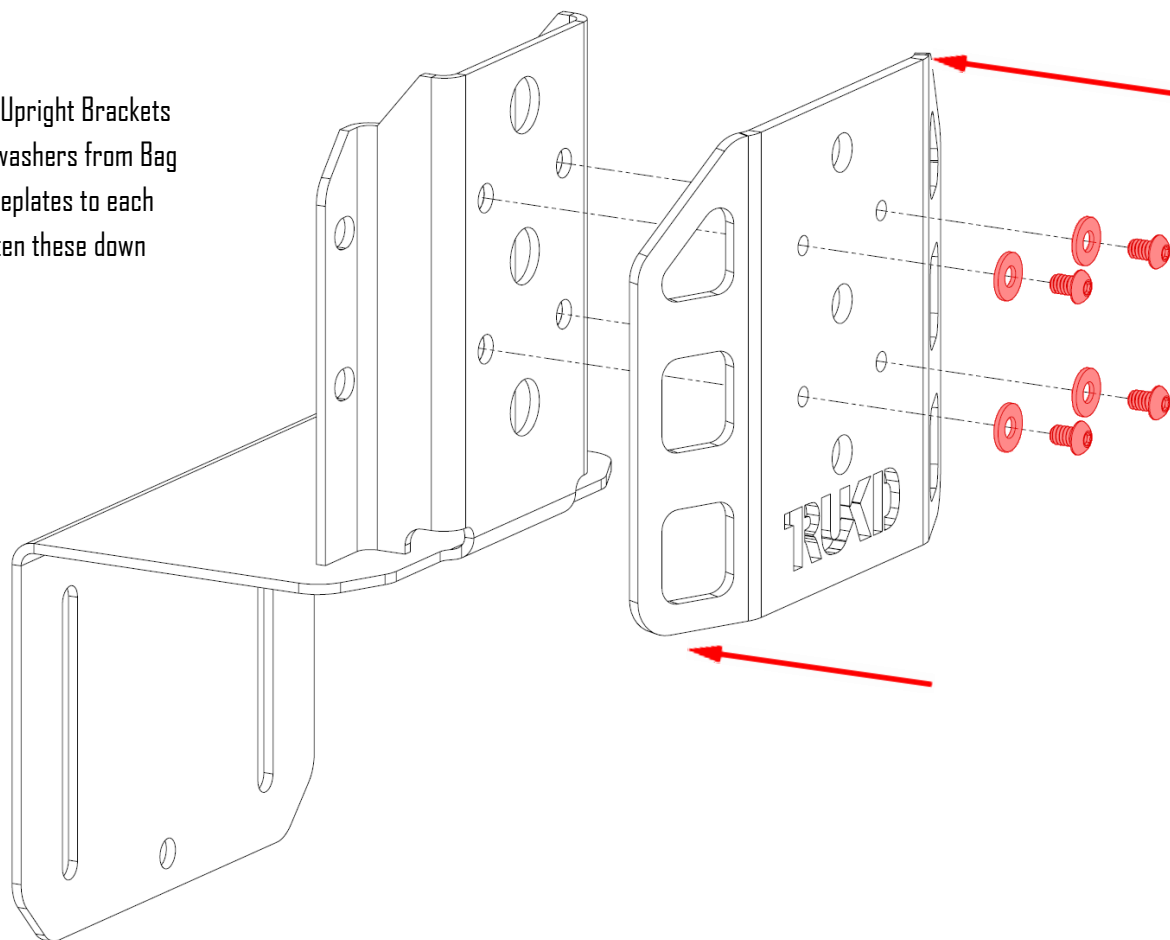

Step 3

Attach bar ends to your uprights. Use the screws, shoulder washers, washers and lock nuts from bag 3A to attach your bar end brackets to your uprights.

Make sure you put two plastic shoulder washers on the positioning pins and that you use the larger shoulder washers on the outside of the upright with the 3/8" screw.

The washer and the locknut go on the inside of the bracket.

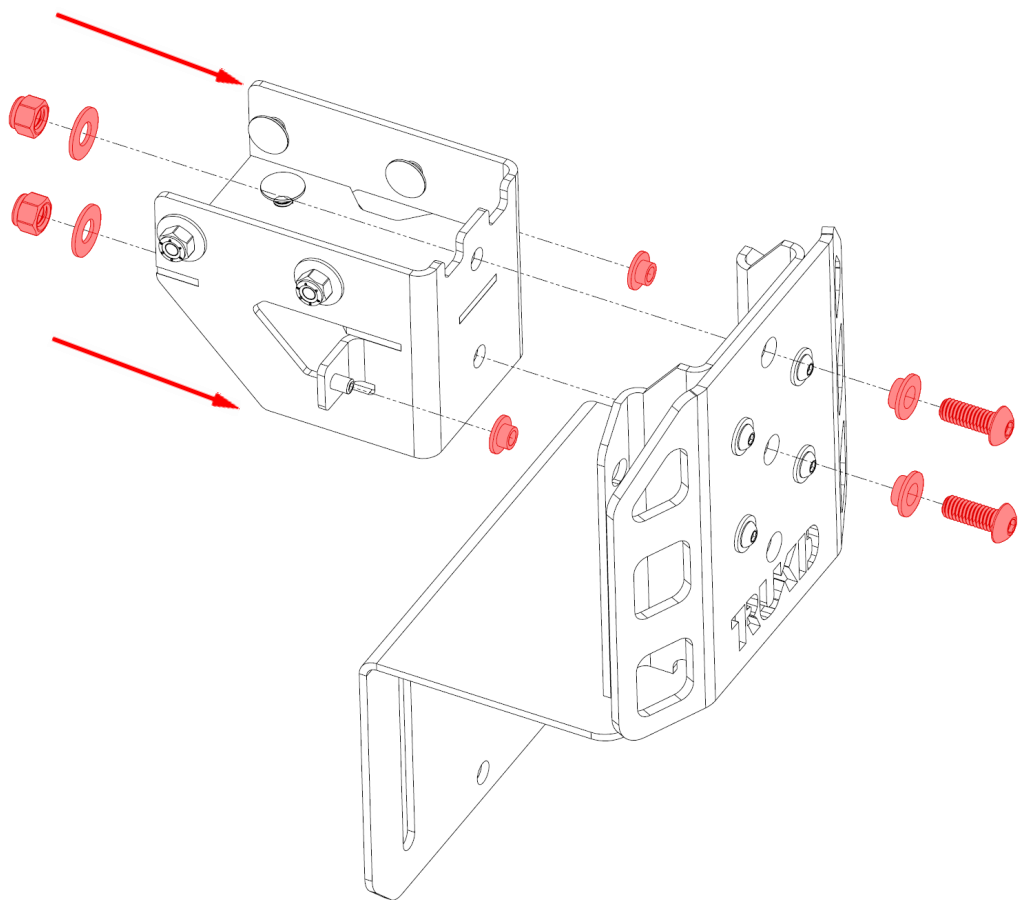

Step 4

Attach the Cross Bars. Slide one end of your crossbar into each upright/bar end bracket and loosely tighten one of the lock nuts to prevent it from sliding off.

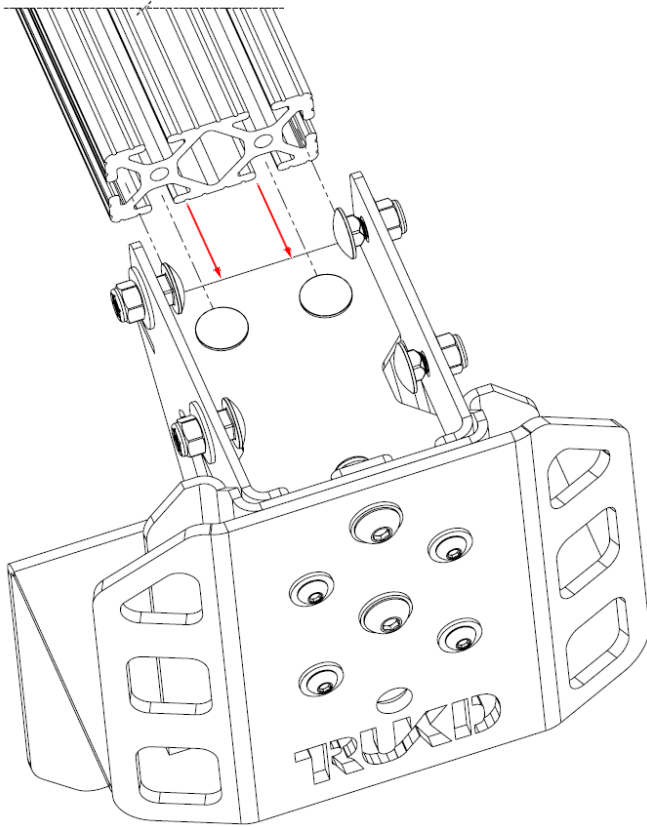

You may need to spin the carriage bolts to get the squares to line up with the crossbar T slots.

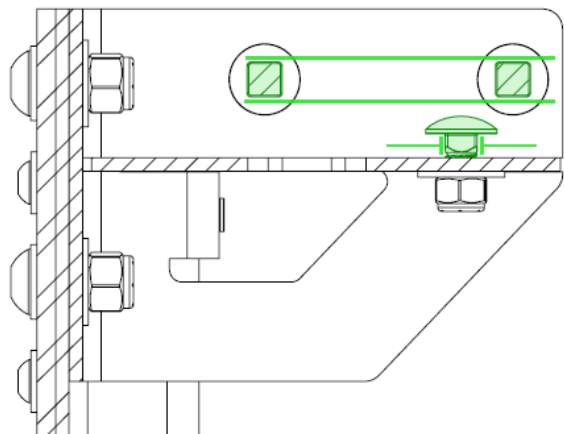
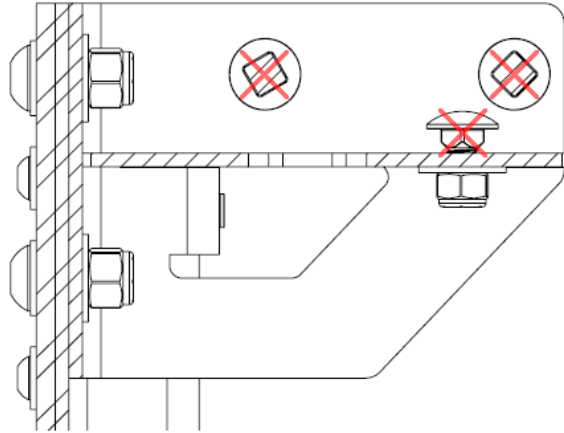

It is recommended to keep a gap between the crossbar and inside of the bracket, as shown. This will keep the nut accessible for checking and retightening as needed.

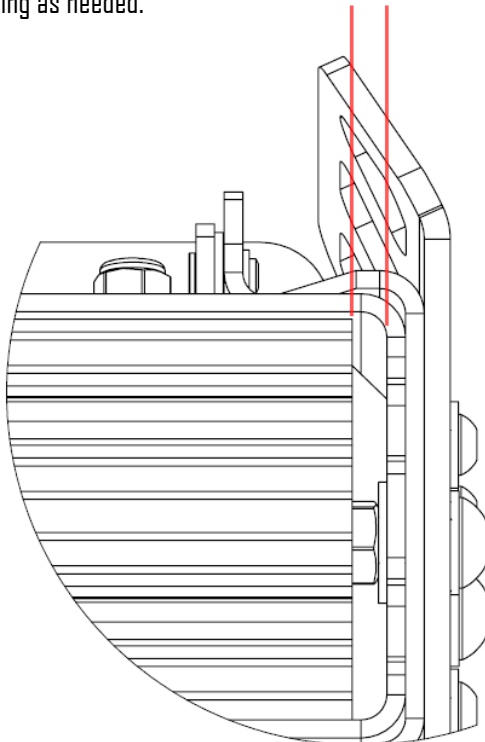

Step 5 (No Utility Rail)

Attach each bracket to your truck bed.

Using the supplied bed clamps, use the bolts and washers from Bag 1, 3/8-16 to attach the crossbars to your truck bed.

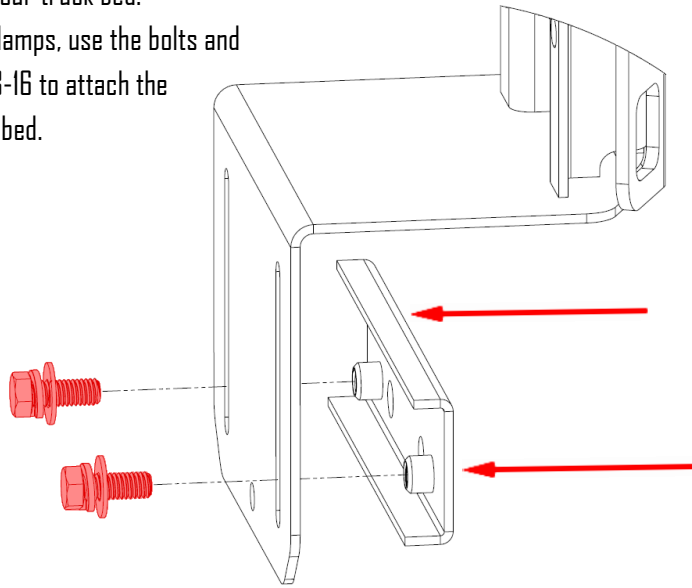

IMPORTANT: Ensure that the short side of the bracket is facing upwards, as shown.

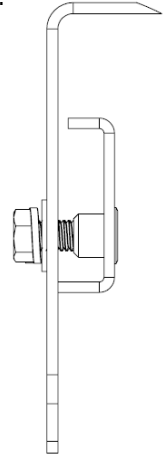

It is recommended that you have an extra pair of hands to hold the brackets while you tighten the bolts.

IMPORTANT: Attach each bracket loosely then use a measuring tape to ensure that they are placed across from each other and move as needed to align the brackets.

Once the brackets are aligned, tighten them down making sure the upright is vertical. Adjust if needed to ensure each bracket is vertical.

Once vertical, you can tighten all 6 nuts on each bar end with a ratchet and socket.

Tighten the bolts until the clamp grabs the bedside and the upright bracket cannot move front to back, and tighten an additional turn.

Do not over tighten to avoid damage to the clamp and rivet nuts. You can deform the steel by over tightening.

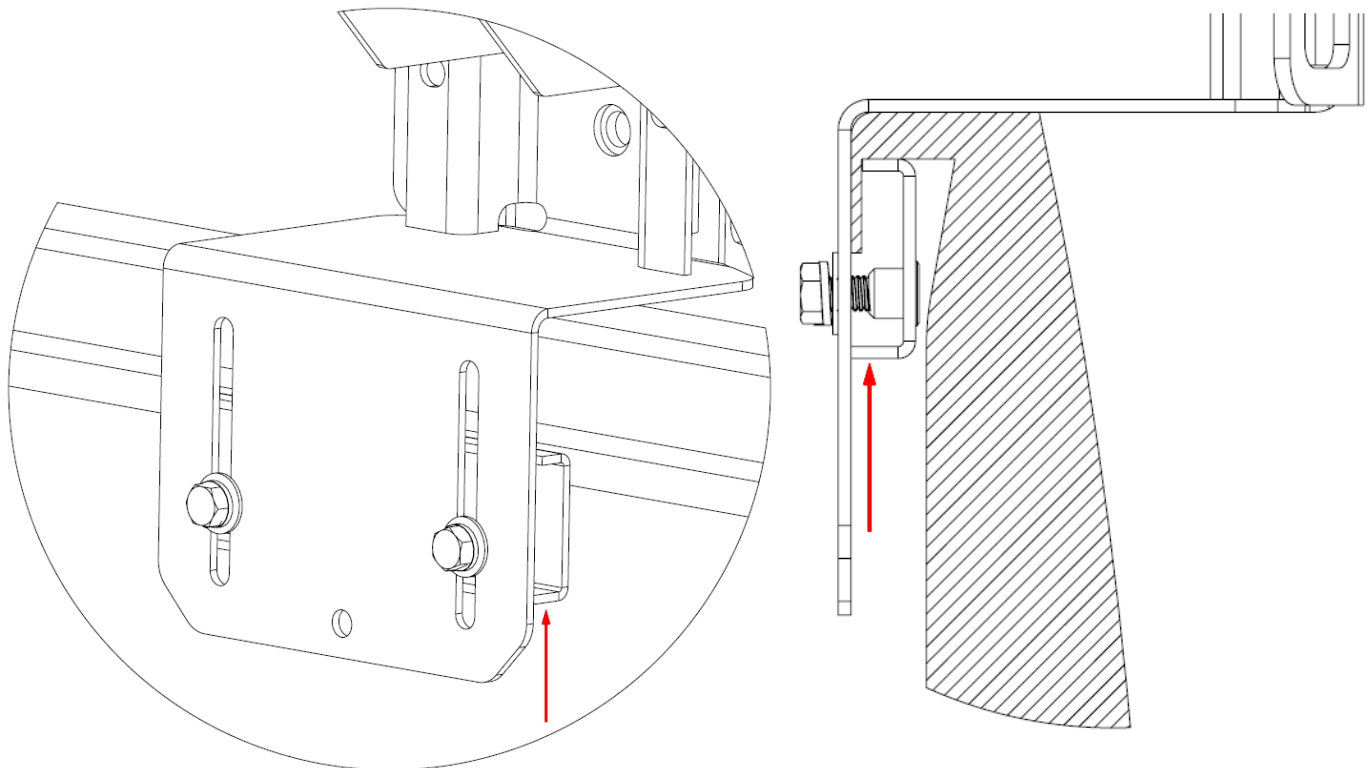

Step 5 (Utility Rail Mount)

Attach each bracket to your truck bed.

Using the supplied utility rail nuts, use the bolts and washers from Bag 1, 3/8-16 to attach the crossbars to your truck bed. First slide the rail nuts onto the utility rail.

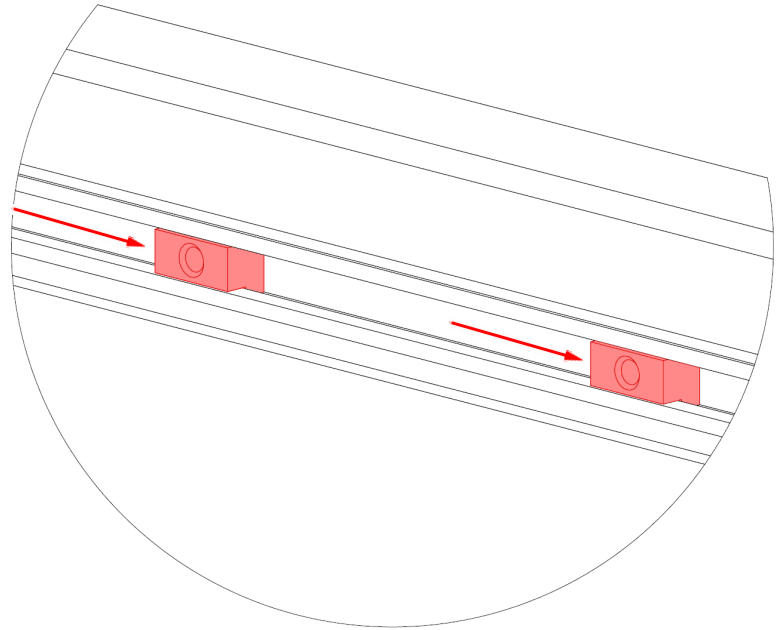

It is recommended that you have an extra pair of hands to hold the brackets while you tighten the bolts.

IMPORTANT: Attach each bracket loosely then use a measuring tape to ensure that they are placed across from each other and move as needed to align the brackets.

Once the brackets are aligned, tighten them down making sure the upright is vertical. Adjust if needed to ensure each bracket is vertical.

Once vertical, you can tighten all 6 nuts on each bar end with a ratchet and socket.

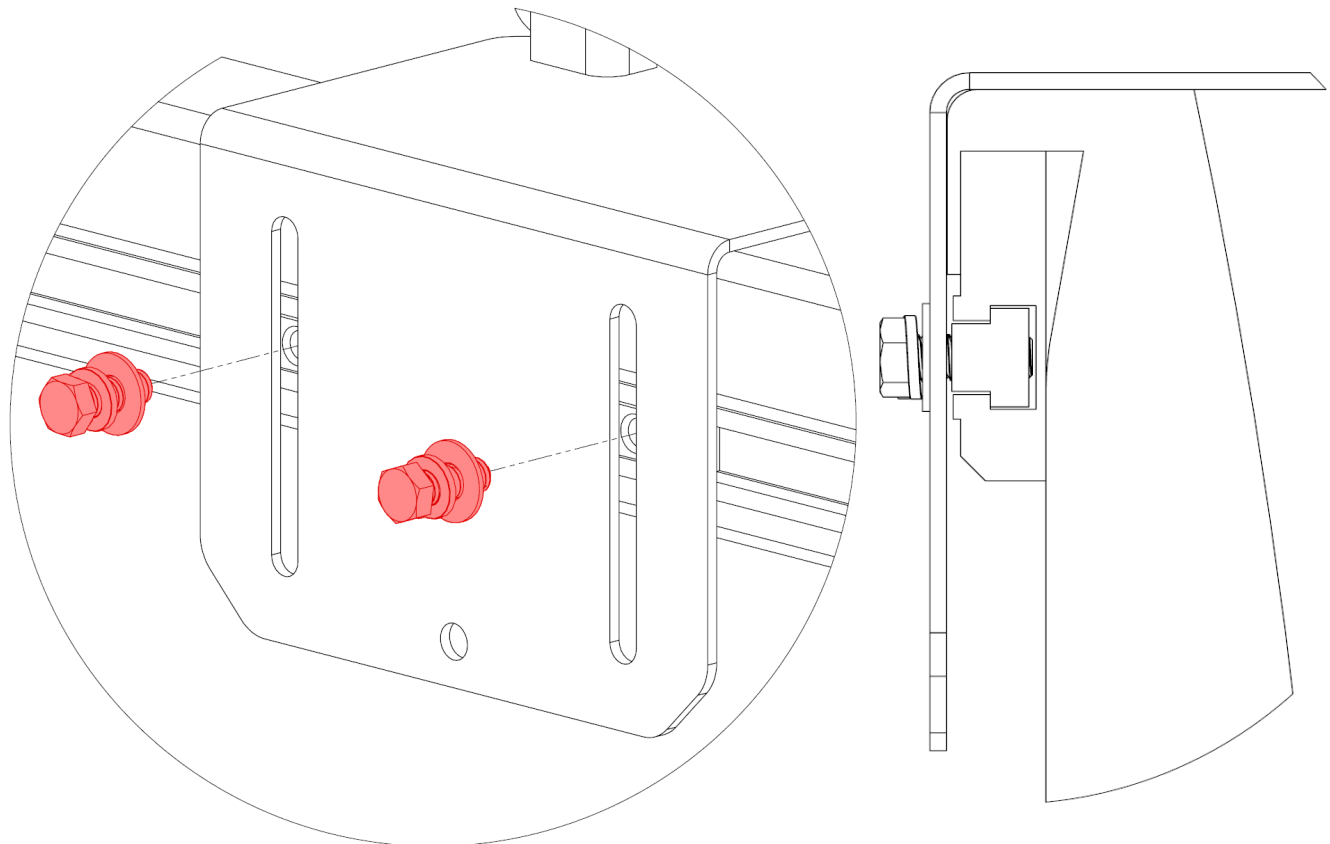

Step 5 (T-Slot Rail Mount)

Attach each bracket to your truck bed.

Using the supplied T-slot plates and nuts, attach the crossbars to your truck bed. First slide the T-slot brackets onto the utility rail.

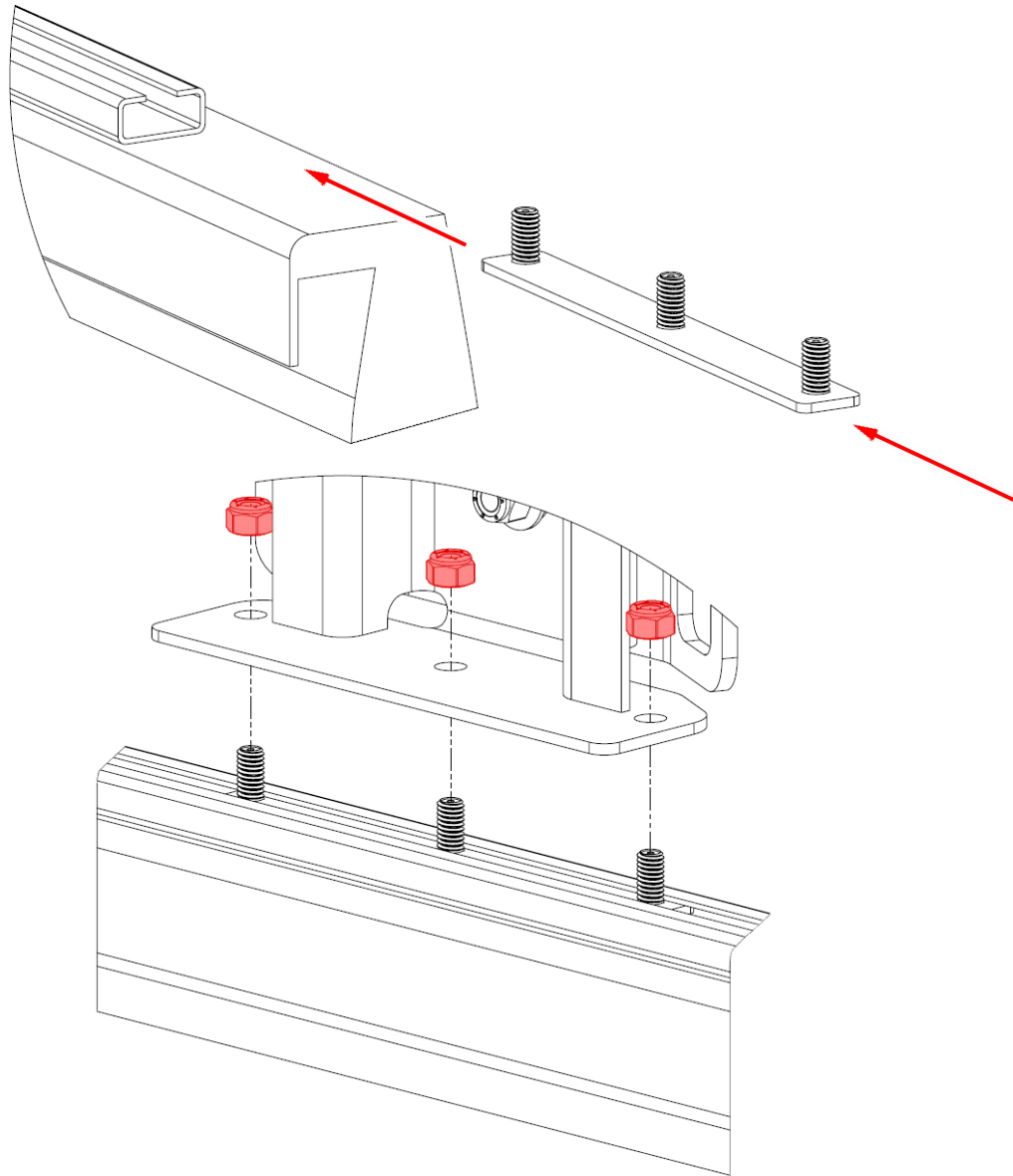

It is recommended that you have an extra pair of hands to hold the brackets while you tighten the bolts.

IMPORTANT: Attach each bracket loosely then use a measuring tape to ensure that they are placed across from each other and move as needed to align the brackets.

Once the brackets are aligned, tighten them down making sure the upright is vertical. Adjust if needed to ensure each bracket is vertical.

Once vertical, you can tighten all 6 nuts on each bar end with a ratchet and socket.

Step 6

Tighten All Screws

Go over every screw in the system and ensure that it is tight. Once everything is tight your rack should feel very solid.

If you push on the side and there is play, something did not go together correctly.

Contact us if you have any issues.

Excessive play will also cause parts to rub on each other wearing through the powder coat and opening up the possibility for rust to occur.

After driving with the rack installed for 25-50 miles on road or 10 miles offroad, check and tighten all bolts.

Bolts may loosen as the rack settles. **Periodically check your bolts to make sure they remain tight.**

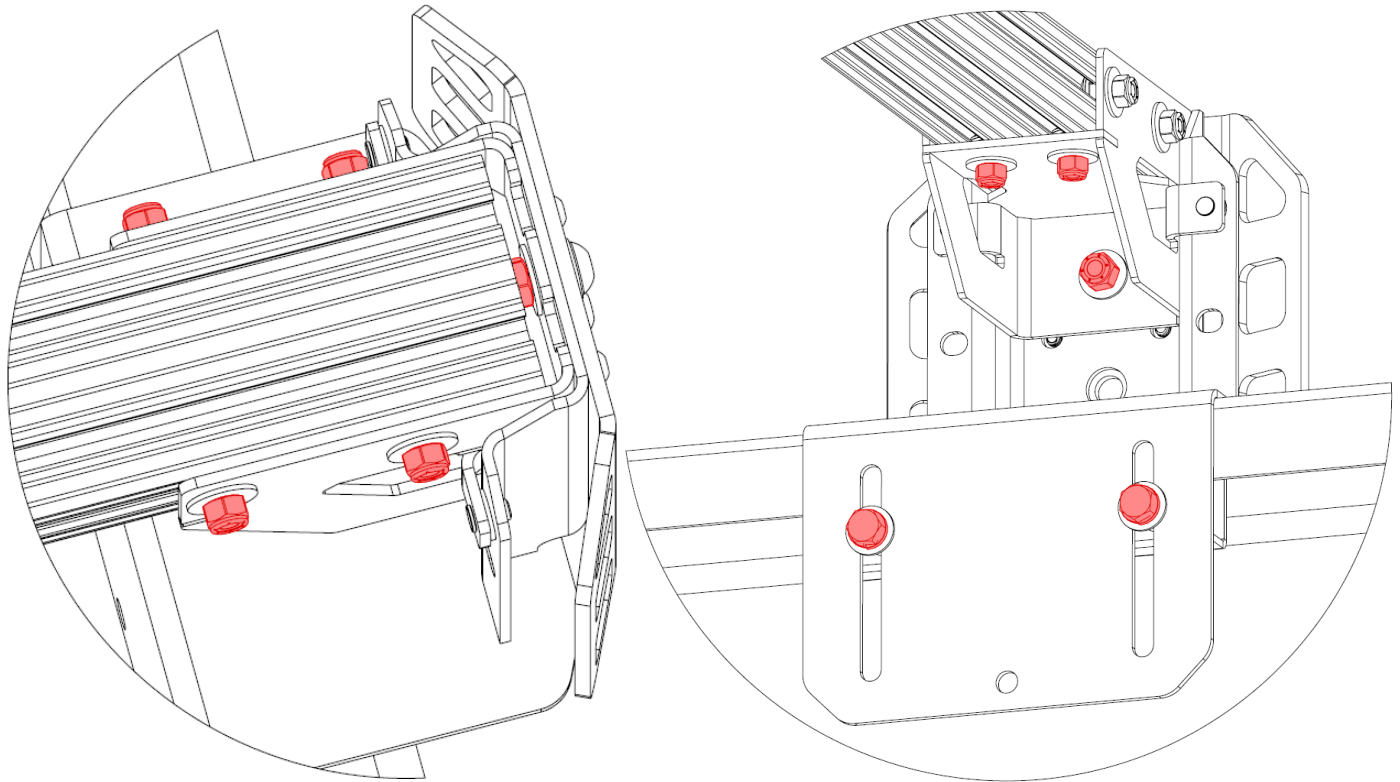

Final Words

Special Notes: This rack is designed for off-road use; however, this is not a jump rated or high speed rated product. Do not overload your rack. This rack is officially rated for 250Lbs of driving load and 1000lbs of parked load or your truck's bedside load rating (driving and parked), whichever is lower. Overweight racks or reckless driving is dangerous to you, your truck, and others around you. Please drive responsibly and tread lightly.

Shipping Damage: If your product arrives damaged, please let us know within 7 days so that we can start a claim with UPS. We will not be able to process a shipping claim without pictures of the original packaging. Small bumps or scratches can happen during shipping, these are not covered and are impossible to completely prevent even though we do our best. We recommend touching these up, contact us for the best match paint recommendation.

Warranty: Typical wear and tear through use is not covered, but any type of manufacturer's defect has a lifetime warranty. Misuse as specified above is not covered under the lifetime warranty. We stand behind this product and expect it to last a very long time, if it doesn't please reach out.

Thank You: Thanks for purchasing from TRUKD. We are a small business based out of Pittsburgh, with every part of our racks made in the USA. We appreciate every one of our customers, we wouldn't be here without you. If you are truly thrilled by our product, please leave us a review, post some pictures and tag us, or buy some accessories! We hope to see you on the trails!