



# Installation Guide

Raptor Style Mesh Grille  
For 2018-2020 Ford F150

SKU # AMFMAA00161

## STEP 1

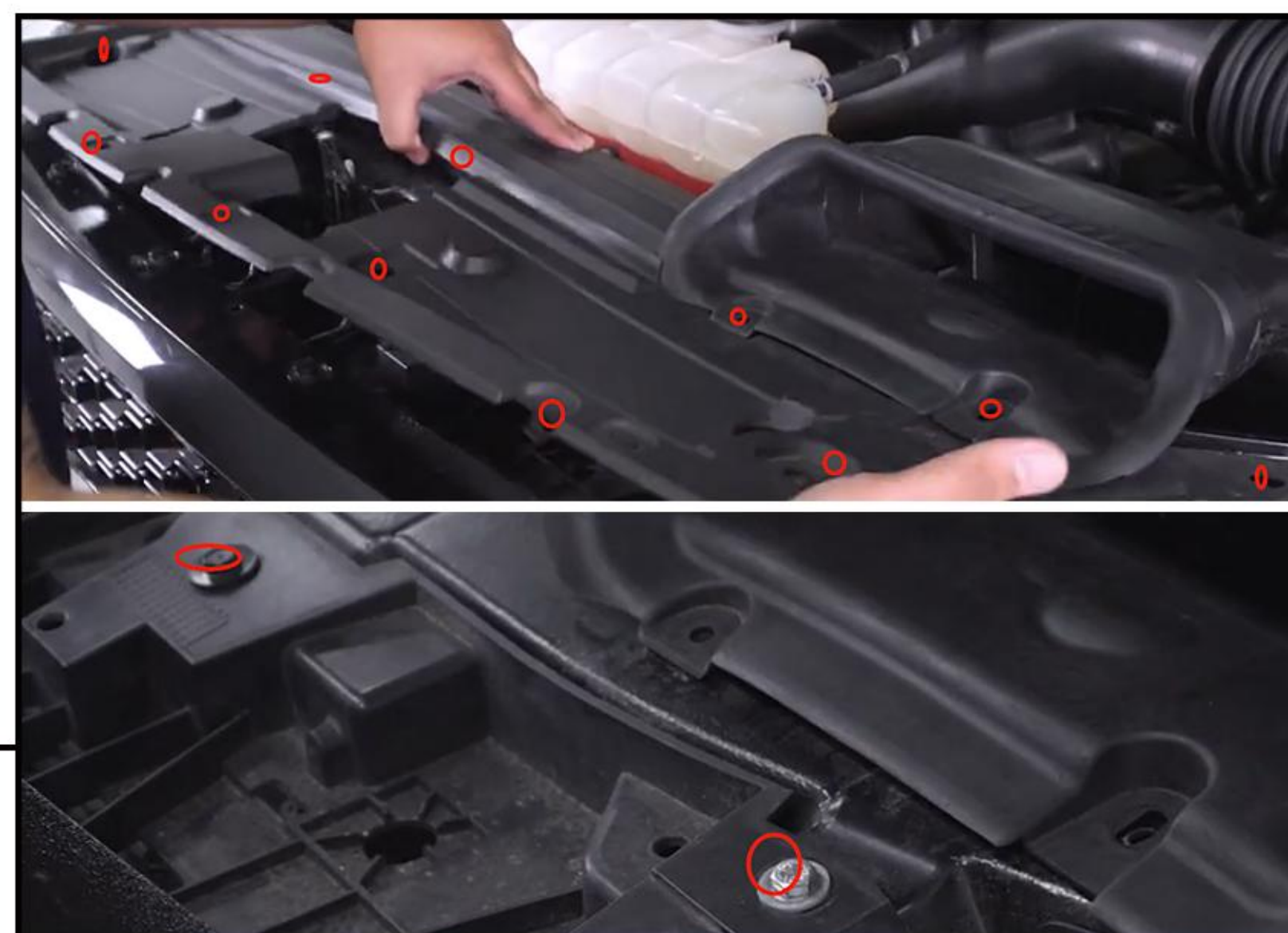

Open the hood, remove all the push pins to remove the radiator cover, then remove the 4 bolts at the top of the grille.

## STEP 2



Remove 2 bolts on both sides to take off the fascia. Then remove the bolt on each side, pull the harnesses out from the back of the grille and the center. Then pull the grille out of the car.

## STEP 3

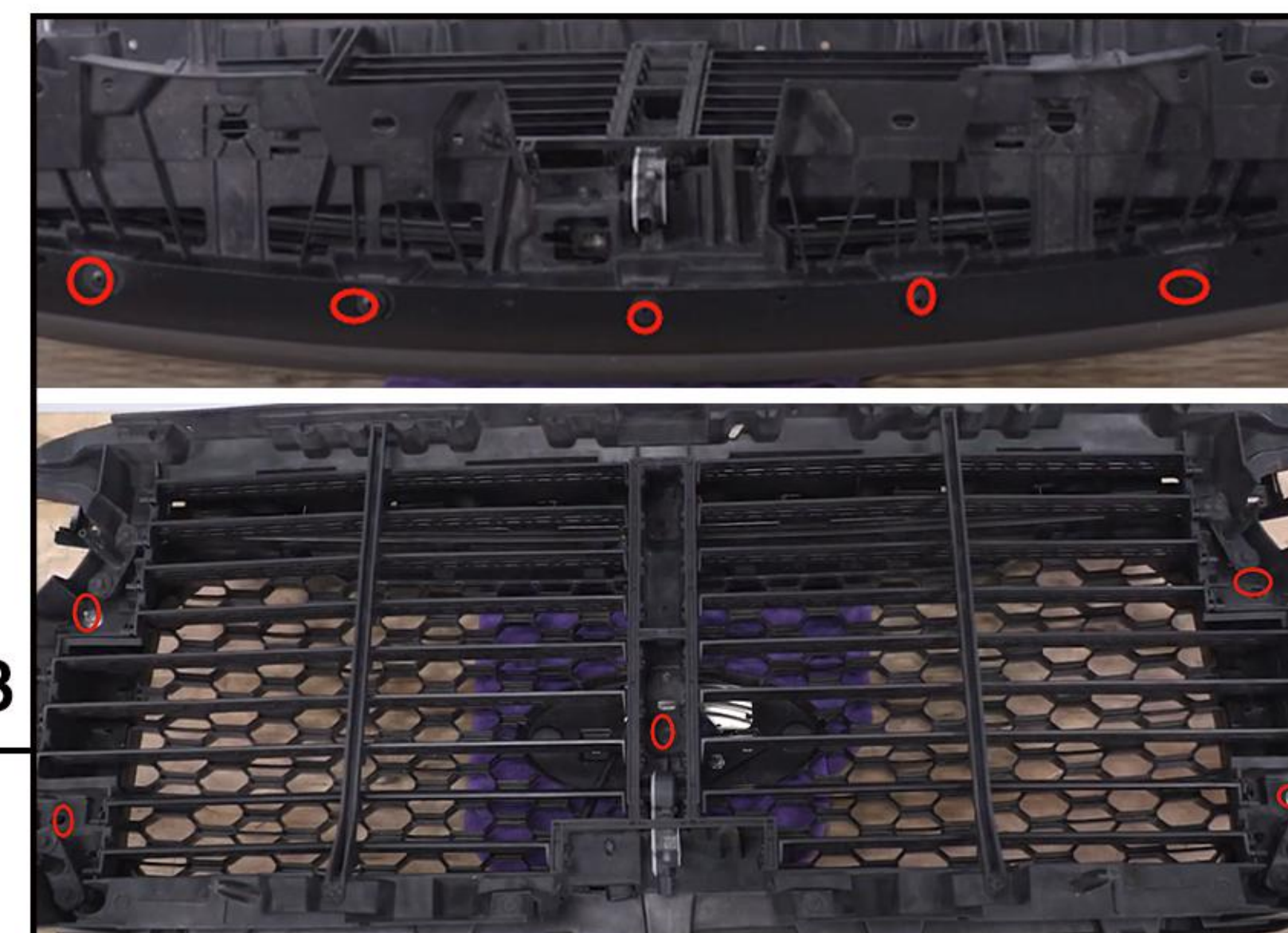

Remove 5 pop clips up at the front, 4 bolts around the side and a Torx bolt in the middle to separate inner grille from outer grille.

## STEP 4

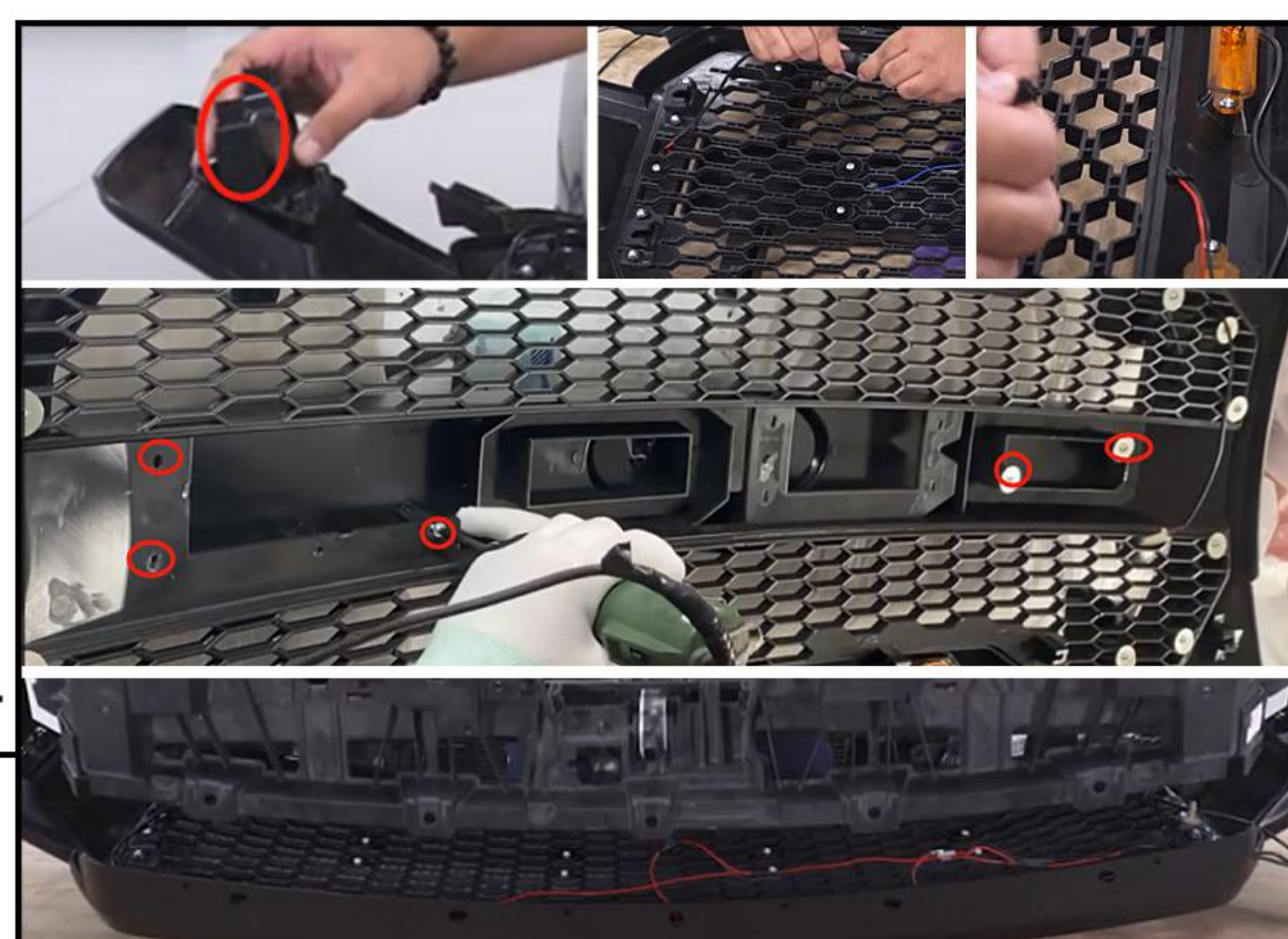

Install the headlight clip post on both side, connect the amber lights with wiring harness. Loosen 5 screws to remove the horizontal bar. Remove the "Ford" emblem from the original grille and install it on the horizontal bar, tighten 5 screws again to install the horizontal bar. After that, follow the step 3 in reverse order to assemble the inner grille with the outer grille.

## STEP 5

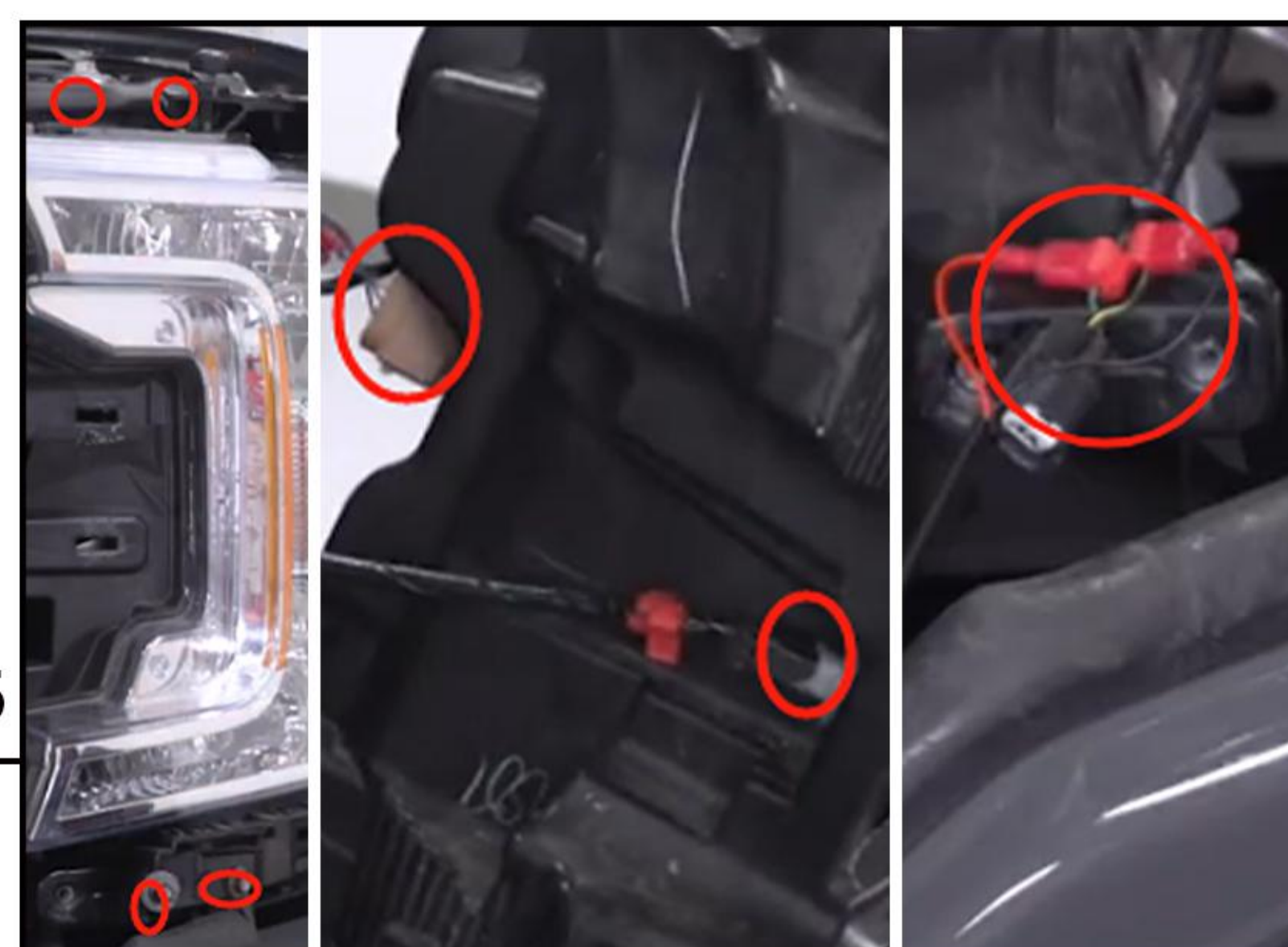

Remove 4 bolts to remove the headlight, then disconnect the harness. Crimp the male spade connectors onto the positive and negative wiring for the 3 amber lights on the grille, place T-taps on the positive and negative wires of the headlights separately, and plug them into the corresponding T-taps.

## STEP 6



After connecting the wires, follow the step 5 in reverse order to reinstall the headlights. Put the new grille back on the car and follow the step 1 & 2 in reverse order to install the new grille.