



CARBON FIBER STEERING WHEEL

(2015-2020 F-150)

INSTALLATION INSTRUCTIONS

CONTENTS

(1) Steering Wheel

TOOLS REQUIRED

10mm, 15/16" Socket
Ratchet
Impact Wrench
Torque Wrench
3mm Allen Key
Small Pry Tool
Masking Tape

SKU # T619838 / T619839 /
T619840



STEP 1

Ensure the vehicle is parked with the front wheels facing straight ahead (steering wheel straight).

Open the vehicle hood. Loosen the negative battery cable terminal and disconnect the negative terminal from the vehicle battery, isolate the terminal from the battery with a shop rag, if necessary. Allow the vehicle to sit for at least 10 minutes to ensure the system is discharged.

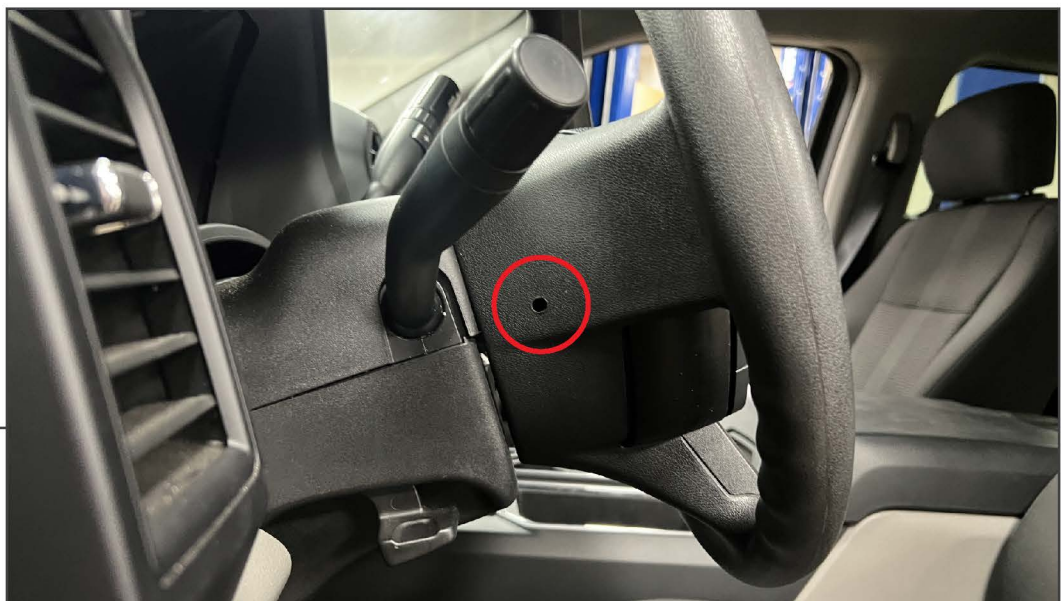

STEP 2

On each side of the steering wheel, locate the small hole in the steering wheel trim. Using a 3mm Allen key, fit the Allen key into the hole to press the air bag retaining spring inwards to disconnect the air bag from the steering wheel. With the spring depressed, gently pull the air bag away from the steering wheel. Only dislodge one side of the air bag at a time.

Note: It is best to aim the inserted end of the Allen key straight inwards, do not pry up or down. The air bag will move slightly when the spring is pressed.



STEP 3

Using a small pry tool, lift the orange connector locks away from each yellow connector. With the orange locks lifted, the connector will lift out of place. Gently use the pry tools to lift the connector upwards if necessary.

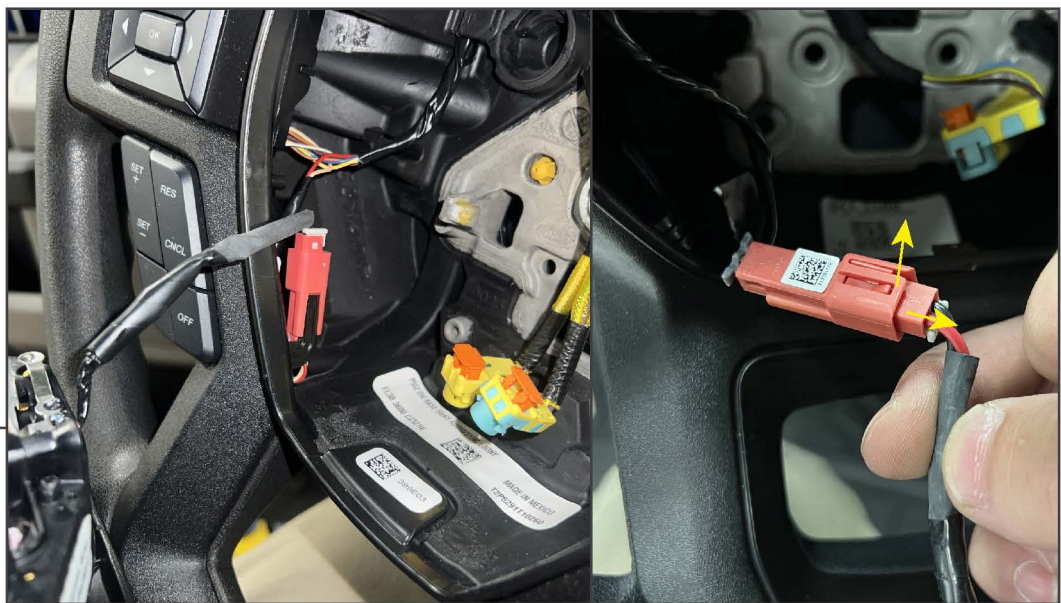

STEP 4

Locate the red connector along the LH bottom edge of the air bag area. Gently lift the connector from the retaining post. Then, using a small flathead screwdriver, lift the steering wheel side red connector tab while pulling the air bag connector away from the steering wheel connector.

STEP 5

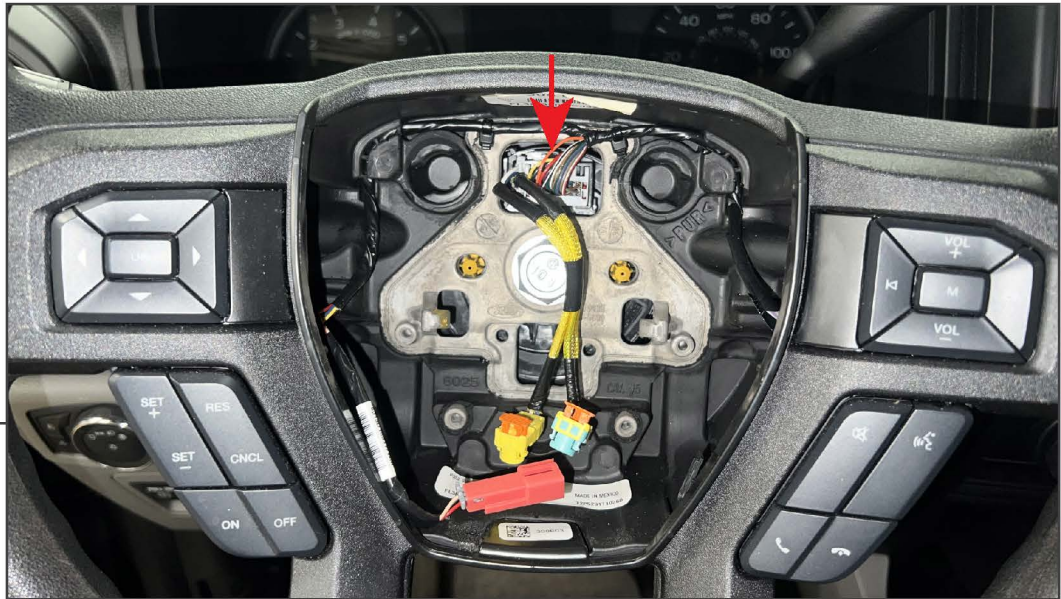

Unplug the steering wheel controls connector by pressing the tab and pulling the connector away.

STEP 6



While holding the steering wheel in place, use a 15/16" socket to loosen and remove the steering wheel retaining bolt.



STEP 7

Lift the steering wheel from the vehicle. While removing the steering wheel, carefully route the clockspring wiring harness out of the steering wheel. Ensure the clockspring remains in the original position. If the clockspring moves slightly during steering wheel removal, gently move back to the original starting position.

Note: It is recommended to tape the clockspring in place with masking tape while the steering wheel is removed to prevent accidental movement.



STEP 8

Place the original steering wheel on a workable surface for disassembly.

Note: Depending on OE vehicle equipment, vehicles with heated steering wheels & paddle shifters may require additional disassembly/hardware removal than portrayed in the following steps.



STEP 9

Using a plastic pry tool, work around the perimeter of the steering wheel controls and lower trim panel. This assembly is secured in some areas using large plastic dowels in the steering wheel foam. These dowels can be difficult to remove and sometimes require additional pressure/force to dislodge.

Note: It is recommended to begin behind the steering wheel control switches and work inwards.



STEP 10

Lift the steering wheel control and lower trim panel assembly away, and dislodge the harness from the steering wheel. Use a small pry tool to dislodge the (2) retaining push clips.

Note: If the vehicle is equipped with OEM Paddle Shifters, remove the hardware and paddles from the steering wheel. At this time, transfer the paddle shifters to the new steering wheel.



STEP 11

Align the steering wheel control assembly to the new steering wheel, and route the harness into place. Once the harness is properly routed, press the steering wheel control assembly fully into place. Work around the perimeter to ensure an even fit.

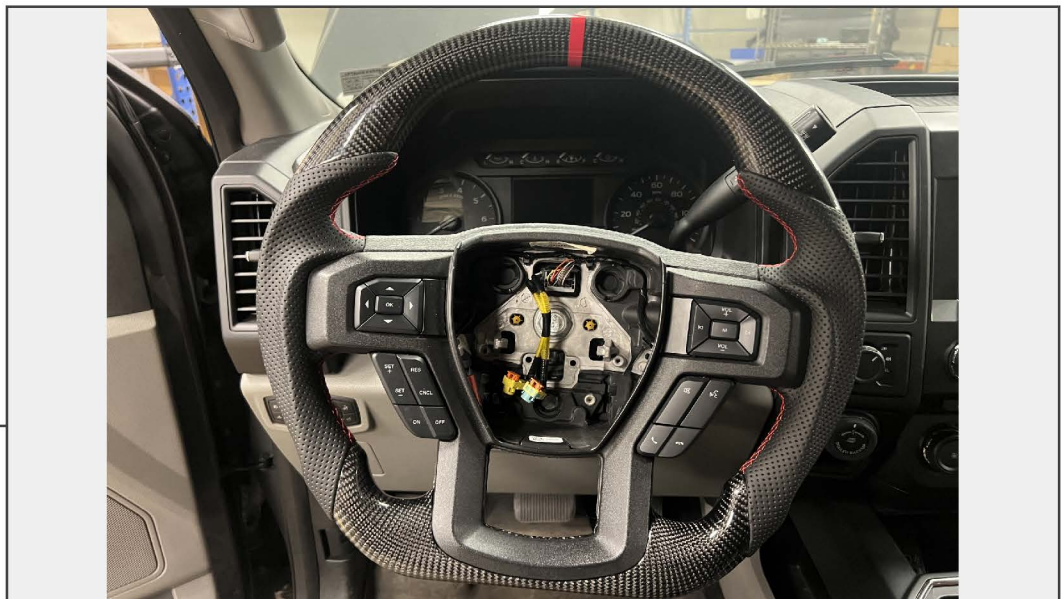

STEP 12

Align the steering wheel to the vehicle, and route the clockspring harness through the steering wheel. Fit the steering wheel to the steering column and secure into place using the original 15/16" bolt.

Torque the steering wheel retaining bolt to 40 ft. lbs.

Note: OEM recommends replacing the steering wheel bolt, OEM Part # W705985-S437



STEP 13

Plug in the the three air bag connectors, and firmly press the air bag into the steering wheel until fully seated, the air bag will audibly click into place.

Installation is now complete.